

CenterPoint Energy
 MINNESOTA REGION
 PROPRIETARY AND CONFIDENTIAL
 PROJECT # 88320253
 M18000 LITTLE FALLS
 M18400 PIKE CREEK TOWNSHIP

ONE CALL:
 Morrison
 *SW13T129R30
 *NE7T40R32
 *NE19T129R29
 *SE13T129R30
 *SE18T129R29
 *SE7T40R32
 *SW8T40R32
 *NE8T40R32
 *SW18T129R29
 *NW24T129R30
 *NE24T129R30
 *NW19T129R29
 *SE8T40R32
 *SE8T40R32
 *SE8T40R32

LEGEND:
 ACTIVE MAIN
 DESIGNED MAIN
 PROPOSED/ABANDONED/
 OUT OF SERVICE MAIN
 ABANDONED/
 OUT OF SERVICE MAIN

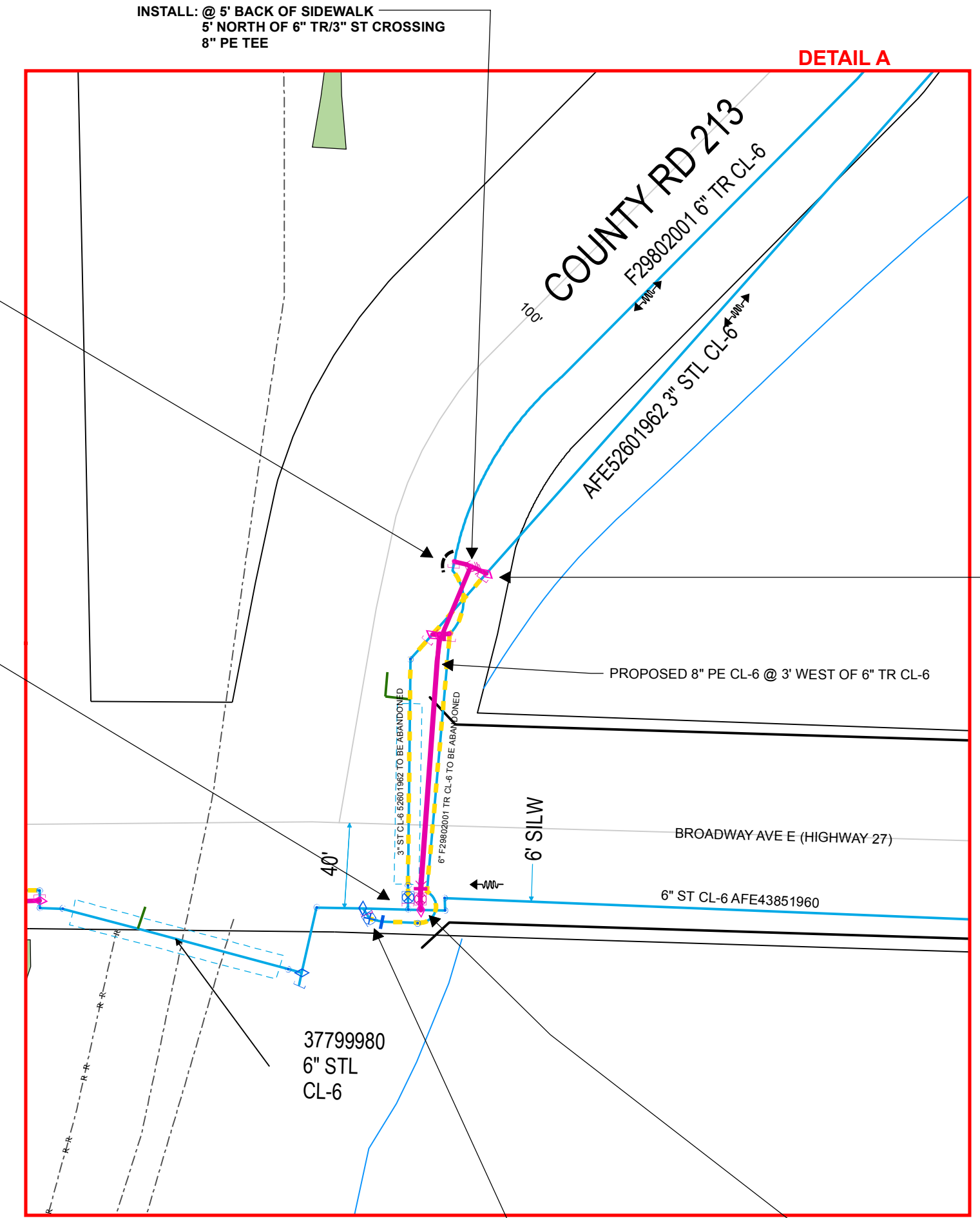

CONSTRUCTION PROCEDURES
 Install, Clean and Test, and Put in Service; Proposed new main per CenterPoint Energy Construction and Services Manual.

Purge new main until essentially 100% reading is obtained on Combustible Gas Indicator. See CenterPoint Energy Construction and Services Manual Section CS-B-1.230 for purging mains into service.

Complete all Service / Meter Work as directed. (See Service Survey)

See Abandonment Procedures for abandonment and purging procedures.

Install a marker ball at a new end of main, at a valve, at each end of a horizontal offset, at road crossings and at any fitting or pressure control identified as needing to be located in the future. Refer to CenterPoint Energy Construction and Services Manual section CS-B-1.310 for installation procedures.

CONSTRUCTION NOTES
 Obtain Construction Plans from Designer prior to starting job.
 Coordinate with Contractor / Engineering Firm for exact locations of proposed structures and facilities prior to installation of gas facilities.
 Install new main as shown or as directed in field at time of installation.
 Long side mains and services to be installed below proposed sub-outs (See Construction Plans).
 All test points should be installed in the boulevard or other acceptable locations and avoid placement in driving lanes.
 Verify Coating test results if required prior to abandoning main.

NOTE: BYPASS SIZING WAS DESIGNED FOR 40 DEG TEMPERATURE OR ABOVE. IF COLDER, THEN CONTACT ENGINEERING.

INSTALL 2" PE TEMPORARY BYPASS USE:
 (2) 3"X2" OR 6"X2" HVPTS AS NEEDED
 (2) 2" PE 90 DEG ELLS
 20' 2" PE PIPE

INSTALL GAUGES AND MONITOR PRESSURE FOR 1/4 HOUR PRIOR TO SEPARATION. IF PRESSURE FALLS BELOW 7 PSI (FOR CL-2) OR 40 PSI (FOR CL-6), CONTACT ENGINEERING.

MONITOR GAUGES DURING THE JOB.
 INSTALL ELLS PER DESIGN

CUT AND ABANDON BYPASS
 USE (2) 2" PE CAPS

ABANDONMENT PROCEDURES
 See Construction Procedures for installation of mains and services prior to abandonments.

NOTE: THERE ARE ONE-WAY FEEDS IN THIS PROJECT:
 THE 2" PLASTIC @ 5 ST SE & BROADWAY
 THE CL-6 IN ALLEY BETWEEN 3 ST SE AND 4 ST SE
 THE CL-6 WEST & SOUTH OF 1 ST NW
 THE CL-2 IN ALLEY BETWEEN BROADWAY AND 1 AVE SW, RUNNING FROM 7 ST SW & 6 ST SW
 ALL TIE-INS WEST OF 13 ST SW
 THE TIE-IN @ 13 ST SW & BROADWAY
 THE TIE-IN @ 13 ST SW & 1 AVE SW
 VERIFY THAT ALL TIE-INS ARE GASED UP FOR THESE AREAS AND THAT SERVICES ARE TRANSFERRED BEFORE DOING ANY KILLS.

Cut and Abandon existing main as shown. Purge abandoned mains until essentially 0% gas reading is obtained on Combustible Gas Indicator. See CenterPoint Energy Construction and Services Manual Section CS-B-1.110 and Section CS-B-1.230 for purging mains out of service using air movers.
 Contact Engineering with questions.

FOR ABANDONED PIPE <= 4" IN DIAMETER:
 Project area cleared for internal impacts. Pipe being removed is unregulated for disposal if coating does not exist or is non-asbestos. Refer to CNP Construction and Service Manual CS-B-1.110, CS-B-1.330, and CS-B-1.100, for pipe to be abandoned.

FOR ABANDONED PIPE > 4" IN DIAMETER:
 Pipe being removed must be tested for PCBs and asbestos to confirm disposal requirements - contact Environmental, 612-861-8471. For pipe to be abandoned, refer to CNP Construction and Service Manual CS-B-1.110, CS-B-1.330, and CS-B-1.100.

NOTE: BORE ALL PAVED STREETS AND DRIVEWAYS
 Minimum depth requirements for crossings of state highways and county roads is 60". Minimum depth requirements for crossings of city streets and township roads is 48".
 Minimum depth for parallel installations on state highways and county roads is 36". Minimum depth for parallel installations on city streets and township roads is 30". All steel pipe welds to be coated with 2 part epoxy.

DNOTES COATING SAMPLE LOCATION. CONTACT CHRISTOPHER LANASA (612-321-5448) IN ENVIRONMENTAL PROGRAMS TO SCHEDULE SAMPLING OF PIPE COATING. GIVE 48 HOURS NOTICE WHEN POSSIBLE TO ARRANGE FOR A LICENSED INSPECTOR.
NOTE: ALL EXISTING STEEL PIPE (EXCEPT FOR 6" AFE43761960) HAS TESTED POSITIVE FOR ASBESTOS COATING

I hereby certify that this plan, specification, or report was prepared by me or under my direct supervision and that I am a duly Licensed Professional Engineer under the laws of the state of Minnesota.
 Signature: *Jerome Kallstrom*
 Typed or Printed Name: Jerome K. Kallstrom
 Date: 3/4/2019 License Number: 13149

PROJECT DESCRIPTION: SREL HIGHWAY 27
 DESIGNER: Travis Denzel
 PHONE #: 612-321-5207
 DRAWN BY: Travis Denzel
 DESIGN DATE: 11/29/2018

REVISION INFO:

Main
 SSS

SCALE 1" = 150'
 SHEET 2 OF 2

3/4/2019 7:41:16 AM