



Overview



Legend

- Road Centerlines
- Streams**
- <all other values>
- Protected Stream
- Protected Stream/County Ditch
- Original Path
- County Ditch

This imagery is displayed at a scale of 1 inch=9 inch pixel resolution, (9 inches on the ground is 1 pixel on your screen). In the areas of Pierz and the NW/NE lakes, the image is 1 inch=3 inch pixel resolution and is the highest quality imagery on this site. These images were flown by Pictometry in the spring of 2017 for the 9", and fall of 2017 for the 3".

Date created: 5/16/2019
 Last Data Uploaded: 5/16/2019 2:56:38 AM

Developed by  **Schneider**
 GEOSPATIAL

PI 0+00

POT 4+64.2

PI 16+64.8
Δ = 0°26'LT

0+44 CL
INP 15" X 38' CMC @ 2 APRONS REMOVE
FB 1 15" X 46' CMC
FB 1 2 APRONS

8+95 FE ENT
NO CULV INP
FB 1 15" X 22' SCP CLASS IV
FB 1 2 APRONS

12+66 CL
INP 12" X 14' CMC REMOVE
FB 1 18" X 40' SCP CLASS III
FB 1 2 APRONS

16+65 FM ENT
INP 12" X 18' CMC REMOVE
FB 1 15" X 22' SCP CLASS III
FB 1 2 APRONS

16+31 FE ENT
NO CULV INP
FB 1 15" X 22' SCP CLASS III
FB 1 2 APRONS

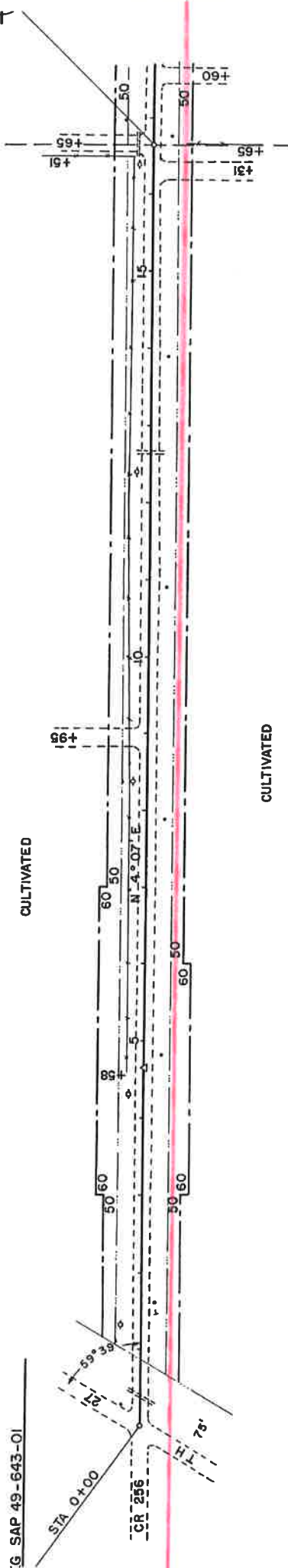

Proposed Route

POT 46 + 73.5



PI 64+44.8
Δ = 0° 01' RT

STA 49+00.0
IMP 15' X 36' SCP REMOVE
E.B. 1 24' X 56' SCP CLASS III
F B 1 2 APRONS

53+38 FE ENT
NO CULV IMP
F B 1 18' X 22' SCP CLASS III
F B 1 2 APRONS

54+80 E
IMP 15' X 28' SCP REMOVE
F B 1 16' X 48' SCP CLASS III
F B 1 2 APRONS

64+45 TWP RD
IMP 15' X 44' SCP REMOVE
F B 1 15' X 80' SCP CLASS III
F B 1 2 APRONS

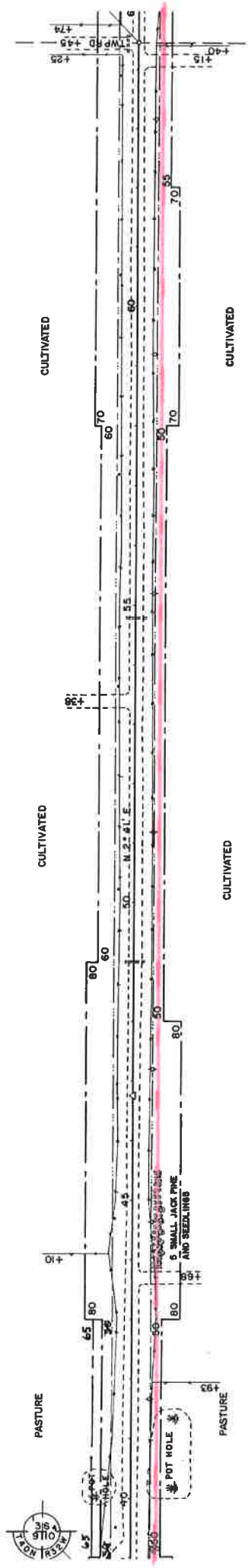

43+68 FE ENT
NO CULV IMP
F B 1 15' X 22' SCP CLASS III
F B 1 2 APRONS

64+45 FE ENT
NO CULV IMP
F B 1 15' X 22' SCP CLASS III
F B 1 2 APRONS

CLB GR 5T

BM EL 1153.76
SPIKE IN 18" TWIN RED OAK
RT 150' STA 42+99

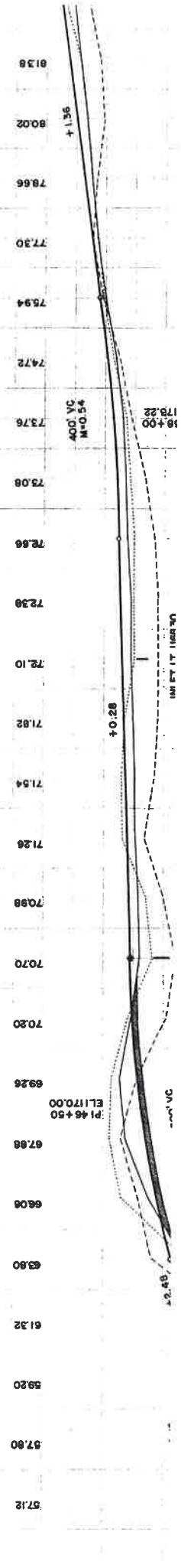

Proposed Route

POT 28+87.1

PI 38+00
A = 1° 00' LT



36+56 FE ENT
NO CULV INP
F & I 15" X 22' SCP CLASS III
F & I 2 APRONS

38+00 CR 259
NO CULV INP
F & I 15" X 30' S
F & I 2 APRONS

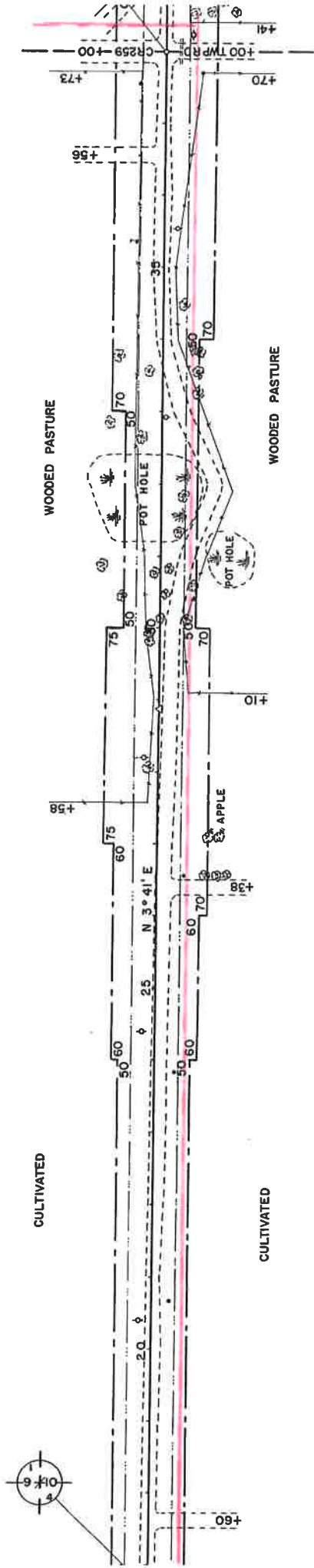

60 FE ENT
CULV INP
1 15" X 22' SCP CLASS III
1 2 APRONS

26+38 FM ENT
NO CULV INP
F & I 15" X 22' SCP CLASS III
F & I 2 APRONS

38+00 TWP RD
INP 15" X 30' CMC REMOVE
F & I 15" X 28' SCP CL
F & I 2 APRONS

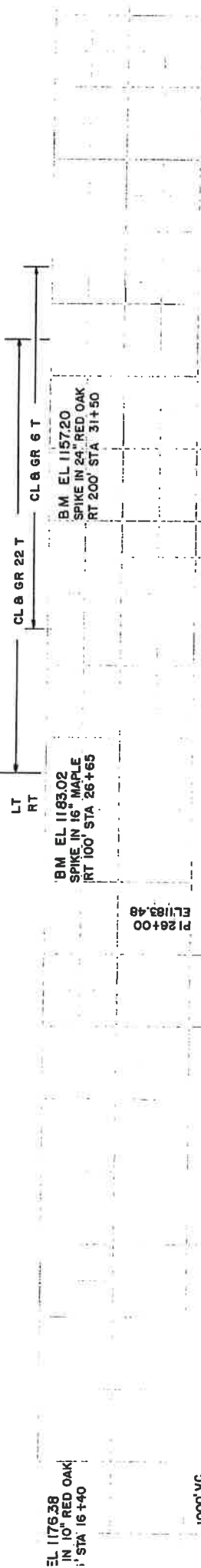

EL 1176.38
IN 10" RED OAK
1 STA 16+40

BM EL 1193.02
SPIKE IN 16" MAPLE
RT 100' STA 26+65

BM EL 1157.20
SPIKE IN 24" RED OAK
RT 200' STA 31+50

LT RT
CL & GR 22 T
CL & GR 6 T

EL 1183.48
PI 29+00

Proposed Route