





PROPRIETARY AND CONFIDENTIAL

PROJECT #: **97846185**

M16200 PIERZ

ONE CALL:
Morrison
*NE 17 T40/R30
*SE 8 T40/R30
* = this Page

LEGEND:
 ACTIVE MAIN
 DESIGNED MAIN
 PROPOSED ABANDONED/
OUT OF SERVICE MAIN
 ABANDONED/
OUT OF SERVICE MAIN

PIPE REQUIRED:
832' 2" PE CL-5

832' PIPE

PROPOSED ABANDONED PIPE:

COPIES:
PIPELINE INTEGRITY PACKET: N
STATION MANAGER: N
DD NUMBER: NA
CORROSION: N
EMP: N

SITE CONTACT: DALE KLOSS
320-290-7874

FOLLOW INTERNAL PIPE
SAMPLING REQUIREMENTS? N
SURVEYOR REQUIRED? N
RETURN PACKET TO ENG? N
GFIP#: NA
PERMITS: CITY OF PIERZ
MORRISON COUNTY
SALES REP: RYAN GOETZ

PROJECT DESCRIPTION: NBRE
RIVER VALLEY TOWNHOMES

DESIGNER: Cameron Victor
PHONE #: 612-321-5347
DRAWN BY: Cameron Victor
DESIGN DATE: 5/7/2021

REVISION INFO:

Main SS# SCALE 1" = 100'
SHEET 1 OF 1

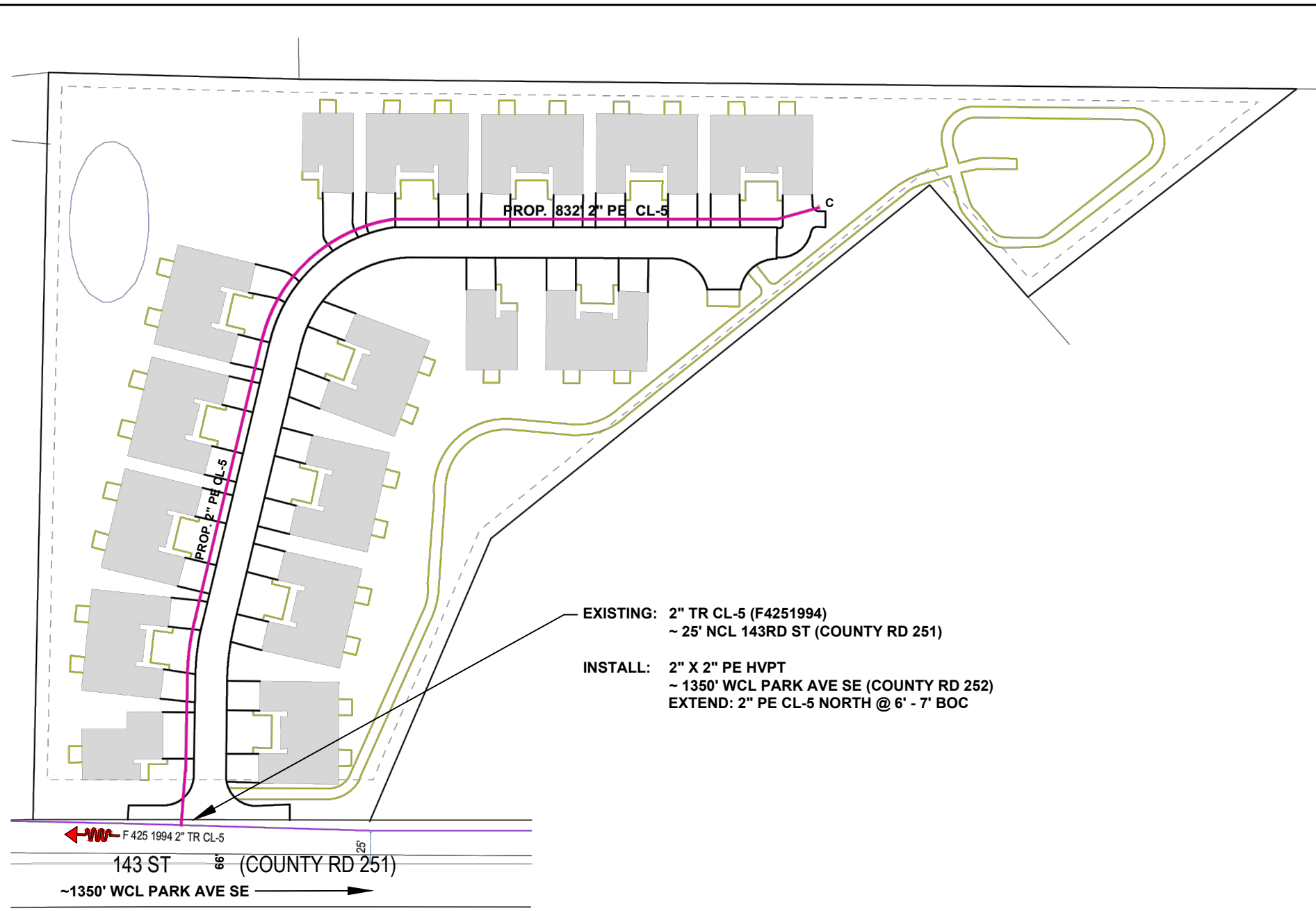

EXISTING: 2" TR CL-5 (F4251994)
~ 25' NCL 143RD ST (COUNTY RD 251)

INSTALL: 2" X 2" PE HVPT
~ 1350' WCL PARK AVE SE (COUNTY RD 252)
EXTEND: 2" PE CL-5 NORTH @ 6' - 7' BOC

NOTE: BORE ALL PAVED STREETS AND DRIVEWAYS
Minimum depth requirements for crossings of state highways
and county roads is 60". Minimum depth requirements for
crossings of city streets and township roads is 48".
Minimum depth for parallel installations on state highways and
county roads is 36". Minimum depth for parallel installations
on city streets and township roads is 30". All steel pipe welds
to be coated with 2 part epoxy.

INSTALL LOCATING POINTS AT A MAXIMUM SPACING OF 1,000 FT.

INSTALL 2" PE CL-5 ~ 6' - 7' BOC ~ IN PRIVATE PROPERTY - MAINTAIN
MINIMUM OF 10' FROM BUILDINGS

C = INSTALL 2" PE CAP TO COVER SERVICE

Install; Clean and Test; and Put in Service; Proposed new main per
CenterPoint Energy Construction and Service Manual.

Purge new main until essentially 100% gas reading is obtained on
Combustible Gas Indicator. See CenterPoint Energy Construction
and Service Manual Section CS-B-1.230 for purging mains into service.

Install a marker ball at a new end of main, at a valve, at each ell of a
horizontal offset, at road crossings and at any fitting or pressure
control identified as needing to be located in the future. Refer to
CenterPoint Energy Construction and Service Manual section
CS-B-1.310 for installation procedures.

Procedure for tapping or making tie-ins to existing gas mains: Verify existing
gas main size, type, and location prior to tapping or making tie-in. Monitor and
verify, using a pressure gauge, existing gas main Pressure Class within the bell
hole of tap location or tie-in location prior to tapping or making tie-in.

I hereby certify that this plan, specification, or report was prepared
by me or under my direct supervision and that I am a duly Licensed
Professional Engineer under the laws of the state of Minnesota.

Signature: 

Typed or Printed Name: **Eric Yang**

Date: **5/11/2021** License Number: **56613**