

ArcGIS Web Map

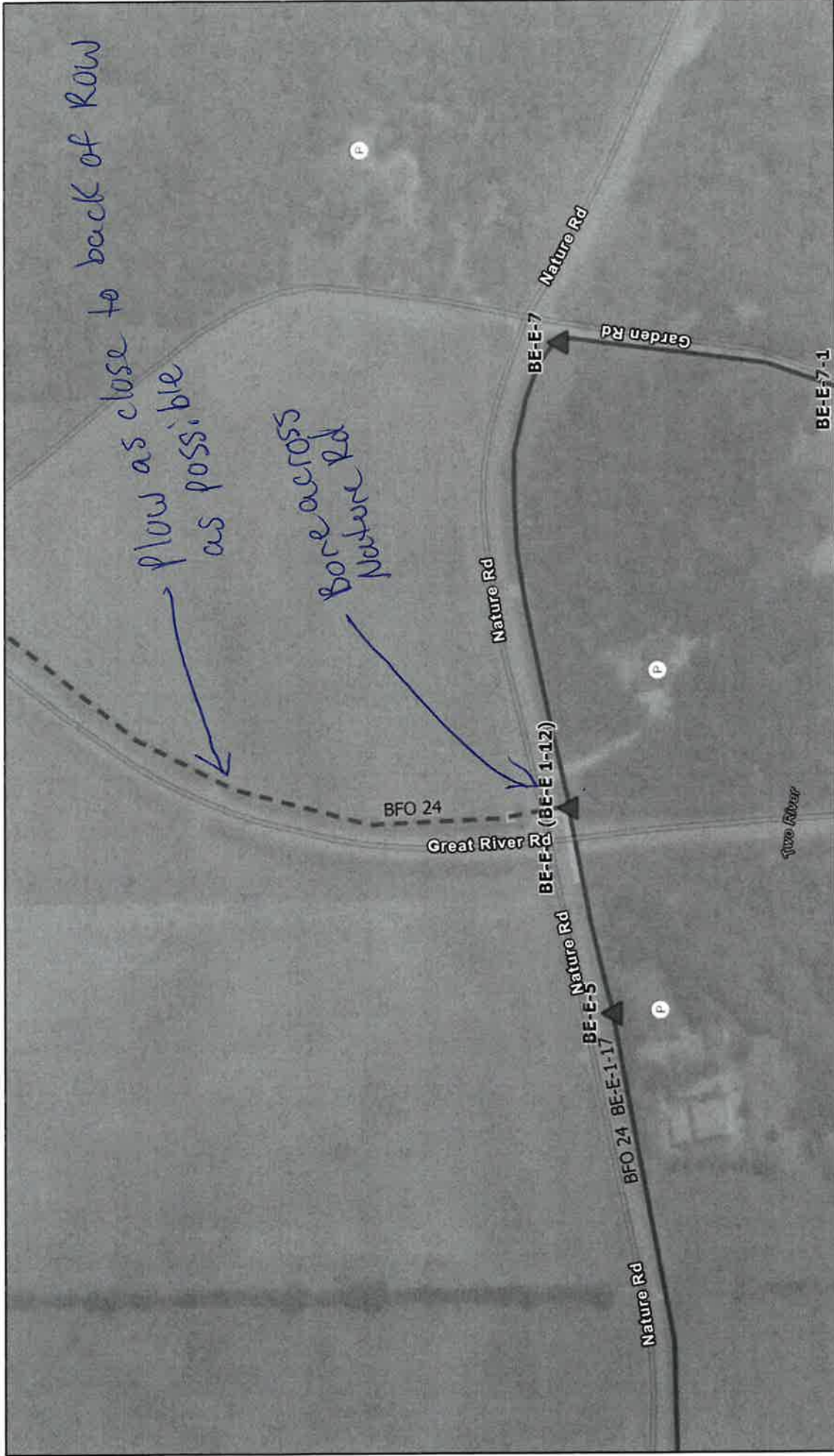

plow as close to back of ROW as possible

Bore across Nature Rd

5/21/2024, 9:55:04 AM

SytekEditingServiceFromPro_8740 SytekEditingServiceFromPro_9015

- Potential
- UG Distribution - Existing
- UG Distribution - Proposed
- Existing
- SytekEditingServiceFromPro_7188
- SytekEditingServiceFromPro_4764
- Existing
- Proposed
- Reconnect 3 - Holdingford Bowlus
- Active

1:4,514

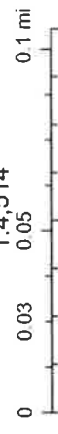

Esri Community Maps Contributors, © OpenStreetMap, Microsoft, Esri, TomTom, Garmin, SafeGraph, GeoTechnologies, Inc, METI/NASA, USGS, EPA, NPS, US Census Bureau, USDA, USFWS, Maxar

Maxar | Esri Community Maps Contributors, © OpenStreetMap, Microsoft, Esri, TomTom, Garmin, SafeGraph, GeoTechnologies, Inc, METI/NASA, USGS, EPA, NPS, US Census Bureau, USDA, USFWS | ArcGIS Web AppBuilder

ArcGIS Web Map



5/21/2024, 9:53:26 AM

SylekEditingServiceFromPro_8740 SylekEditingServiceFromPro_1552 UG Distribution - Proposed Proposed
 SylekEditingServiceFromPro_7290
 SylekEditingServiceFromPro_6317 SylekEditingServiceFromPro_732 Others
 SylekEditingServiceFromPro_732 SylekEditingServiceFromPro_732 SylekEditingServiceFromPro_4764
 Reconnect 3 - Holdingford Bowlus
 Active
 UG Distribution - Existing Active
 UG Distribution - Existing

Esri Community Maps Contributors, © OpenStreetMap, Microsoft, Esri, TomTom, Garmin, SafeGraph, GeoTechnologies, Inc, METI/NASA, USGS, EPA, NPS, US Census Bureau, USDA, USFWS, Maxar
 ArcGIS Web AppBuilder

ArcGIS Web Map

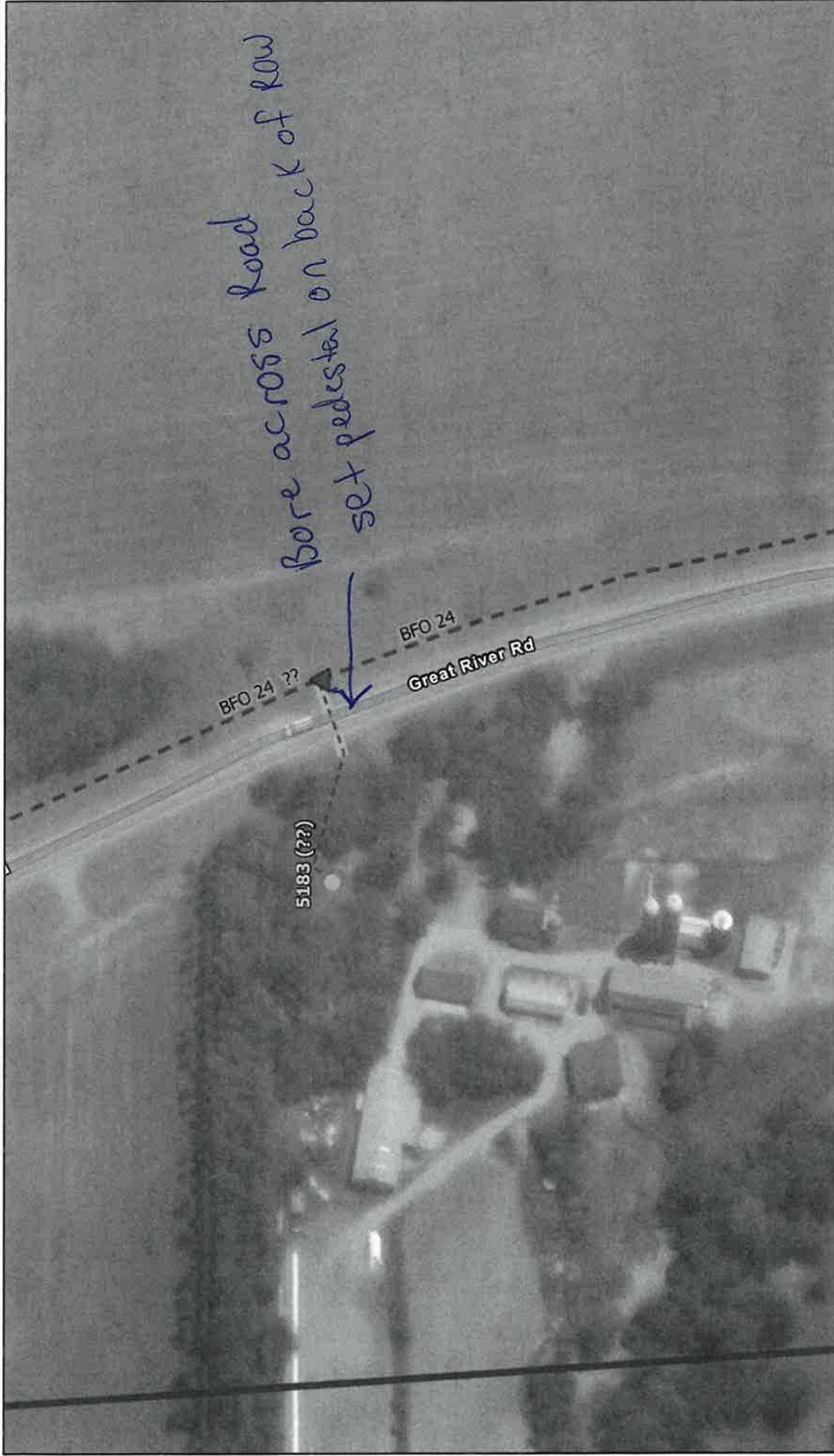

5/21/2024, 10:00:20 AM

SytekEditingServiceFromPro_8740 SytekEditingServiceFromPro_5068 SytekEditingServiceFromPro_7188

- Requested
- Buried Service Drop - Proposed
- SytekEditingServiceFromPro_9015
- SytekEditingServiceFromPro_6317
- UG Distribution - Proposed
- SytekEditingServiceFromPro_4764

Maxar, Microsoft | Esri Community Maps Contributors, © OpenStreetMap, Microsoft, Esri, TomTom, Garmin, SafeGraph, GeoTechnologies, Inc, MET/NASA, USGS, EPA, NPS, US Census Bureau, USDA, USFWS |



Maxar, Microsoft, Esri Community Maps Contributors, © OpenStreetMap, Microsoft, Esri, TomTom, Garmin, SafeGraph, GeoTechnologies, Inc, MET/NASA, USGS, EPA, NPS, US Census Bureau, USDA, USFWS

ArcGIS Web AppBuilder