

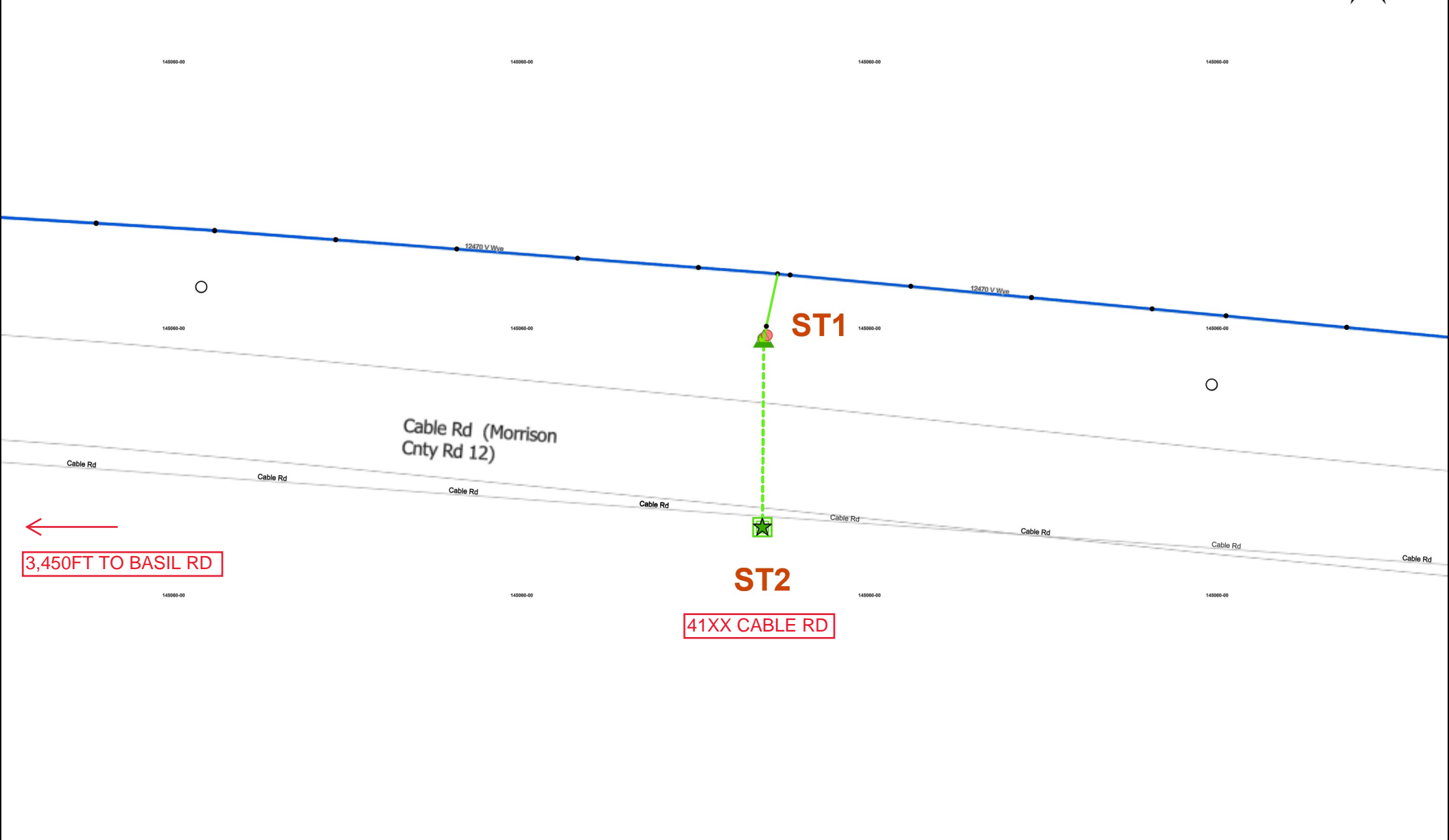

- ST1) REPLACE 35/5 POLE M5488260 WITH A 40/3 TANGENT POLE (DCS-7100)
- INSTALL 25KVA OHTX, 7.2KV-120/240V
 - BUILD SECONDARY RISER ON NEW POLE
- ST2) INSTALL METER PED
- BORE 120FT OF 4/0 TRIPLEX, BACK TO ST1



Work Order Number: #5081132		 AN ALLETE COMPANY	This map may not be prepared to scale. Under no circumstances should this map ever be used to determine the location of the facilities depicted. Minnesota Power/Allete disclaims all responsibility for any such use and shall not be liable for any indirect, consequential or other damages, however caused.
Name: Dan Messner 952-529-1596	Date: 10/21/2024		