

GENERAL LOCATION ONLY.  
DO NOT USE TO LOCATE FOR EXCAVATION.  
CALL 1-800-252-1166 FOR ONSITE LOCATIONS AND STAKING.

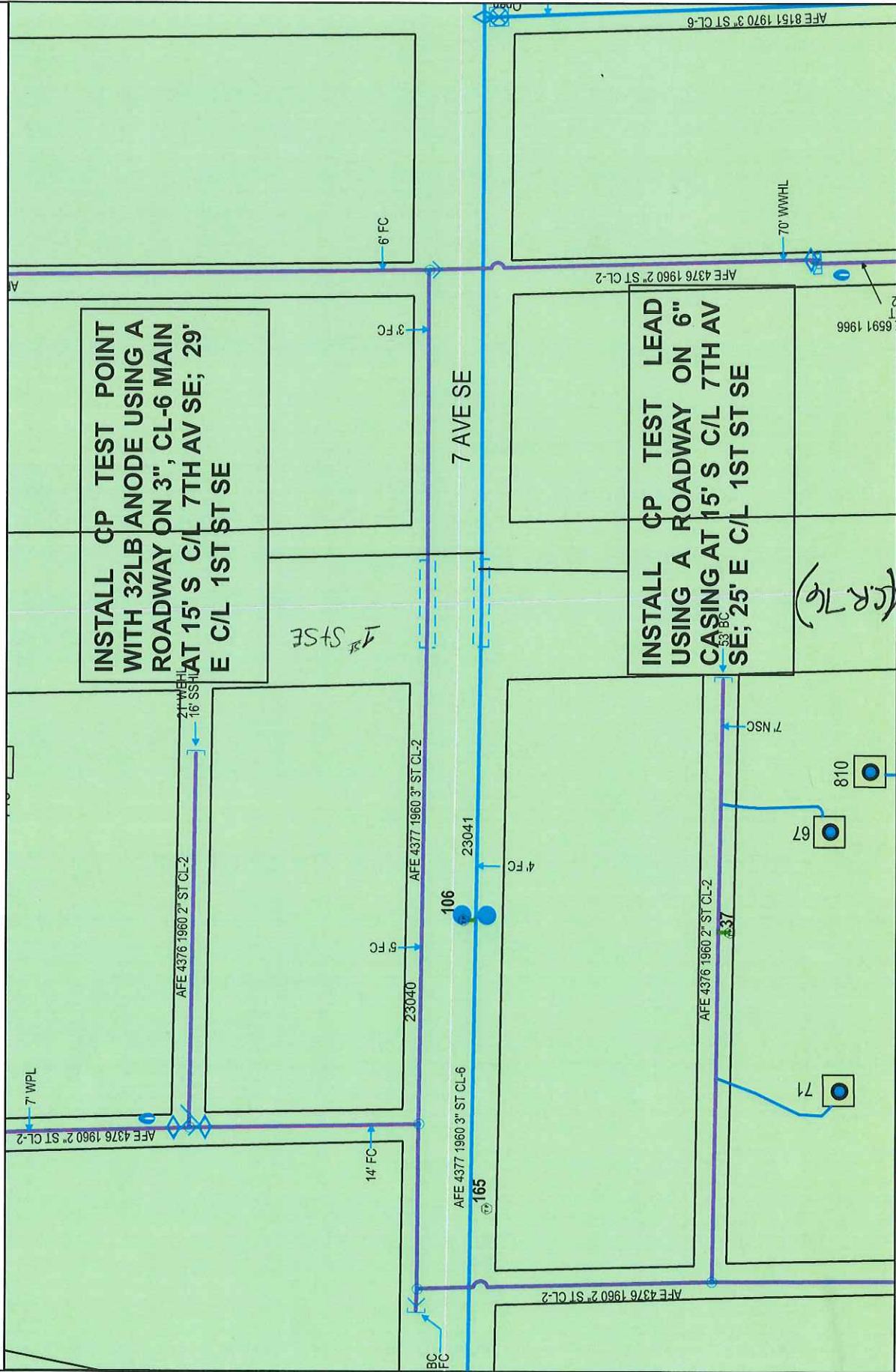

Scale: 1" = 83'



INSTALL CP TEST POINT WITH 32LB ANODE USING A ROADWAY ON 3", CL-6 MAIN AT 15' S C/L 7TH AV SE; 29' E C/L 1ST ST SE

INSTALL CP TEST LEAD USING A ROADWAY ON 6" CASING AT 15' S C/L 7TH AV SE; 25' E C/L 1ST ST SE

ST SE

(CR 76)

Work Order #: 84708639  
 Design Date: 09-28-2017  
 City: LITTLE FALLS  
 Quad/Sec/Twp/Rng: NW SEC-171 T-40/ R-32  
 CP Section #: 23041  
 CP Area: AL1548-3  
 Designed By: P TEESELINK  
 Designer Phone #: 612.910.1378