

GENERAL LOCATION ONLY.
DO NOT USE TO LOCATE FOR EXCAVATION.
CALL 1-800-252-1166 FOR ONSITE LOCATIONS AND STAKING.

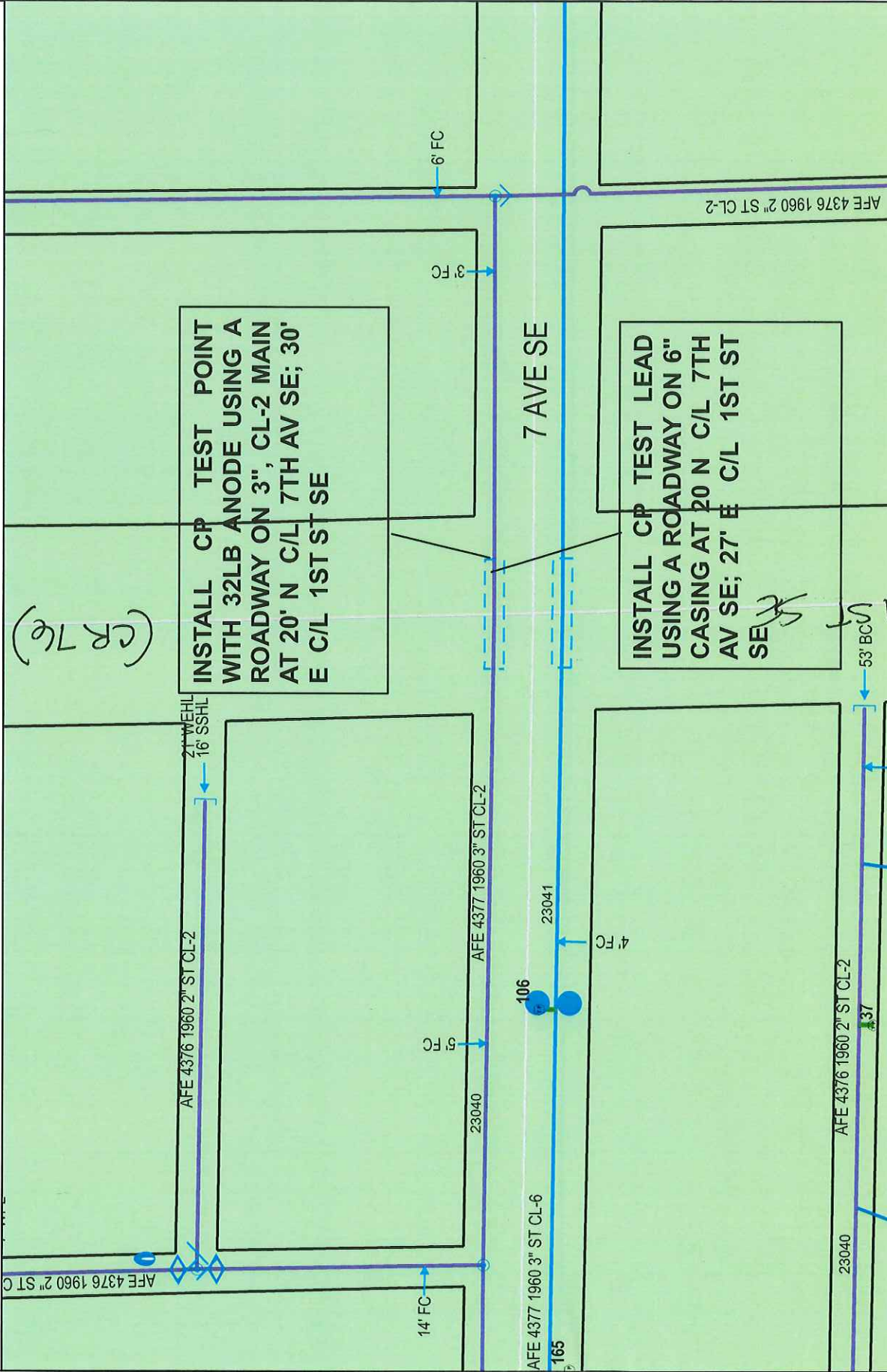

Scale: 1" : 67'



(CR 76)

INSTALL CP TEST POINT WITH 32LB ANODE USING A ROADWAY ON 3", CL-2 MAIN AT 20' N C/L 7TH AV SE; 30' E C/L 1ST ST SE

INSTALL CP TEST LEAD USING A ROADWAY ON 6" CASING AT 20' N C/L 7TH AV SE; 27' E C/L 1ST ST SE

Work Order #: 84708641
Design Date: 09-28-2017

City: LITTLE FALLS
Quad/Sec/Twp/Rng: NW SEC-17/T-40/R-32

CP Section #: 23040
CP Area: AL1548-3

Designed By: P. TEESELINK
Designer Phone #: 612 910 1378