

MORRISON COUNTY PUBLIC WORKS DEPARTMENT PERMIT APPLICATION FOR WORK ON COUNTY HIGHWAY RIGHT OF WAY

PERMIT FEE: \$25.00

DESCRIPTION OF WORK: (be specific) The proposed route for the installation of new
fiber optic cable would start at the intersection of US HWY #10 and County Road #202 going South
5,936 feet ending, with (4) Four road crossing.

Work to start on or after April 1st, 2011 and completed on or before Dec. 31st, 2011

CSAH/CO. RD. NUMBER: #202

LOCATION: 1.124 miles South of Intersection STH #10 and CR#202 on the East side of the road

APPLICANT'S NAME: Steve Gilbert- Consolidated Telecommunications Com

ADDRESS: 1102 Madison Street, Brainerd, MN 56401

PHONE NUMBER: 218-454-1234

CONTRACTOR'S NAME: _____ PHONE: _____

In accordance with the application herein, a Permit is granted for work within county right-of-way at the location described above and in such manner as may be specified by the Public Works Department.

SPECIFICATION:

"See Attached"

Before any work is done the Applicant shall furnish a deposit in favor of the County Treasurer of Morrison County in the amount of \$ _____. Deposit, less cost of any repair by County, will be returned upon acceptance of work by County Engineer.

Applicant Signature Date: _____

=====

Do Not Write Below This Line:

Check Number: _____ (\$25 Permit Fee plus Deposit)

Check Number: _____ (Deposit)

Check Number: _____ (\$30 Right of Way Registration Fee, if applicable)

Date Permit Approved: _____ Date Work Approved: _____

Deposit returned Warrant # _____ Amount: \$ _____

County Highway Engineer: _____

SPECIAL PROVISIONS

MORRISON COUNTY PUBLIC WORKS

The Applicant agrees to the following conditions covering the construction work:

1. The Applicant shall assume all liability for, and save the County, its agents and employees harmless from any and all claims for damages, actions or causes of action arising out of the work to be done and the continuing uses by the Applicant, including but not limited to the placing, constructing, maintaining and using of said utility under this application and permit.
2. Said work shall be completed in conformity with all applicable laws, regulations and codes covering said work. All installation/construction shall be made in conformity with regulations of governmental agencies for the protection of the public.
3. Wherever topsoil and sod are disturbed they shall be replaced and maintained until the turf is established.
4. The said construction and/or installation shall not interfere with any existing utility facilities on the county highway right-of-way.
5. Necessary barricades, warning devices and flagman shall be provided by the Applicant during all phases of their construction and maintenance operations on county highway right-of-way.
6. Upon completion of installation/construction, the Applicant shall restore the county highway right-of-way to its original condition, the Applicant shall then notify the office of the County Highway Engineer of the completion of the work so that inspection can be made to determine its acceptability.
7. Damage resulting from the installation/construction described shall be paid for in its entirety by the Applicant.
8. Notice to the Public Works Department that the work shall take place shall be at least 24 hours.
9. Applicant is responsible for contacting Gopher State One Call for utility locates before they began work.
10. All underground facilities must be Registered with Gopher State One Call before deposit will be returned. (Forms available at Public Works – no charge to get Registered)
11. The Morrison County Ordinance for the Management of Public Right of Way states that all underground facilities within county right-of-way be Registered with Morrison County (Forms available at Public Works - \$30 Registration Fee) All after the fact Right of Way Registration/Permit fees for Morrison County are doubled.

*Morrison County Public Works Department
213 First Avenue Southeast
Little Falls MN 56345*

Phone: 320-632-0121

Morrison County County Road #202

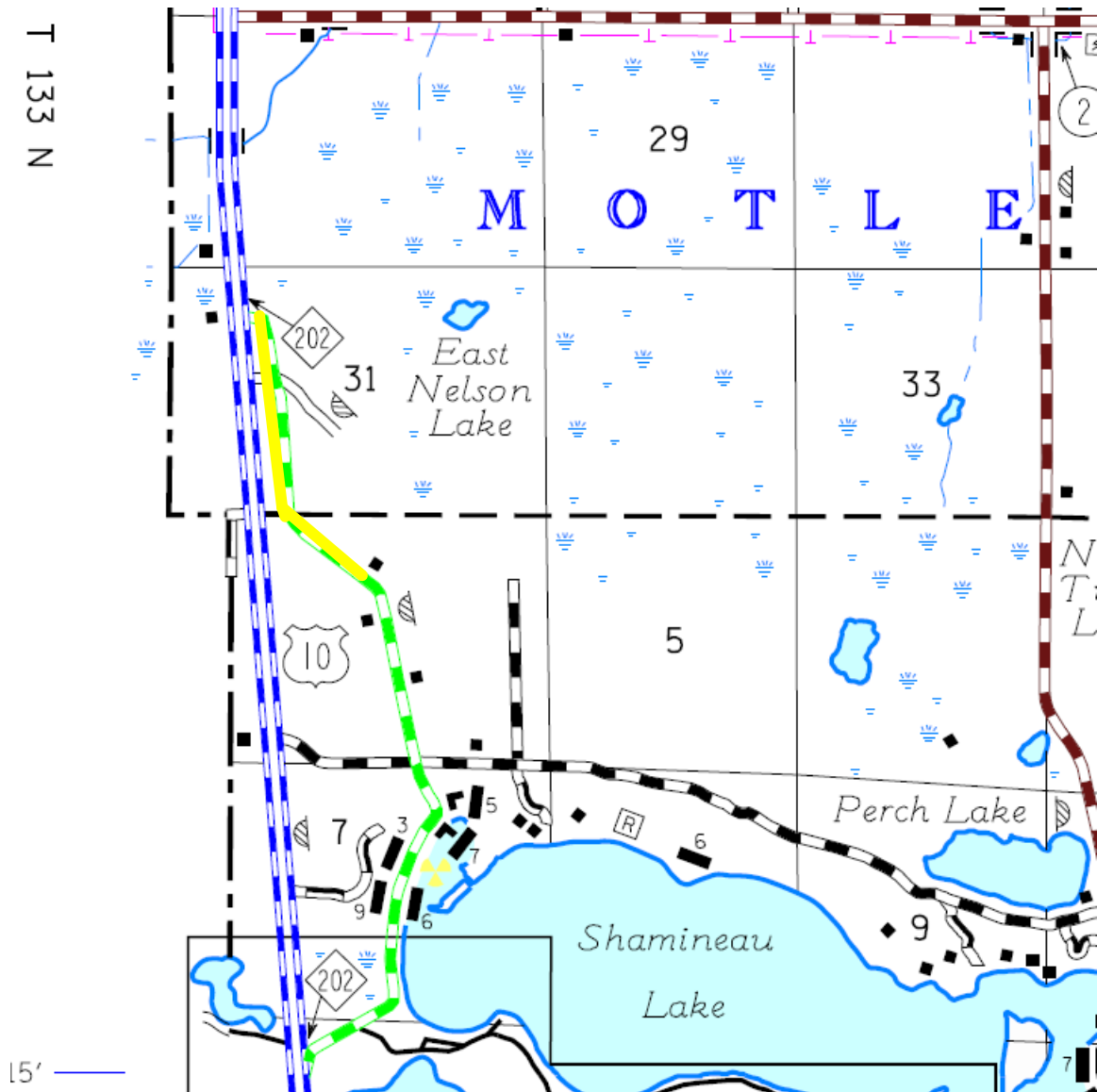

Proposed Route Highlighted in Yellow

**Approx 1.12 miles or 5,936 feet
With 4-Road Crossings**

DISTANCE FROM C ROAD SEE NOTATION		BURIED PLANT STAKING SHEET & PLANT RECORD		SEC 6	SHEET 2 OF 3
STAKED BY DAS	DATE 9/3/09	COMPANY CTC	TWP. 132N	ROUTE 3C	
REV.	REV.	PROJECT MN 537	RANGE 31W	MAP REFERENCE Pon 3	
AS BUILT ENT. BY	DATE	EXCHANGE MOTLEY	CO Morrison		

														KZ Contract								
PED.	BA	BDO				BFO	BFO		SUB.	SEB	N/d	BM				H0					
			4				24	(48	48)D	NO.	4	3	2 3/8 (8"	53	140 (1 1/2)P	600 1/2 +1 1/2)P	61 (3)	-1	BA	BD	N/d	
4			1					1242	1206				1					2				
4A			1				126			36619	230	1	1		110		5	1				
5			1					2414	2378				1	1		26		3				
5A			1				126			36145	500	1	1		110		1					
										36083	400	1					150					
			4				252	3656	3584			1130	3.	4	1	220	26	155	7.	2	2	2

8



(31)

DISTANCE FROM Q HOAC SEE NOTATION		BURIED PLANT STAKING SHEET & PLANT RECORD		SEC 6	SHEET 3 OF 3
STAKED BY DAS	DATE 9/3/09	COMPANY CTC	TWP 132 N	RANGE 31 W	ROUTE 3C
REV	REV	PROJECT MN 537	2010	CO MORRISON	MAP REFERENCE Ton 3
AS BUILT BY	DATE	EXCHANGE MOTLEY			

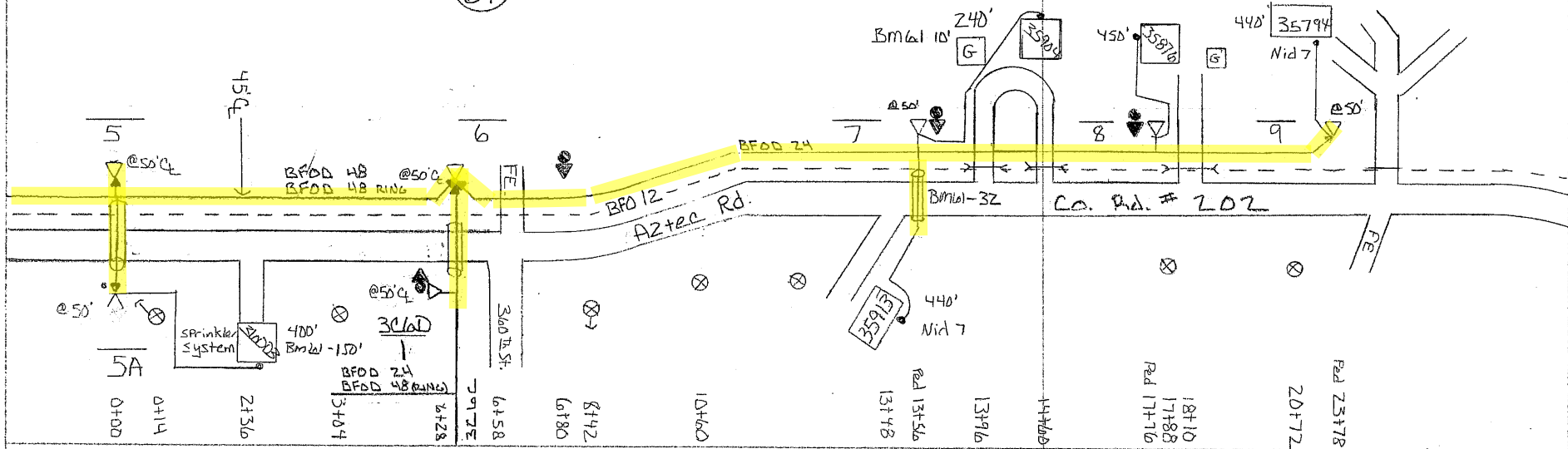

PED	BA	BDO	UD	BFO	SUB	SEB	Nid	Nid	BM	HO	KZ Contract				
	21	4	(1X1-1)S	24	(48.4-48)D	NO.	4	3	7	(518XB)	(61/3)	-1	BA	BD	Nid
6		1		664	628				1			36			
7	2	1		764		35904	240	1	1	10		2			
8		1	20	456		35913	440	1	1	32		1			
9	2	1	20	638		35876	450	1	1	1		1			
	4	4	40	1858	664	628	35794	440	1	4	42	40	4	4	4