

GENERAL LOCATION ONLY.
 DO NOT USE TO LOCATE FOR EXCAVATION.
 CALL 1-800-252-1166 FOR ONSITE LOCATIONS AND STAKING.

Scale: 1" = 151'

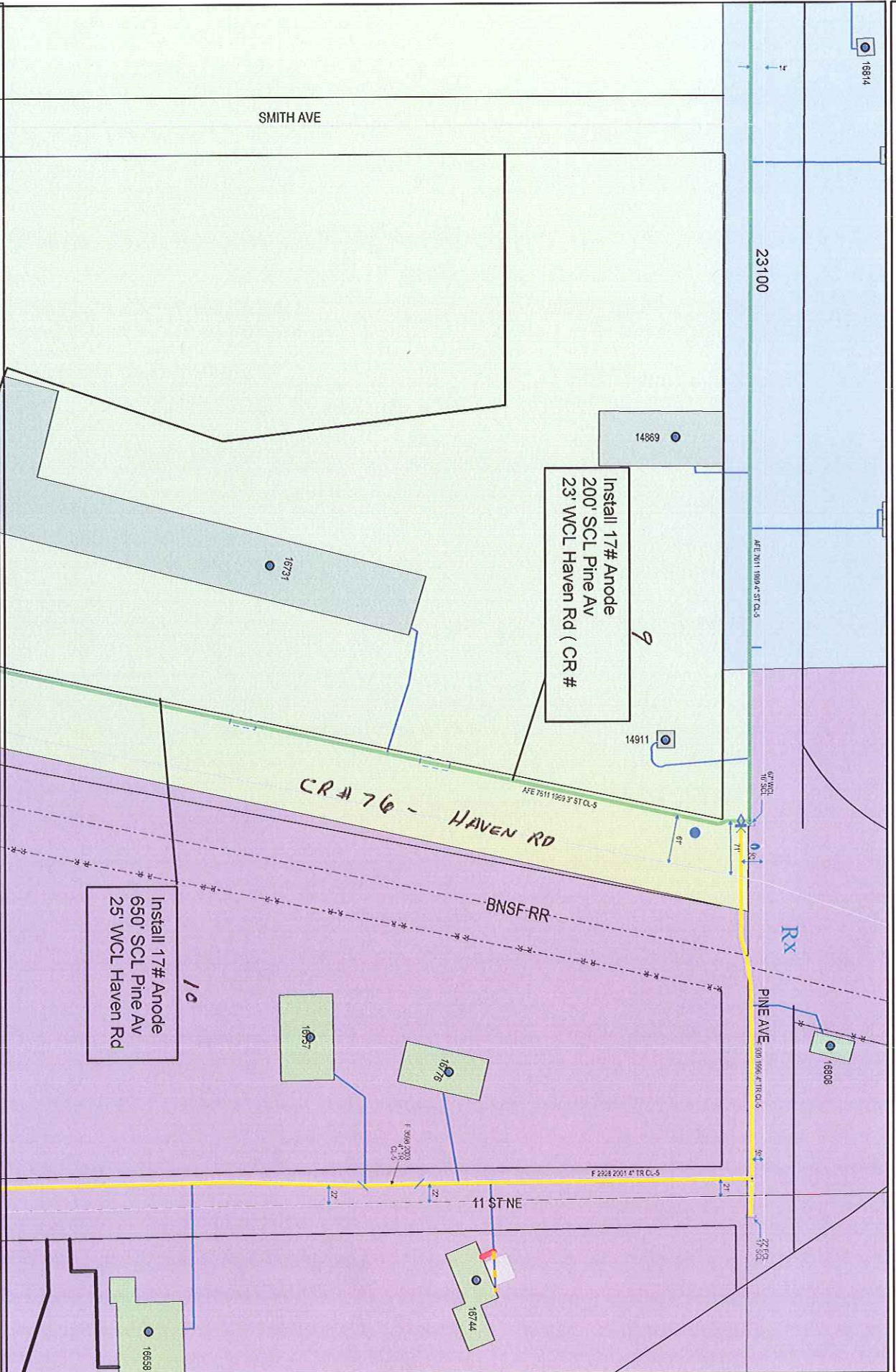

Work Order #: 58237905
 Design Date: 03/07/2011

City: Little Falls, Mn
 Quad/Sec/Twp/Rng: NW 1/4 Sec 26 T 41 Rg 32

CP Section #: 23100
 CP Area: 1549

Designed By: Kevin Klingel
 Designer Phone #: 763-754-4150

GENERAL LOCATION ONLY.
DO NOT USE TO LOCATE FOR EXCAVATION.
CALL 1-800-252-1166 FOR ONSITE LOCATIONS AND STAKING.

Scale: 1" : 200'

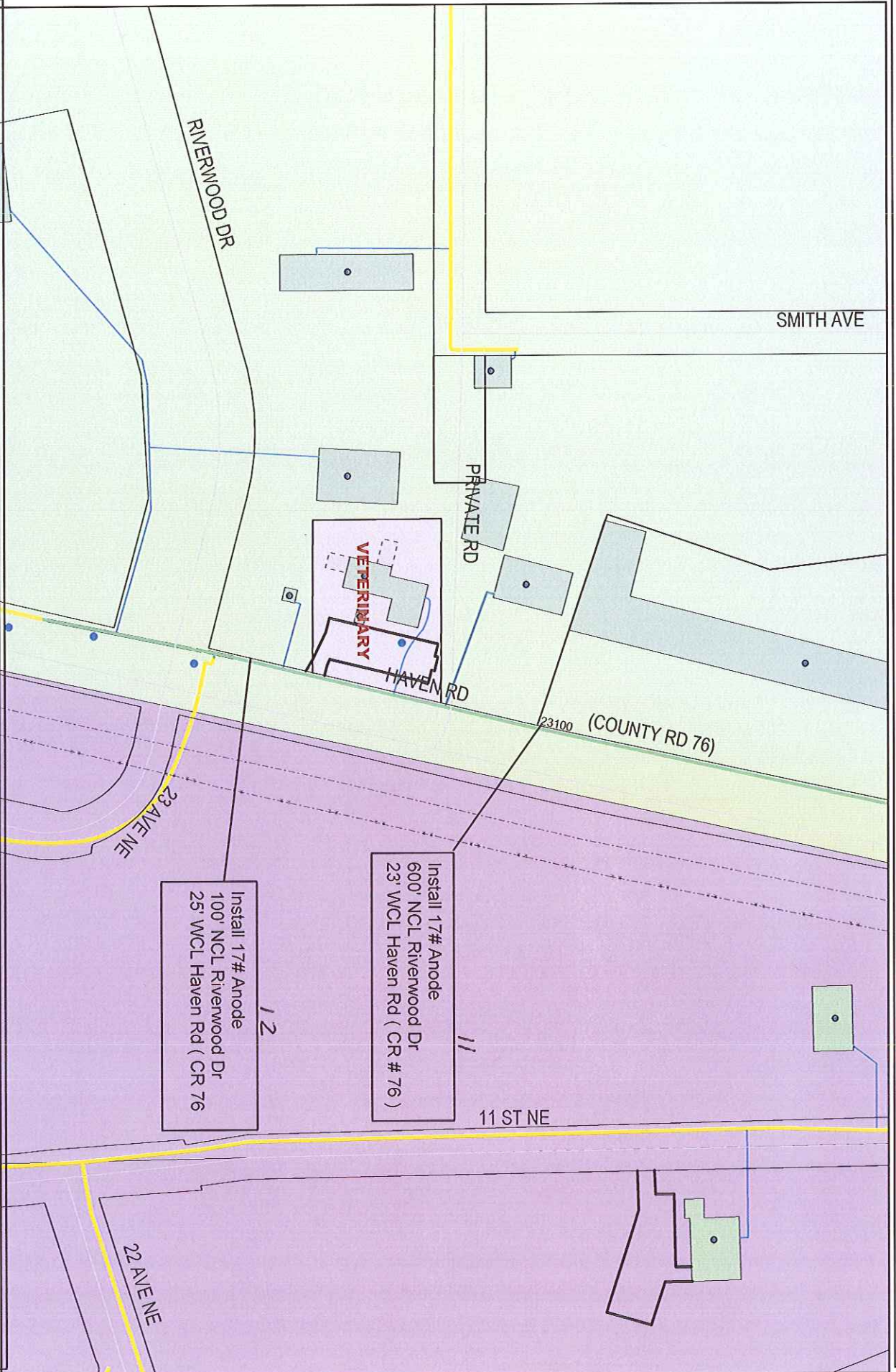

Install 17# Anode
600' NCL Riverwood Dr
23' WCL Haven Rd (CR # 76)

Install 17# Anode
100' NCL Riverwood Dr
25' WCL Haven Rd (CR 76

Work Order #: 582.37965
Design Date: 03/07/2011

City: Little Falls, Mn
Quad/Sec/Twp/Rng: NW 1/4 Sec 26 T 41 Rg 32

CP Section #: 23100
CP Area: 1549

Designed By: Kevin Klingel
Designer Phone #: 763-754-4150