

E.263707
 PIRZ RDMV 2MCLCSA#37

MORRISON COUNTY
 T40 R30 SEC 7#8
 COUNTY PERMIT NEEDED, HILLMAN TWP NEEDED
 DUE DATE 09/09/2011

WORK LOCATION

Gopher state one call
1-800-252-1166

note:
location of existing
facilities are approximate
only

contractor shall locate all
underground facilities
substructures and drainage tiles
prior to construction

CSAH 39

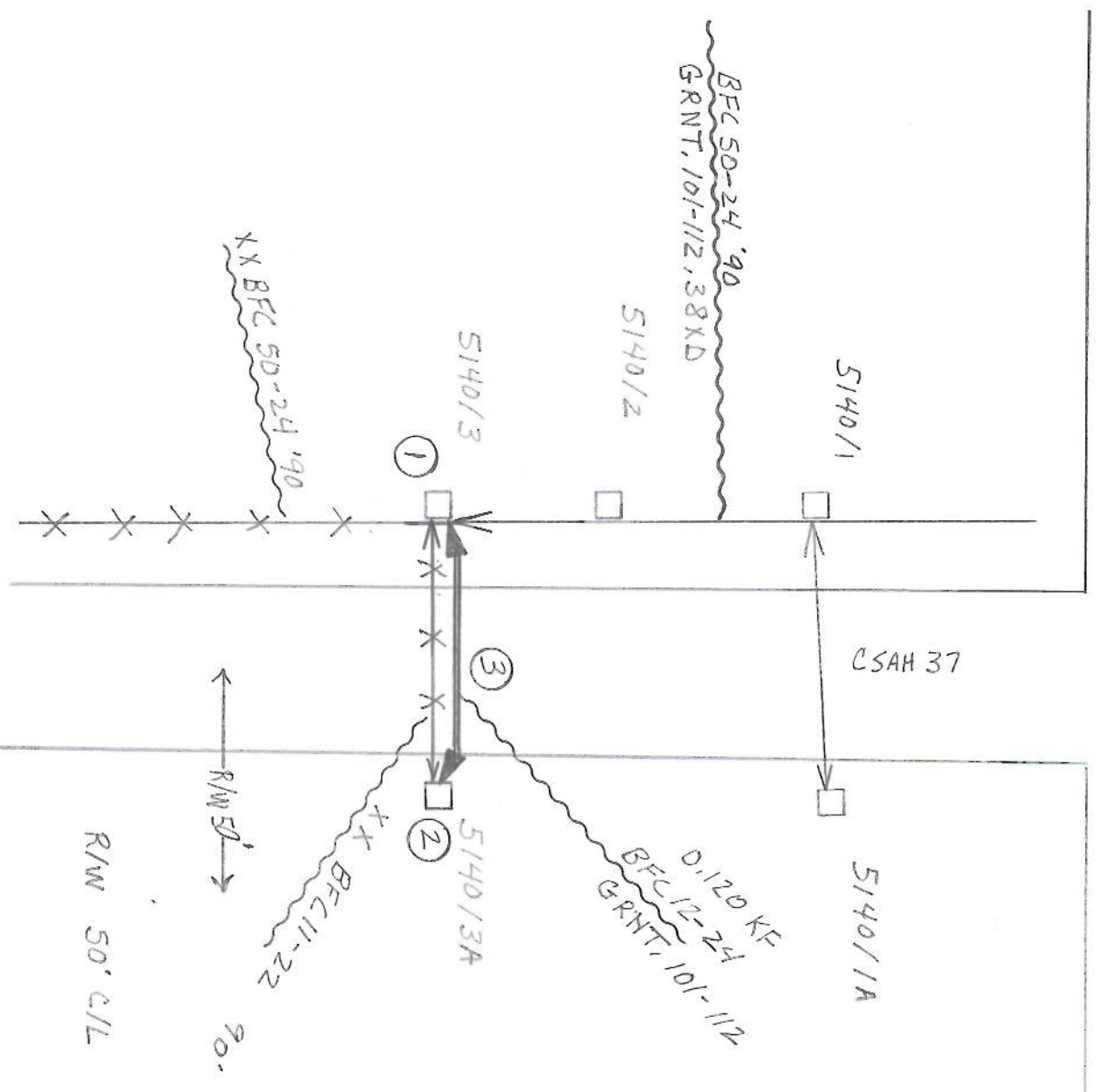

LD1 RETAIN PED
REMOVE CABLE SOUTH

LD2 MOVE PED EAST TO R/W 50' C/L
EXPOSE DROP ADD TO PED
AT NEW LOCATION

LD3 BORE 55'

LOCAL CONTACT:
CRAIG 320-630-4999
CALL BEFORE WORK STARTS

SHEET 2 OF 3

LEAD NUMBER	GPS DATA		BD UNITS		CABLE UNITS			MISCELLANEOUS UNITS			SPICING UNITS			DROP UNITS		XX UNITS	XZ UNITS		
	LATITUDE	LONGITUDE	BD3	BD4	BFC	BFC	BFC	BM2	BM	BM	BM	HC-3	HC-1	WHC-1	HOUSE NUMBER			SEBP	NID
					200-24	50-24	25-24	5(8/8)	2C	52	2(2)PD					6-22	(1)63		
TOTALS																			

Gopher state one call
1-800-252-1166

note:
location of existing
facilities are approximate
only

contractor shall locate all
underground facilities
substructures and drainage tiles
prior to construction

LD 4 EXPOSE 11 PR SOUTH
MOVE PED SOUTH/WEST TO 50' R/W

LD 5 SET NEW PED
EXPOSE CABLE EAST ADD TO PED

LD 6 NEW PED NORTH OF DRIVEWAY

LD 7 NEW PED BY POWER POLE

LD 8 BORE 230'

LD 9 BORE 20'

LD 10 BORE 55'

LD 11 REMOVE PED

NOTE:
PLACE CABLE 48' C/L

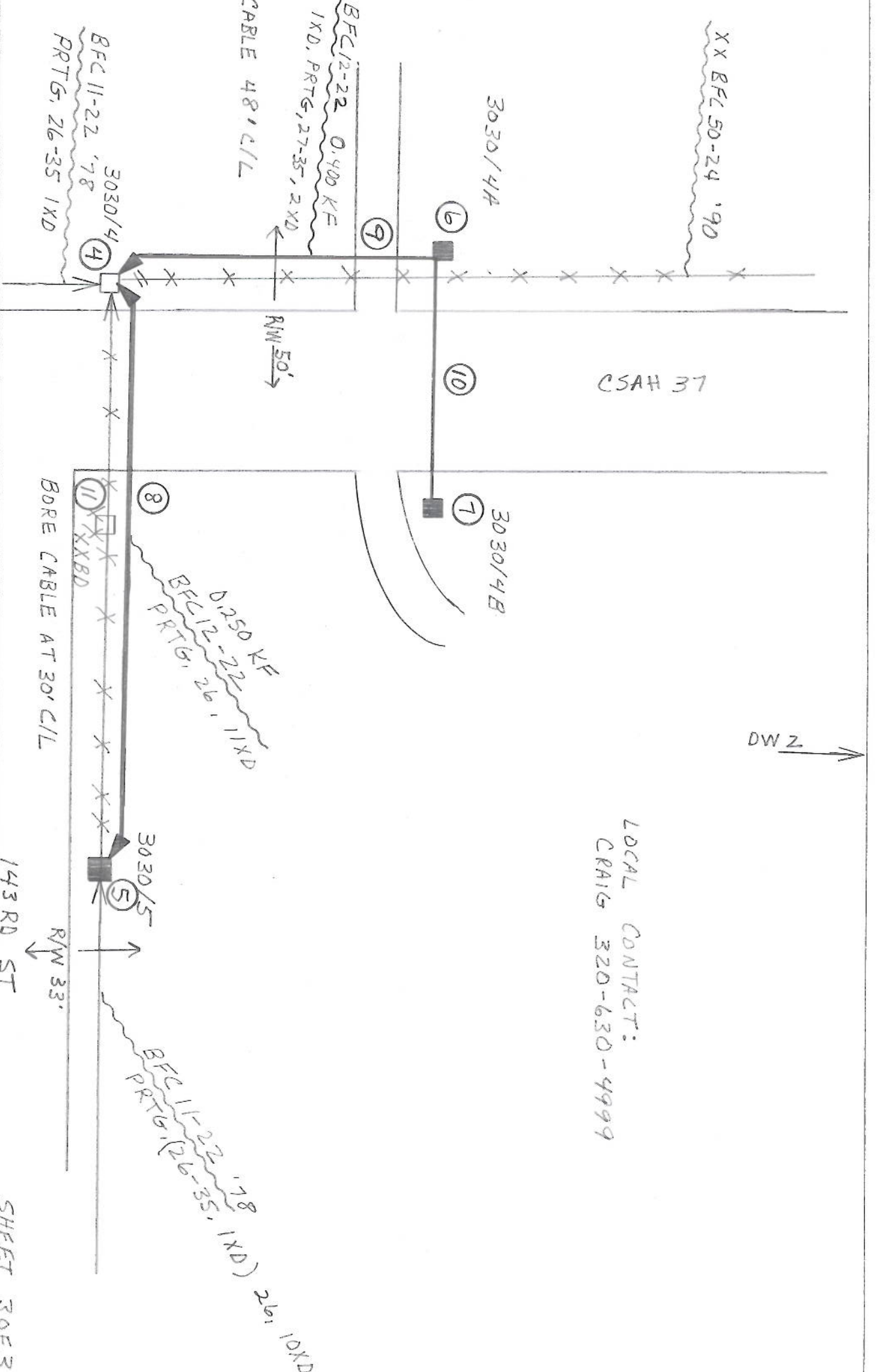

LOCAL CONTACT:
CRAIG 320-630-4999

LEAD NUMBER	GPS DATA		BD UNITS		CABLE UNITS			MISCELLANEOUS UNITS			SPlicing UNITS			DROP UNITS		XX UNITS	XZ UNITS					
	LATITUDE	LONGITUDE	BD3	BD4	BFC	BFC	BFC	BM2	BM	BM	BM60	BM	HC-3	HC-1	WHC-1			HOUSE NUMBER	SEBP	NID	BD	
TOTALS																						