

DATE	REVISION AND PURPOSE	DRAWN BY

PROPOSED LEGEND

- TYPE OF CABLE (FIBER) AND SIZE
- FIBER
- FIBER DROP (4 PAIR)
- DUCT
- FIBER PED
- FACILITY CHANGE
- FIBER HANDHOLE
- FIBER MANHOLE

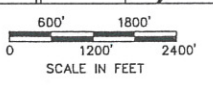

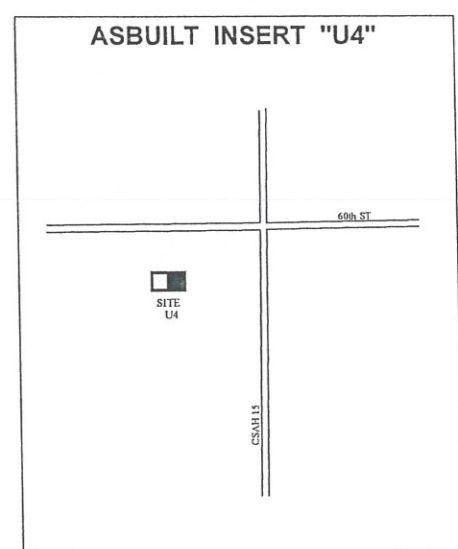
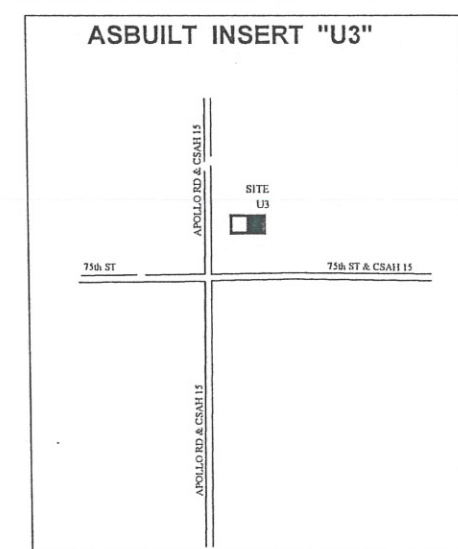
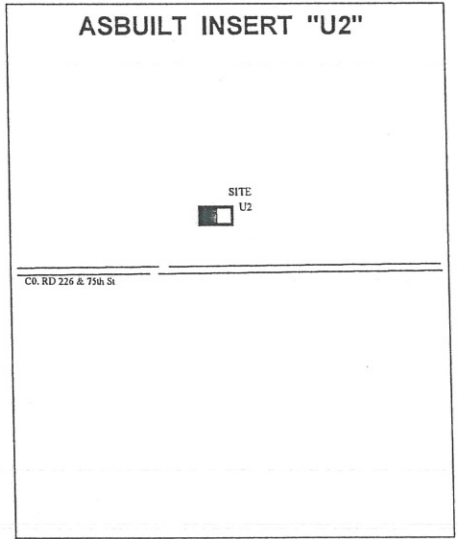
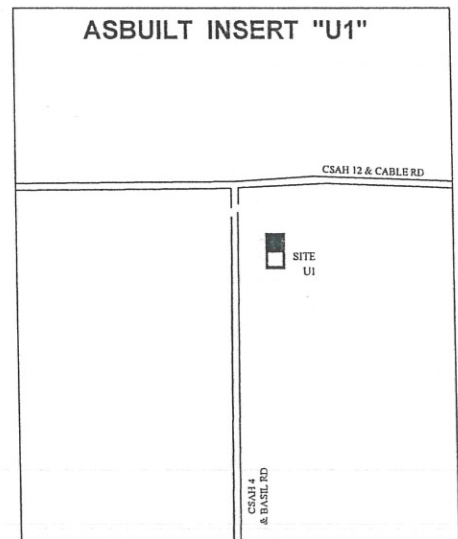
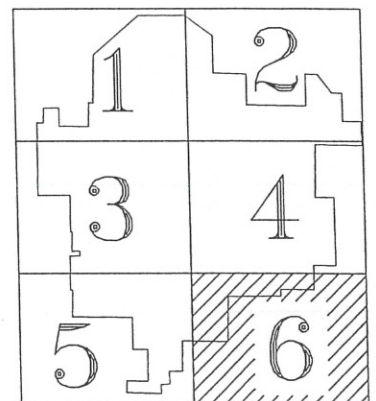
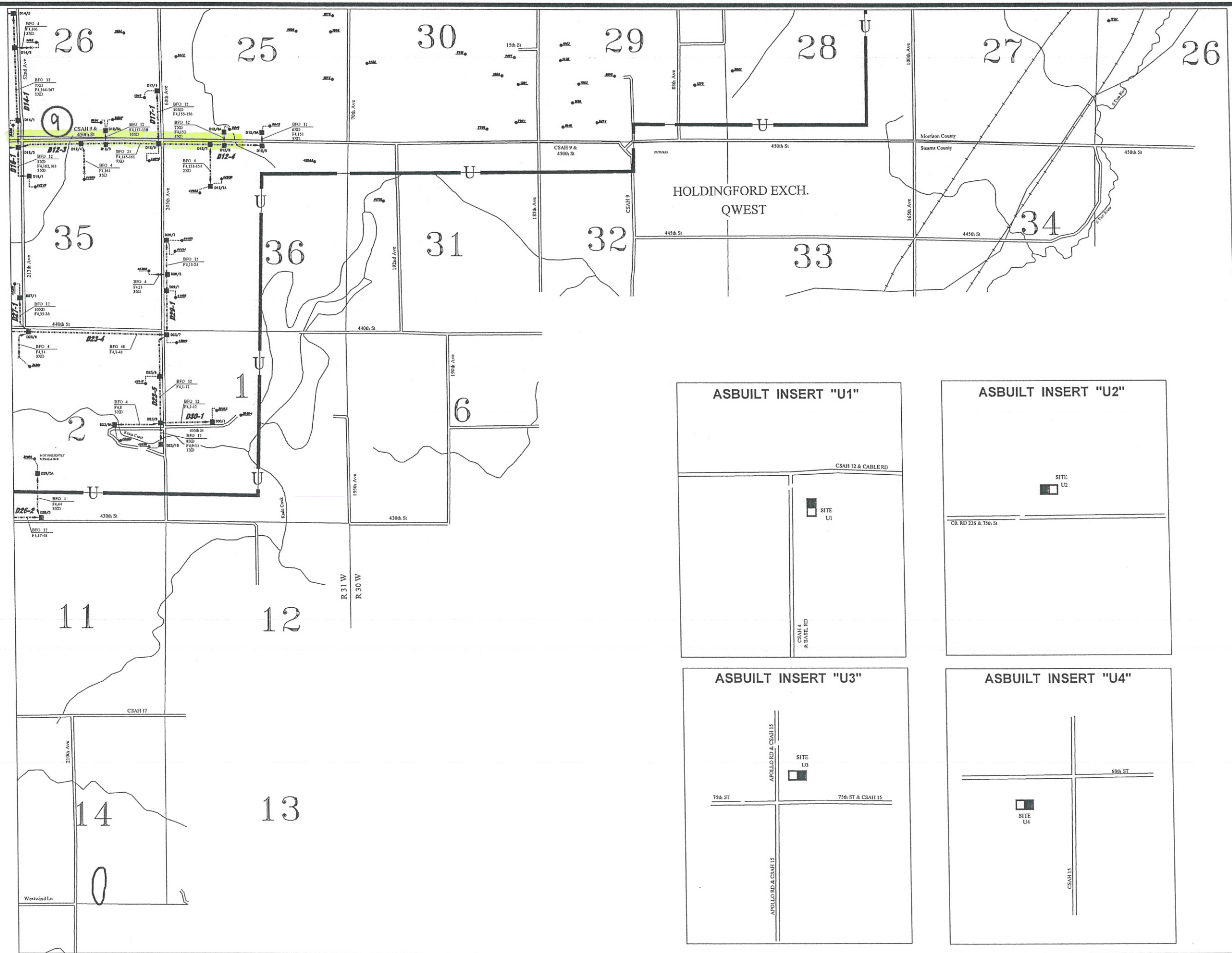

DATE	REVISION AND PURPOSE	DRAWN BY
4-1-12	PROPOSED 2012 CONSTRUCTION	FRC
3-1-12	AS BUILT	FRC

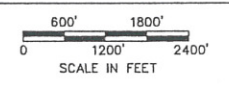

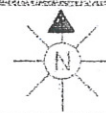
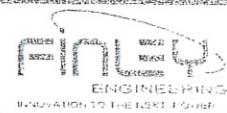

SEC. 33, 34	STAKED BY FEC-JM	EXCHANGE UPSALA	LEAD D
TWP. 127N	DATE 1-12	STAKING SHEET AND PLANT RECORD	SHEET 4 OF 13
COUNTY STEARNS	RGE. 31W	REL.	REV.
PROJECT		MAP REF.	

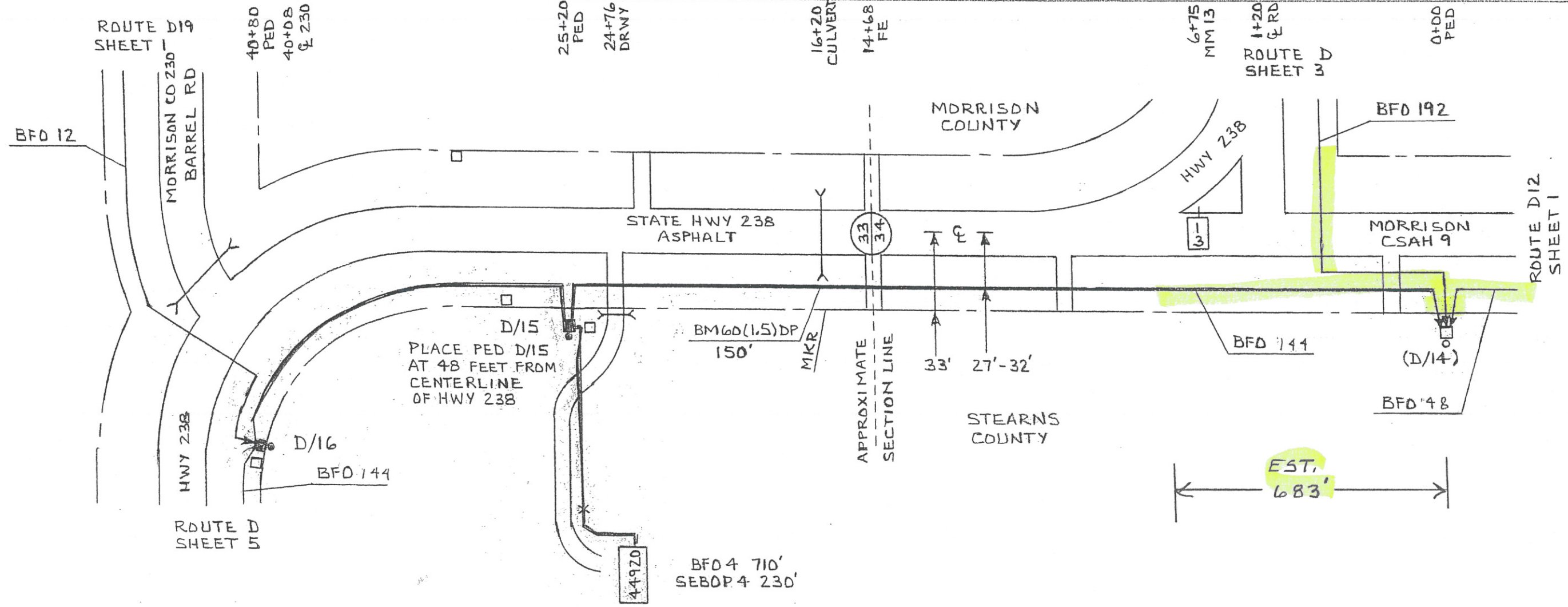

PED OR STA#	PED			MISC.				SPLICE				CABLE				MISC. NOTES
	BD	BA 23	BDO 1DA	BM2 (5/23)	BM 53	BM60 (1.5)DP	BM 83	HD-1	BFD 144	BFD 4	SEBDP 4	NID (FO)				
(D/14)																
D/15		1	1	1	1	150		1	2586	710	230	1	44920			
D/16		1	1	1				3	1610							
TOTAL		2	2	3	1	150	1	4	4196	710	230	1				

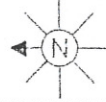
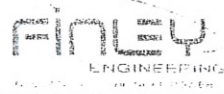

COUNTY MORRISON

SEC 27 STAKED BY P.E.C.
 TWP. 12TN DATE 1-10
 RGE. 31W REL. REV. PROJECT

EXCHANGE LIPSALA
 STAKING SHEET AND PLANT RECORD

LEAD D
 SHEET 3 OF 13
 MAP REF.

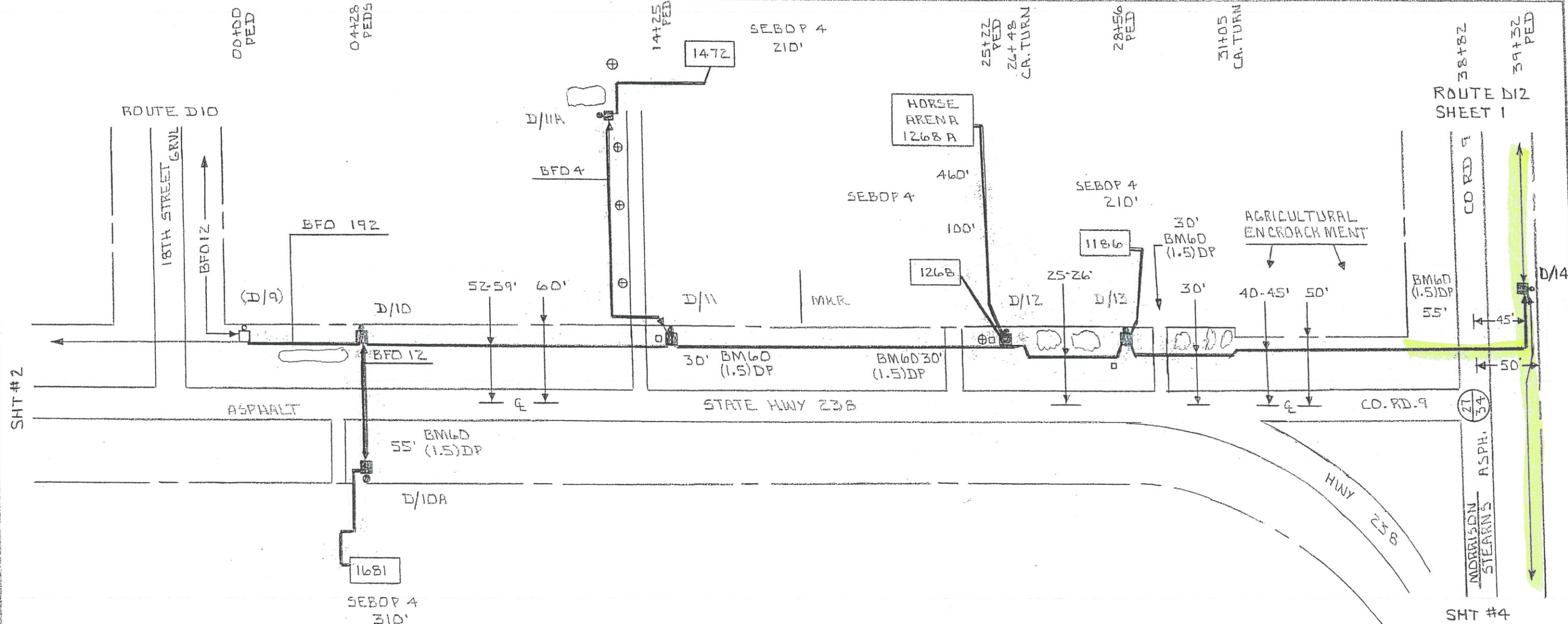

PED OR STAKE	PED POLE		MISC.							SPLICE			CABLE				NID	FO	MISC NOTES	
	BD	BA 23	BDD 12R	BDD 6A	BDD 10A	BM 5/BXB	BM 53	BM60 (1.5)DP	BM 83	HO-1	BFD 192	BFD 12	BFD 4	SEBOP 4						
(D/9)		(1)	(1)																	
D/10		1			1	1				1	468									
D/10A		1		1				55		1		150								
D/11		1			1	1				1	1044								1	1681
D/11A		1		1						1						840				
														210					1	1472
D/12		1			1	1				2	1142								1	1268
														100					1	1268A ARENA
D/13		1			1	1				1	372			460					1	
								30						210					1	1186
D/14		1	1			1		55		187	1218									
TOTAL		7	1	2	4	12	1	200	5	199	4244	150	840	1290				5		

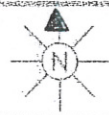

SEC. 34	STAKED BY FEC - JM	EXCHANGE UPSALA	LEAD D12
TWP. 127N	DATE 1-12	STAKING SHEET AND PLANT RECORD	SHEET 1 OF 4
COUNTY STEARNS	RGE. 31W	REL.	REV.
PROJECT	MAP REF.		

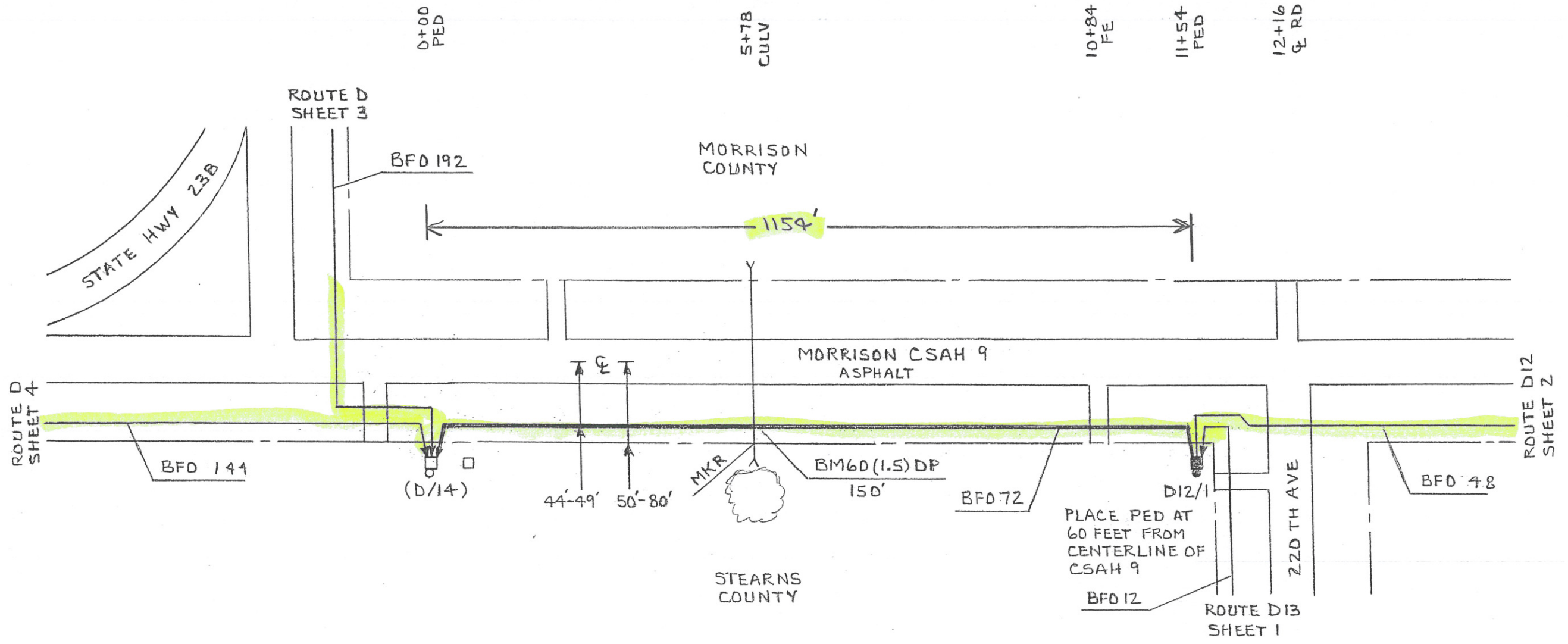

PED OR STA#	PED			POLE			MISC.			SPLICE			CABLE			MISC. NOTES
	BD	BA	BDO	BM2 (5/8)	BM 53	BM60 (1.5) DP	HD-1	BFO 48								
(D/14)																
D12/1		1	1		1	1	150	5	1232							
TOTAL		1	1		1	1	150	5	1232							

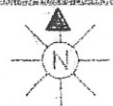
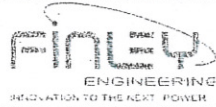

SEC. 34, 35	STAKED BY FEC-JM	EXCHANGE UPSALA	LEAD D12
TWP. 127N	DATE 1-12	STAKING SHEET AND PLANT RECORD	SHEET 2 OF 4
COUNTY STEARNS	RGE. 31W	REL.	REV.
PROJECT		MAP REF.	

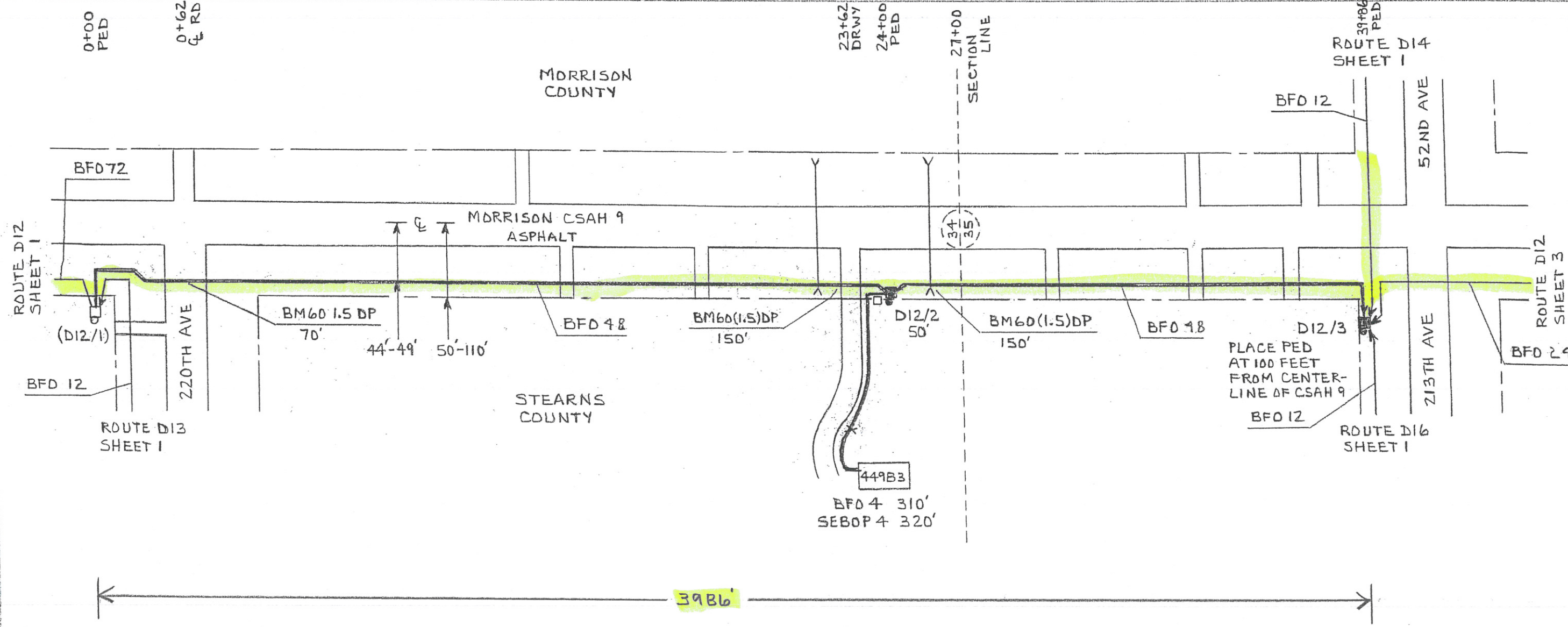

PED OR STA#	PED		POLE		MISC.					SPLICE		CABLE				MISC. NOTES
	BD	BA 23	BDO 8A	BDD 6A	BM2 (5/8)	BM60 (1.5)DP	BM 83	HD-1	BFO 48	BFO 4	SEBOP 4	NID (FO)				
(D12/1)																
D12/2		1		1		70		1	2460							
D12/3		1	1			150		23	1648							
TOTAL		2	1	1		2 370		24	4108 310		320		1			

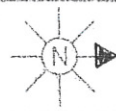
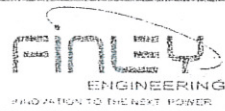

COUNTY MORRISON

SEC. 26 STAKED BY FEC-JM
 TWP. 127N DATE 1-12
 RGE. 31W REL. REV. PROJECT

EXCHANGE UPSALA
 STAKING SHEET AND PLANT RECORD

LEAD D14
 SHEET 1 OF 1
 MAP REF.

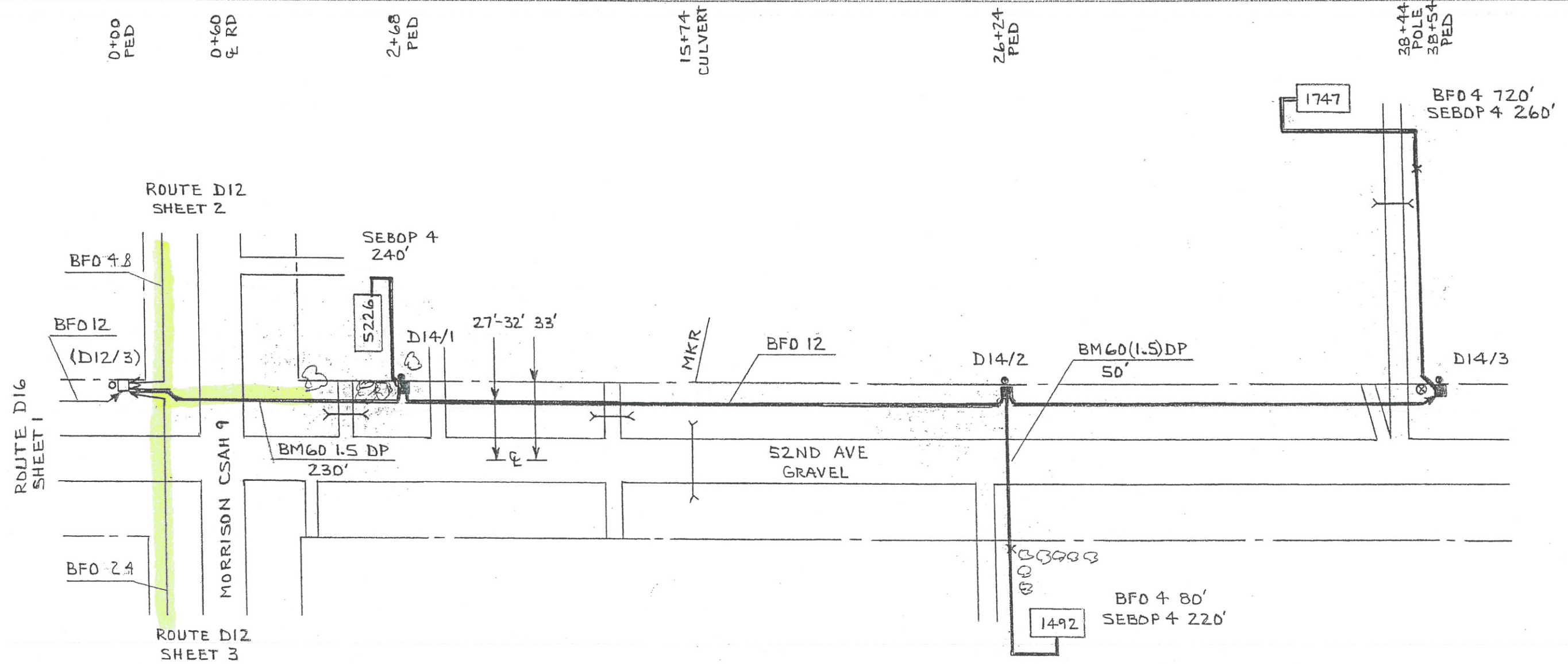

PED OR STA#	PED		POLE		MISC.				SPLICE			CABLE			MISC. NOTES
	BD	BA	BDO	BA	BM2 (5/8) 53	BM3 (1.5) DP	BM83	H0-1	BFD 12	BFD 4	SEBOP 4	NID (FD)			
(D12/3)															
D14/1		1	1			230		1	302		240	1	5226		
D14/2		1	1			50		1	2388	80	220	1	1492		
D14/3			1	1				1	1264	720	260	1	1747		
TOTAL		3	3		6	1	280	3	3954	800	720	3			

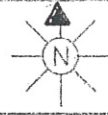

SEC. 35	STAKED BY FEC-JM	EXCHANGE UPSALA	LEAD D12
TWP. 127N	DATE 1-12	STAKING SHEET AND PLANT RECORD	SHEET 3 OF 4
COUNTY STEARNS	RGE. 31W	PROJECT	MAP REF.

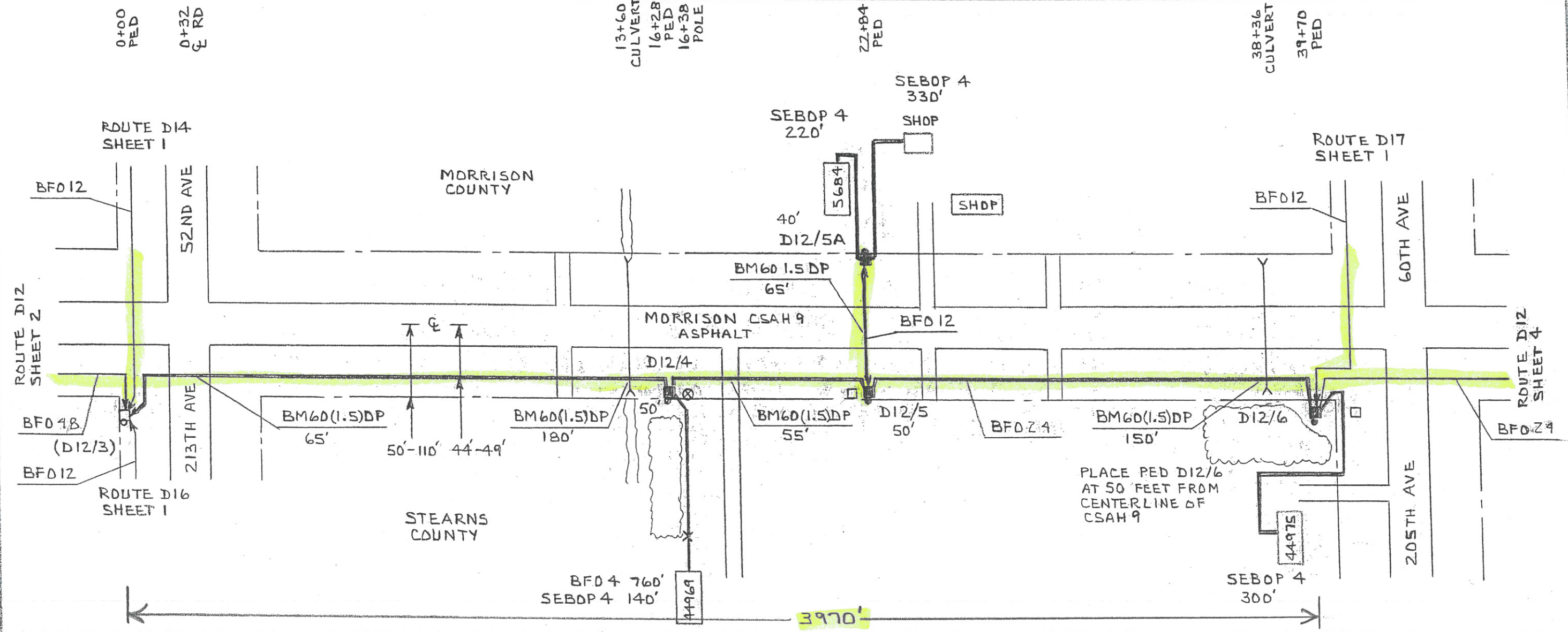

PED OR STA#	PED		POLE		MISC.				SPLICE		CABLE				MISC. NOTES
	BD	BA	BDA	BDA	BM2 (1.5)DP	BM60 (1.5)DP	BM 83	H0-1	BFO 24	BFO 12	BFO 4	SEBDP 4	NID (FO)		
(D12/3)						65									
D12/4		1		1		180		1		1690					
D12/5		1		1		55		2		678					
D12/5A		1		1		65		2			90				
												220	1	5684	
												330	1	5684 SHOP	
D12/6		1		1		150		3		1730					
												300	1	44975	
TOTAL		4		4		7 515		4	8	4098	90	760	4	990	



SEC. 26	STAKED BY FEC-JM	EXCHANGE UPSALA	LEAD D17
TWP. 127N	DATE 1-12	STAKING SHEET AND PLANT RECORD	
RGE. 31W	REL. REV.	PROJECT	SHEET 1 OF 1
COUNTY MORRISON			MAP REF.

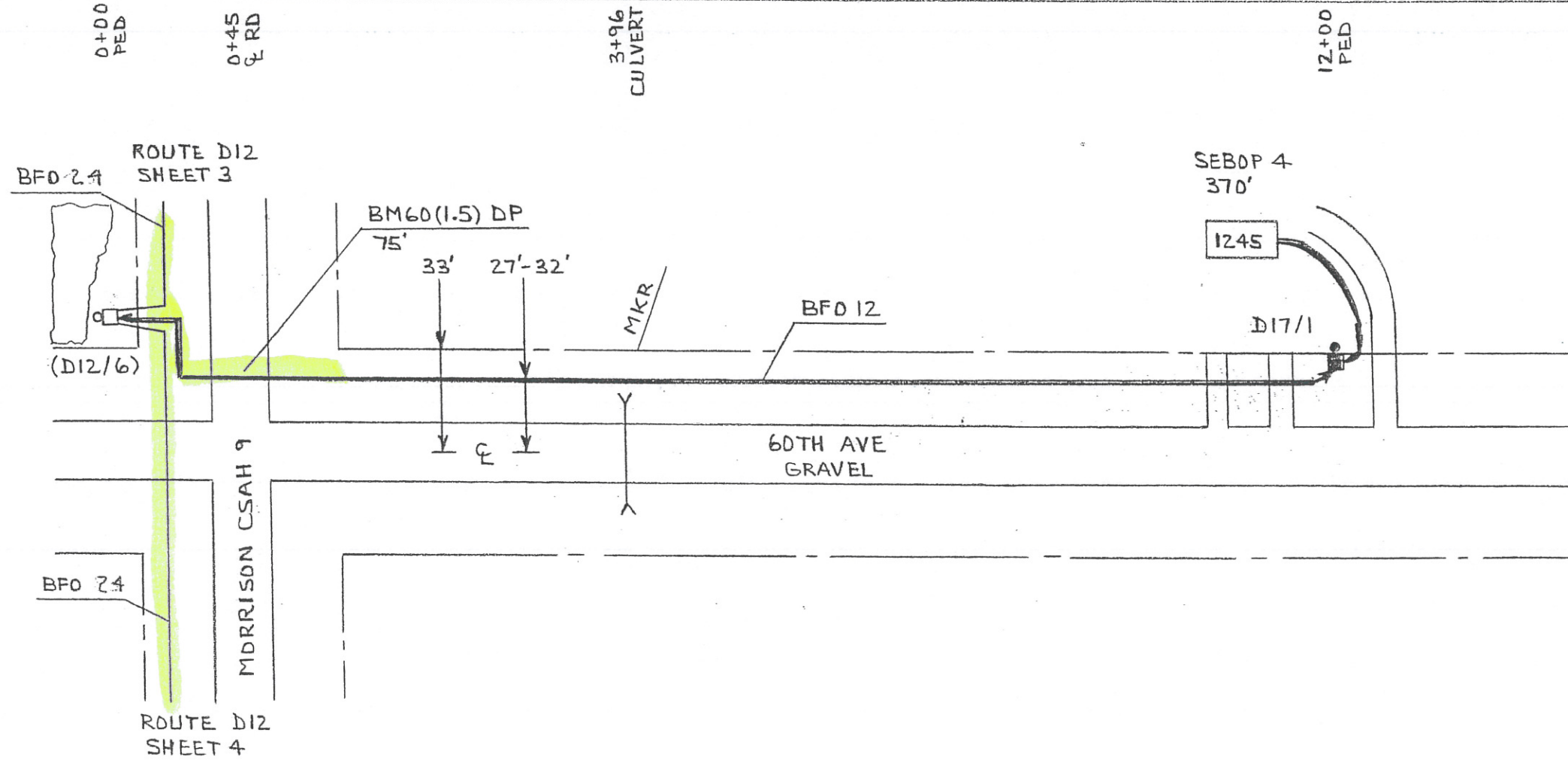

PED OR STA#	PED POLE			MISC.				SPLICE			CABLE				MISC. NOTES
	BD	BA 23	BDO 6A	BM2 (5/8)(8)	BM 53	BM60 (1.5)DP	BM 83	H0-1	BFD 12	SEBOP 4	NID (FD)				
(D12/6)															
D17/1		1	1			75		1	1266			370	1	1245	
TOTAL		1	1		2	75	1	1	1266			370	1		

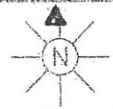

SEC. 36	STAKED BY FEC-JM	EXCHANGE UPSALA	LEAD D12
TWP. T127N	DATE 1-12	STAKING SHEET AND PLANT RECORD	SHEET 4 OF 4
COUNTY STEARNS	RGE. 31W	REL. REV.	PROJECT
			MAP REF.

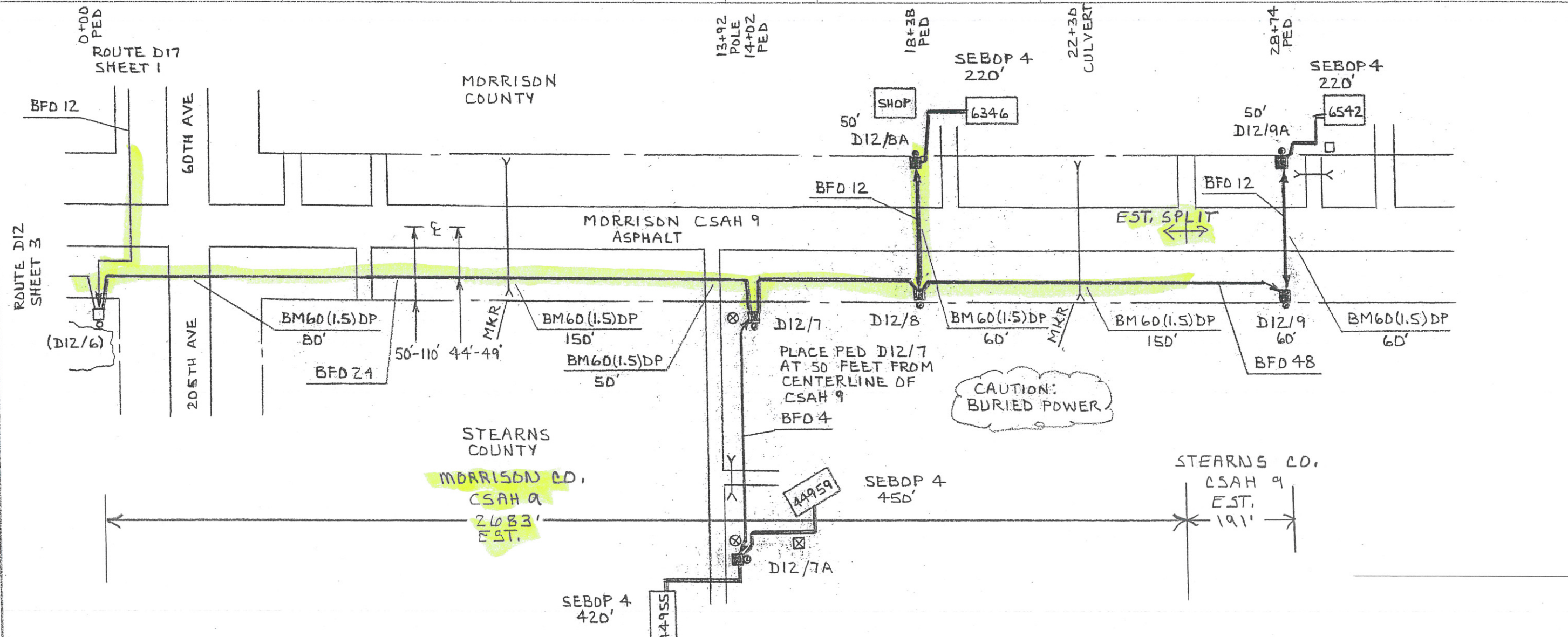

PED OR STA#	PED		POLE		MISC.				SPLICE			CABLE				MISC. NOTES
	BD	BA	BDO	BDD	BM2 (9/8)	BM 53	BM60 (1.5)DP	BM 83	HD-1	BFD 24	BFD 12	BFD 4	SEBDP 4	NID (FO)		
(D12/6)							80									
D12/7		1		1	1	1	50		2	1460						
D12/7A		1		1	1			1	2			1030			44955	
								1				420		1	44959	
D12/8		1		1	1			1	1	482						
D12/8A		1		1	1		60	1	1		90					
					1			1				220		1	6346	
D12/9		1		1	1	1	150		1	1070						
D12/9A		1		1	1		60	1	1		90					
					1			1				220		1	6542	
TOTAL		6		6		8	2	550	4	8		3012	180	1030	1310	4