

DATE	REVISION AND PURPOSE	DRAWN BY
4-1-12	PROPOSED 2012 CONSTRUCTION	FEC
8-1-12	AS BUILT	FEC

PROPOSED LEGEND

- TYPE OF CABLE (FIBER) AND SIZE
- FIBER DROP (4 PAIR)
- DUCT
- FIBER PED
- FACILITY CHANGE
- FIBER HANDHOLE
- FIBER MANHOLE

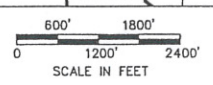

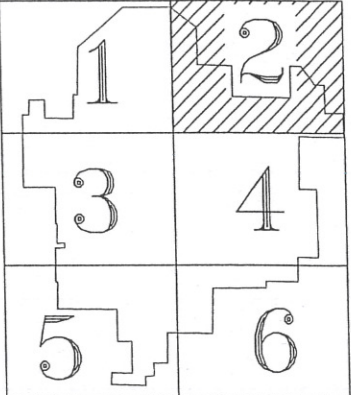
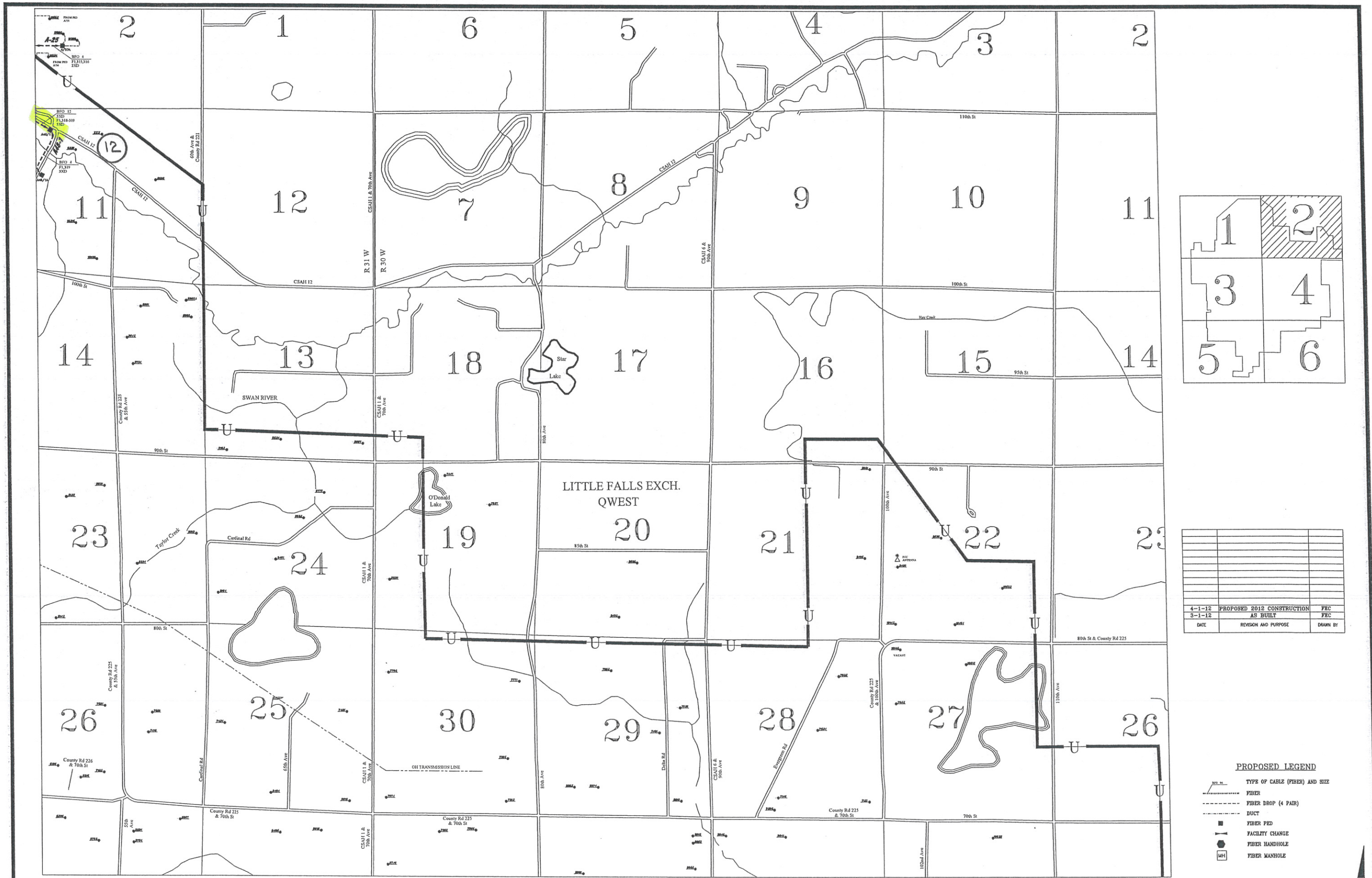

DATE	REVISION AND PURPOSE	DRAWN BY
4-1-12	PROPOSED 2012 CONSTRUCTION	FEC
3-1-12	AS BUILT	FEC

PROPOSED LEGEND

- TYPE OF CABLE (FIBER) AND SIZE
- FIBER
- FIBER DROP (4 PAIR)
- DUCT
- FIBER PED
- FACILITY CHANGE
- FIBER HANDHOLE
- FIBER MANHOLE

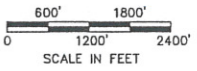

PROJECT NO. M602 UPSALA CO-OP TELEPHONE ASS'N UPSALA EXCHANGE
 DRAWN BY: RLK DATE: 7-8-02 SCALE: 1" = 1,200' MAP NO. 2 of 6
 FINLEY ENGINEERING COMPANY, SLAYTON, MN 56372 (507) 777-2099 FILE: UPSALAX

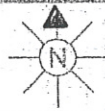

COUNTY	MORRISON	SEC.	4, 9	STAKED BY	FEC-JM	EXCHANGE	UPSALA	LEAD	A46
		TWP.	12.8N	DATE	3-12	STAKING SHEET AND PLANT RECORD			SHEET 1 OF 1
		RGE.	31W	REL.	REV.	PROJECT		MAP REF.	

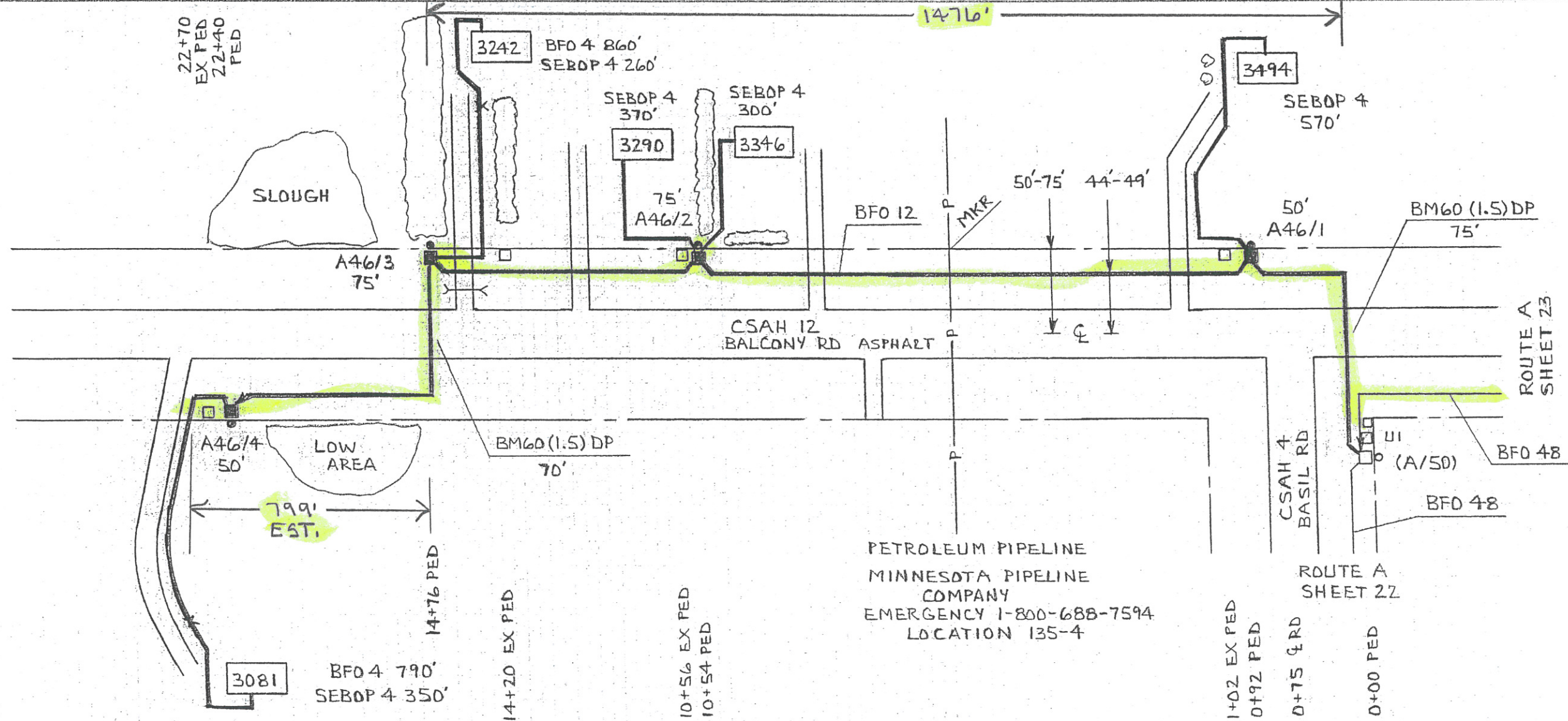

PED OR STA#	PED			POLE				MISC.				SPLICE				CABLE				MISC. NOTES
	BD	BA	BDD	23	6A	BM2 (5/8)	BM 53	BM60 (1.5)DP	BM 83	BM 99	H0-1	BFO 12	BFO 4	SEBOP 4	NID (FO)					
(A/50)																				
A46/1		1	1			1	70		1		1	238		570	1					
A46/2		1	1			1	1		1	1	2	1020		370		1				
						1			1					300		1				
A46/3		1	1			1			1		1	504				1				
						1			1				860	260		1				
A46/4		1	1			1	70		1		1	912				1				
						1			1				790	350		1				
TOTAL		4	4			9	1	140	5	1	5	2674	1650	1850		5				

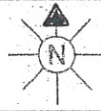
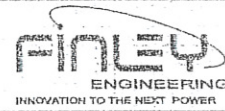

SEC. 9.10	STAKED BY FEC-JM	EXCHANGE UPSALA	LEAD A
TWP. 128N	DATE 3-12	STAKING SHEET AND PLANT RECORD	SHEET 23 OF 25
COUNTY MORRISON	RGE. 31W	REL.	REV.
PROJECT		MAP REF.	

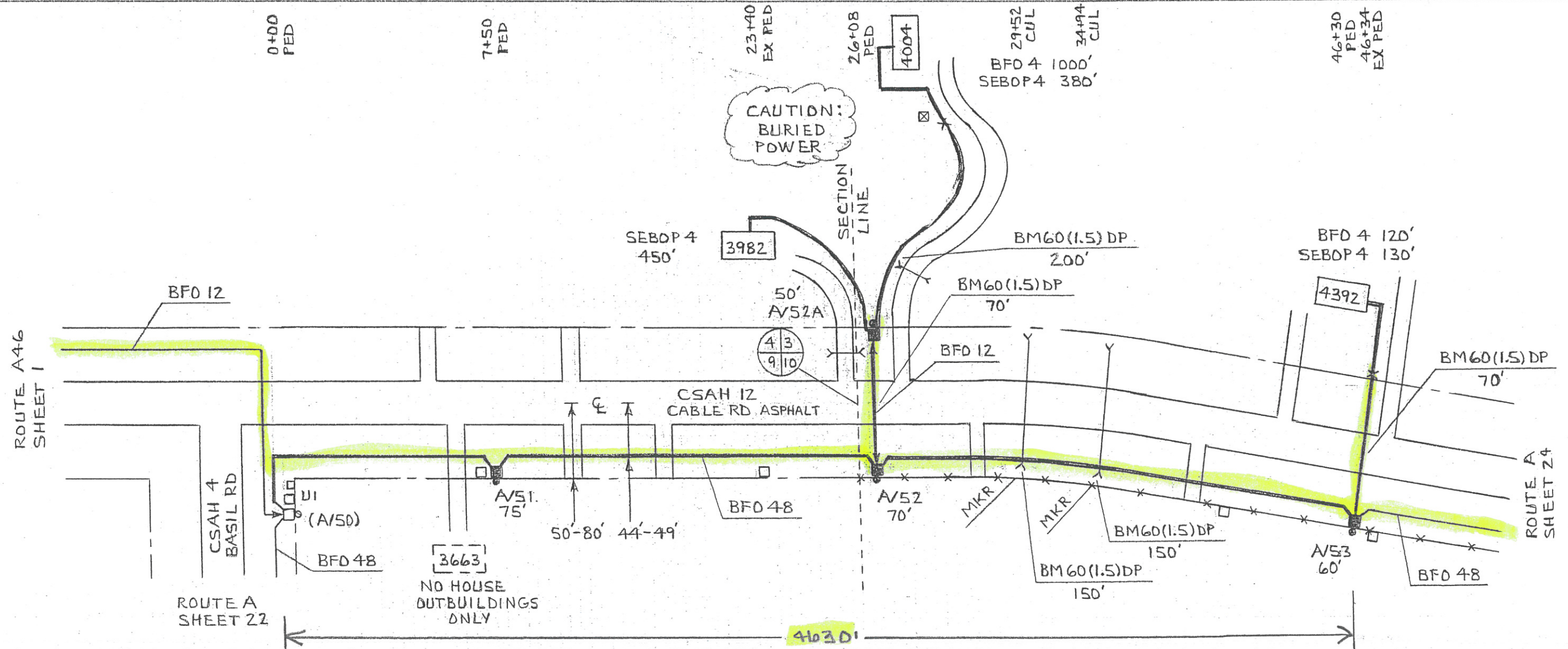

PED OR STA#	PED		POLE				MISC.				SPLICE		CABLE				MISC. NOTES
	BD	BA	BDO	BDO		BM2	BM	BM60	BM	HO-1	BFO	BFO	BFO	SEBDP	NID		
		23	8A	6A		(5/8)(8)	53	(1.5)DP	83		48	12	4	4	(FO)		
(A/50)																	
A/51		1		1		1					828						
A/52		1		1		1				2	1936						
A/52A		1		1		1		70		2		144					
						1		200	1			1000	450	1	3982		
						1		150	1				380	1	4004		
A/53		1		1		1	1	150		1	2084						
								70	1			120	130	1	4392		
TOTAL		4		4		6	2	640	3	5	4848	144	1120	960	3		

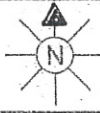
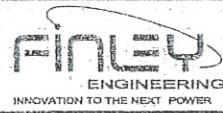

SEC. 10	STAKED BY FEC-JM	EXCHANGE UPSALA	LEAD A
TWP. 128N	DATE 3-12	STAKING SHEET AND PLANT RECORD	SHEET 24 OF 25
COUNTY MORRISON	RGE. 31W	REL.	REV.
PROJECT		MAP REF.	

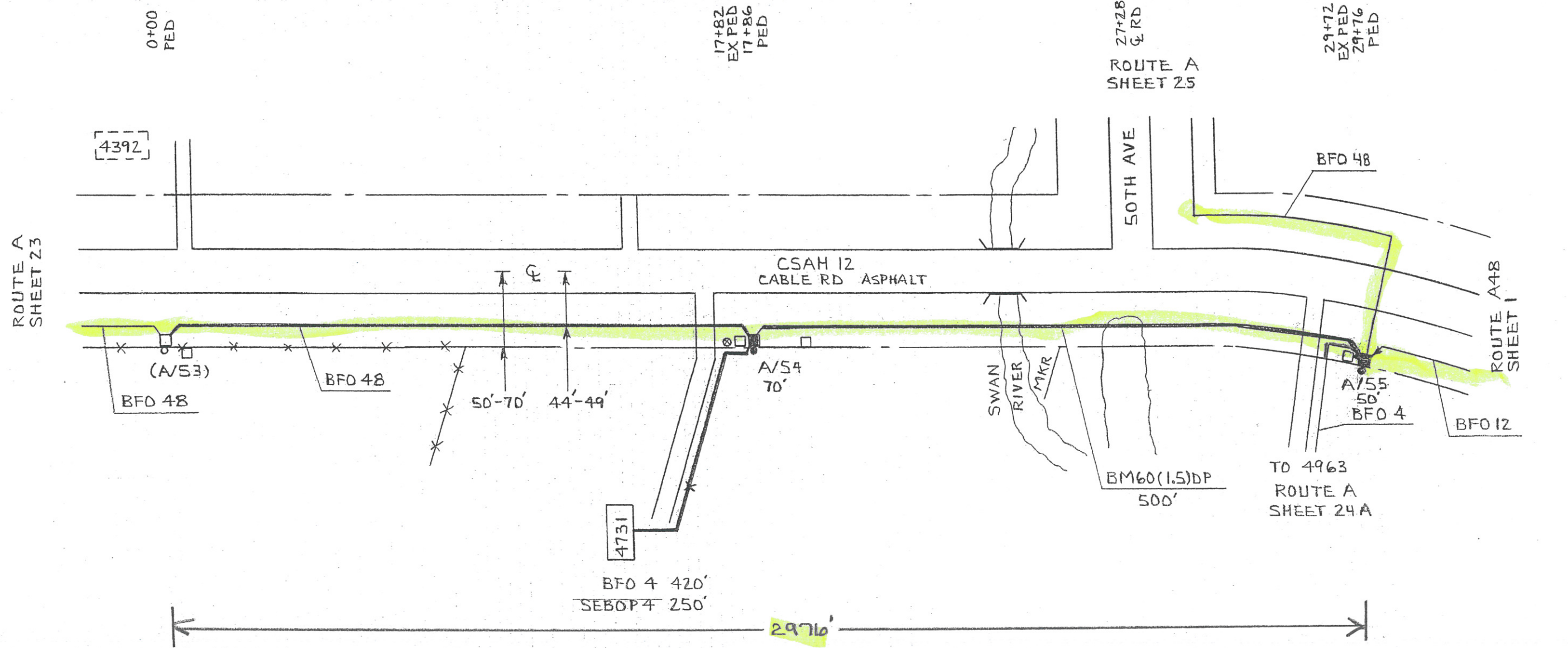

PED OR STA#	PED		POLE				MISC.				SPLICE				CABLE				MISC. NOTES	
	BD	BA	BDA	BDB		BMZ (5/8) 53	BM 53	BM60 (1.5)DP		BM 83		HO-1		BFO 48	BFO 4		SEBOP 4			NID (FO)
(A/53)																				
A/54		1		1		1				1		1		1842					1	4731
A/55		1	1			1	1	500				3		1240						
TOTAL		2	1	1		3	1	500		1		4		3082	420		250		1	

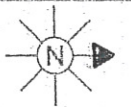

SEC. 2,3	STAKED BY FEC-JM	EXCHANGE UPSALA	LEAD A
TWP. 12BN	DATE 3-12	STAKING SHEET AND PLANT RECORD	SHEET 25 OF 25
COUNTY MORRISON	RGE. 31W	REL.	REV.
PROJECT		MAP REF.	

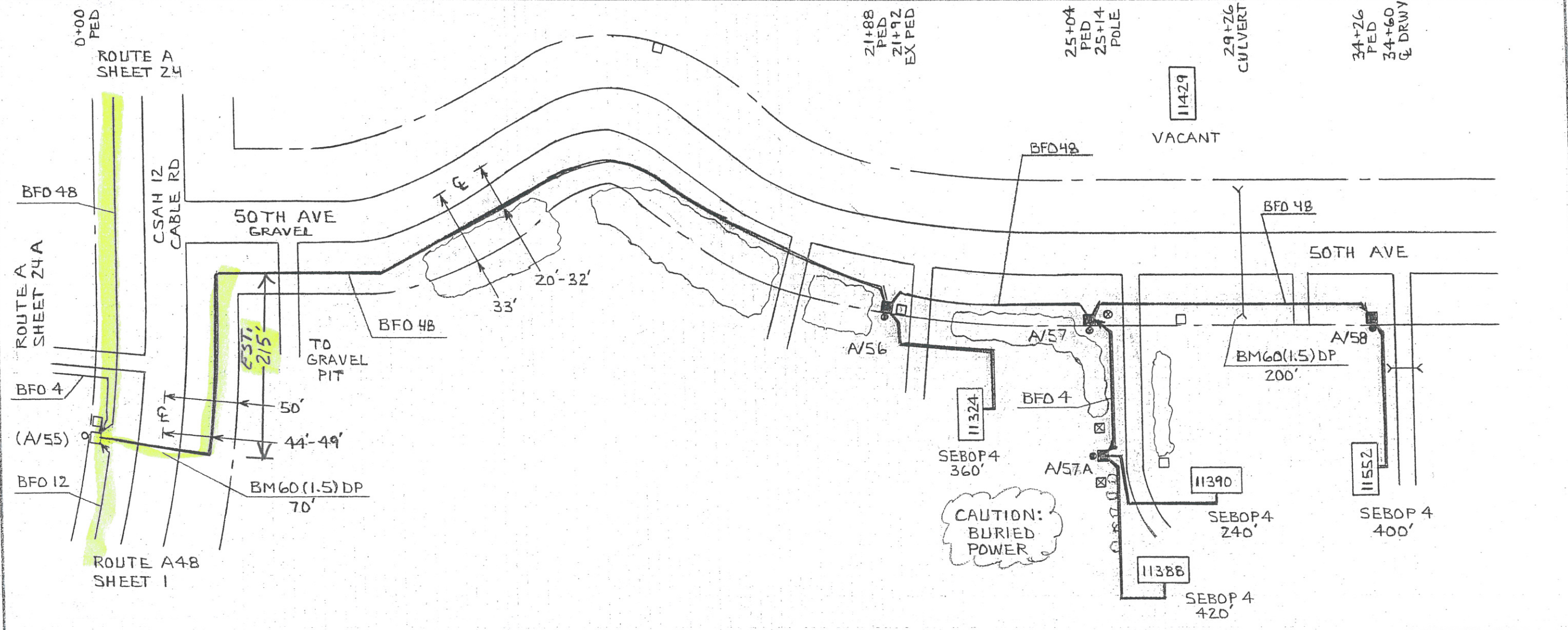

PED OR STA#	PED		POLE				MISC.			SPLICE			CABLE			MISC. NOTES
	BD	BA	BDO	BDO		BM2	BM60	BM	HO-1		BFO	BFO		SEBOP		
		23	8A	6A		(5/8X8)	(1.5) DP	83			48	4		4		(FO)
(A/55)																
A/56		1		1		1	70		1		2444			360		1 11324
A/57		1		1		1			2		356					
A/57A		1		1		1			2			780				1 11388
						1							420			1 11390
						1							240			
A/58		1		1		1	200		1		956			400		1 11552
TOTAL		4		4		7	270	4	6		3756	780		1420		4

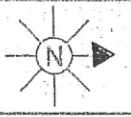
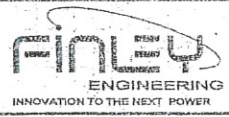

SEC. 1	STAKED BY FEC-JM	EXCHANGE UPSALA	LEAD A48
TWP. 128N	DATE 3-12	STAKING SHEET AND PLANT RECORD	SHEET 1 OF 1
COUNTY MORRISON	RGE. 31W	REL.	REV.
PROJECT		MAP REF.	

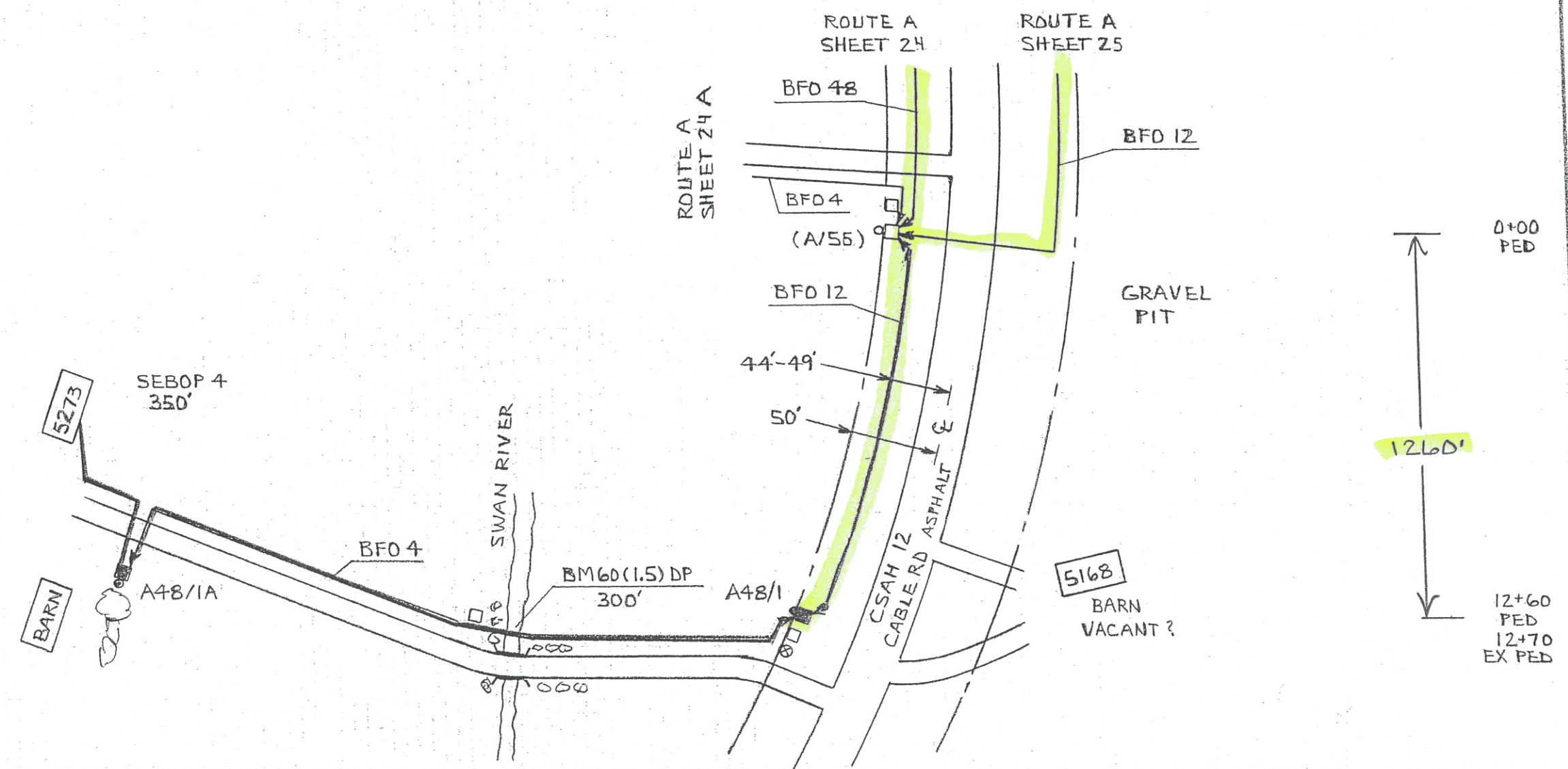

PED OR STA#	PED		POLE		MISC.			SPLICE		CABLE			NID (FO)	MISC. NOTES
	BD	BA	BDO	6A	BM2 (5/8)(8)	BM60 (1.5)DP	BM 83	HO-1	BFO 12	BFO 4	SEBOP 4			
(A/55)														
A48/1		1	1		1			1	1296					
A48/1A		1	1		1	300		1		1590		350	1	5273
TOTAL		2	2		3	300		2	1296	1590		350	1	