

GAS ASBUILT

13268 2963 9-27-13 3:00

W.O. #

13-SC-SW-81-SWS-5109

STREET ADDRESS

11661 30th Ave.

CITY/Twp

Mailing Address

T128, R31W, Sect. 5

CITY/Twp

White Flag 9-28-13

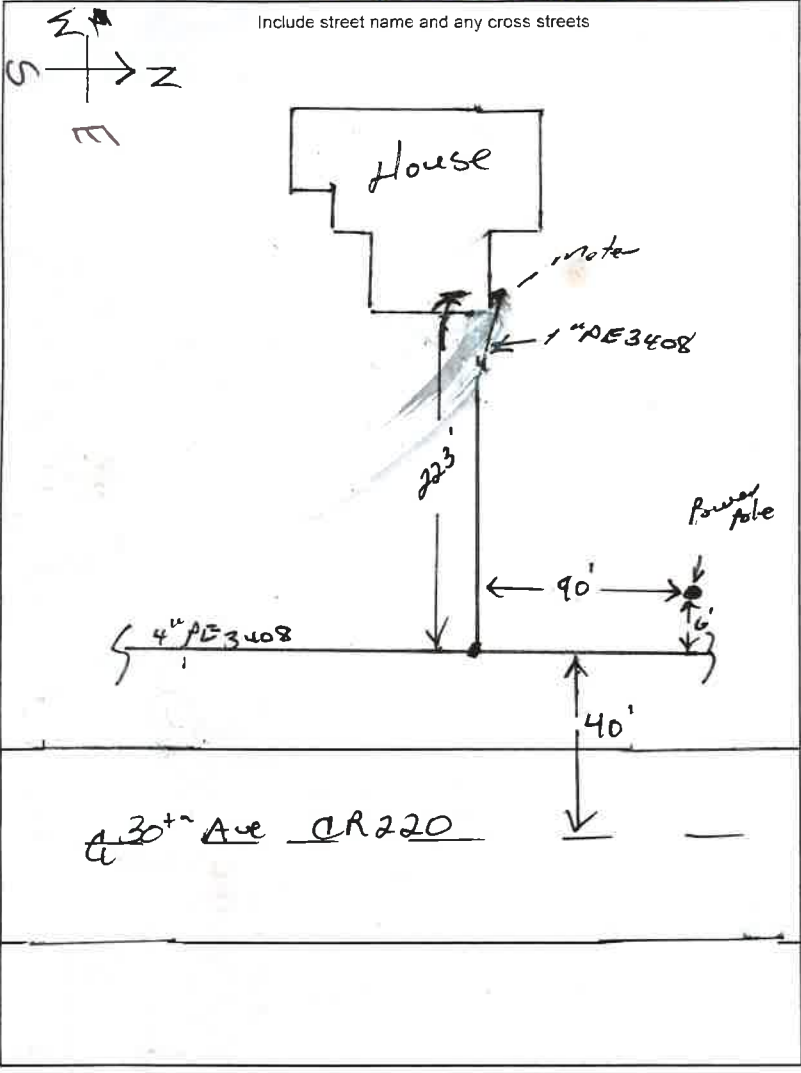

Pipe & Fitting Type  High D  Medium D

Material List	Lot #	Qty
Pipe 5/8" or 1"	NAD1640336A Feb 18	223
Tee 2x5/8 or 2x1		
Tee 4x5/8 or 4x1	298599	1
Tee 6x5/8 or 6x1		
EFV 5/8 or 1"	13171	1
5, 10 or 12 # Meter Bar		1
Cplg 5/8 or 3/4 or 2" 1	Bracket - post Foundtn.	1
Split Bolt	Riser 5/8 or 1"	1
5/8 or 1" ELL	Cap 5/8 or 1"	
PE Tee 5/8 or 1"	PE Reducer (4x1")	1
Scrap pipe		8'
Scrap wire		8'
wire		225
Carsonite	Anode 3#	
# of Heaters	Restoration	Y <input type="checkbox"/> N <input type="checkbox"/>

**Meter**

Locked  Unlocked

Size 275 Location Front

MFG Sensus Reading 0000

New Meter # 18032931

Reg. Type/Press.  5#  10#  12#

Old Meter# \_\_\_\_\_

Old Meter Reading: \_\_\_\_\_

Does Winter Construction Apply? Y  N

Remarks: \_\_\_\_\_

\_\_\_\_\_

\_\_\_\_\_

**Condition of Existing Pipe**

	Outside	Inside	Coating
Good	<input type="checkbox"/>	<input type="checkbox"/>	<input type="checkbox"/>
Fair	<input type="checkbox"/>	<input type="checkbox"/>	<input type="checkbox"/>
Bad	<input type="checkbox"/>	<input type="checkbox"/>	<input type="checkbox"/>

Anode # \_\_\_\_\_ MV Reading \_\_\_\_\_

**Existing Main**

Size 4 Pressure \_\_\_\_\_ Type/Mfr 3408 Dura Line

Lot # \_\_\_\_\_ Cover 36" Location 40' W of

**New Service / Main**

Size 1" Lot # NAD 1640336A Feb 18

Poly Mfr Dura Line Nature of Soil Clay, Gravel

Tap Size 1/2 Cover 36" Completion Date 9/27/13

Foreman ID T. Schwaner Welder/Fuser ID T. Schwaner

**Pressure Test**

Test With: Air / Nitrogen Duration 15 min Emp ID T. Schwaner

Date Tested 9/27/13 PSI 150 Soap Test Final Tie-in? Y  N

Filled out by Mapping Dept.

Mapped in System Maps \_\_\_\_\_ Date \_\_\_\_\_

Mapped in GIS \_\_\_\_\_ Date \_\_\_\_\_

Entry Person \_\_\_\_\_ Date \_\_\_\_\_

GSOC Polygon Available Yes  No

Description	Install Footage
Directional Bore	
Pneumatic Bore	
Backhoe	10
Inserting	
Trench	
Plow	205
Hand Digging	8
Joint Trench	
Gopher Pipe	
Cust. Perf. Loc.	

Permit Required  Y  N sent final as built to MONTICORN CO.

updated 8/12/2018