

2013 PROPOSED FIBER LEGEND

	BFO 96	TYPE OF CABLE (FIBER) AND SIZE
	PROPOSED FIBER	
	PROPOSED FIBER DROP	
	PROPOSED FIBER PED	
	PROPOSED FACILITY CHANGE	
	EXISTING FIBER PED	

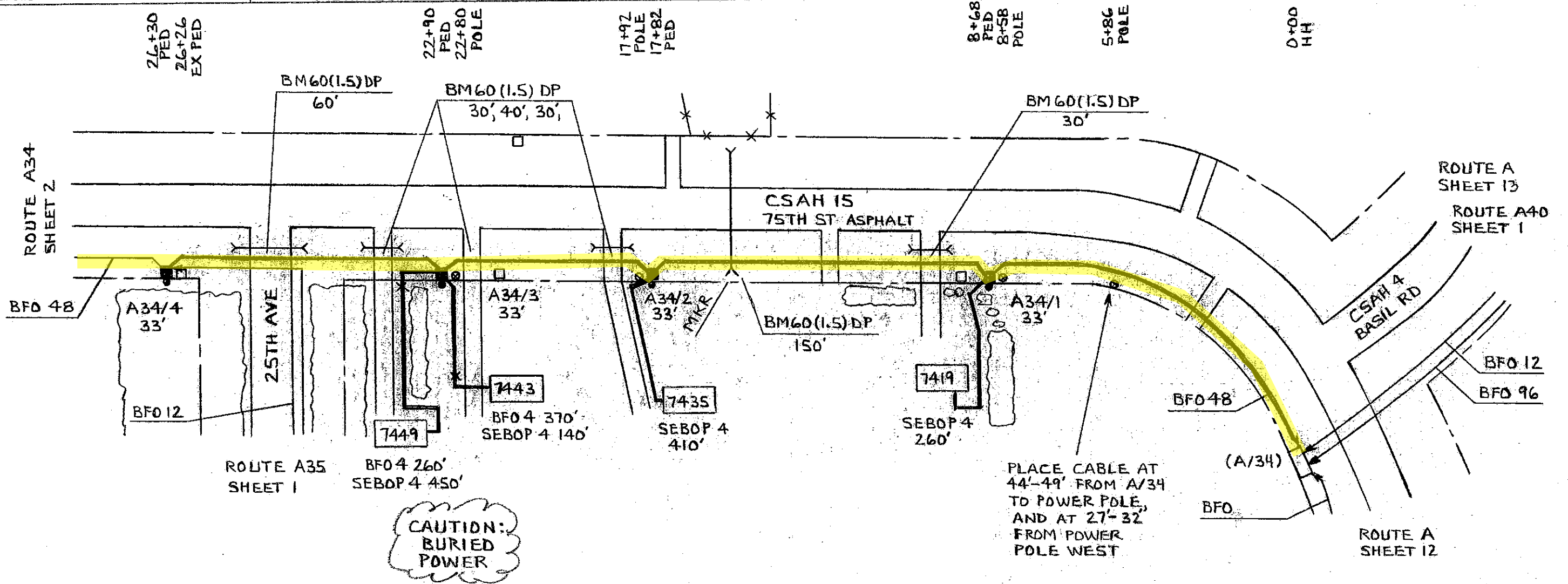

PED OR STA#	PED			POLE				MISC.				SPLICE		CABLE				MISC. NOTES
	BD	BA 23	BDD 8A	BDD 6A		BM2 (8X8)	BM 53	BM60 (1.5) DP		BM 83	HD-1	W/ HDFO	BFO 48	BFO 4		SEBOP 4	NID (FO)	
(A/34)											55	1						
A34/1		1		1		1			1		1		972			260	1 7419	
A34/2		1		1		1	1	150	1		1		946			410	1 7435	
A34/3		1		1		1		30	1		2		540			140	1 7443	
						1		40	1					370		450	1 7449	
						1		30	1					260				
A34/4		1	1			1		60			3		372					
TOTAL		4	1	3		6	1	340	4		62	1	2830	630		1260	4	

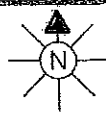
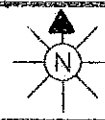

26+30 POLE
26+20 PED

19+30 POLE

11+52 CULVERT

2+58 FE

0+00 PED

ROUTE A34
SHEET 3

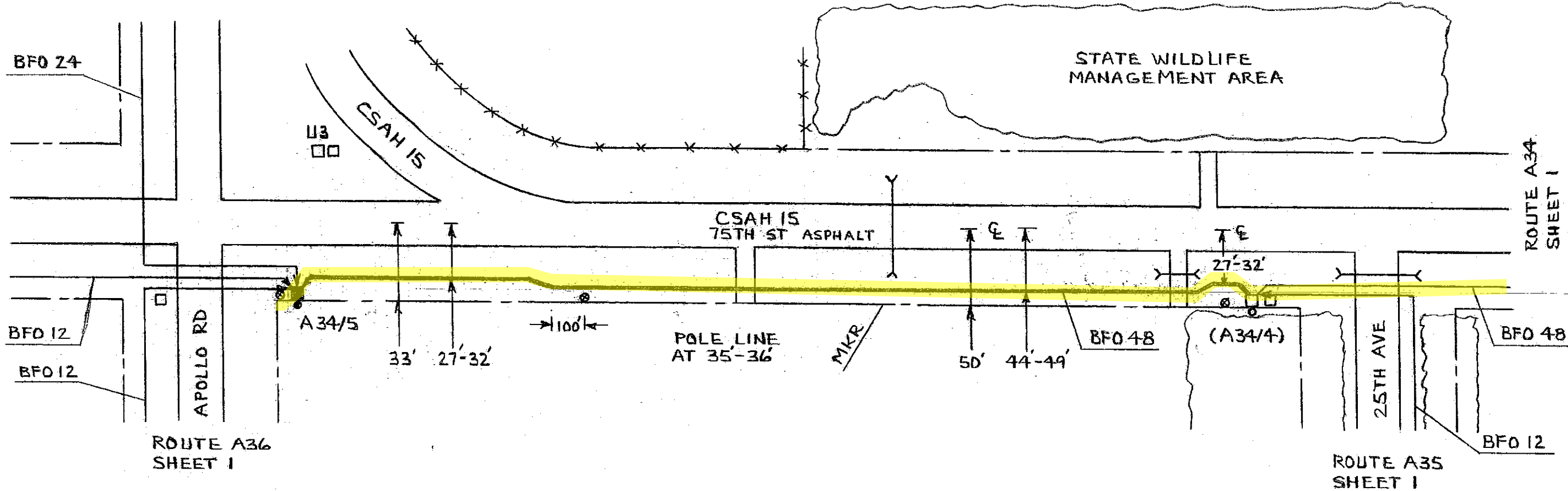

PED OR STA#	PED		POLE		MISC.						SPLICE			CABLE						MISC. NOTES	
	BD	BA	BDO	BA	BM2 (5/8)	BM	53					HO-1			BFO	48					
(A34/4)																					
A34/5		1		1		1	1					42			2698						
TOTAL		1		1		1	1					42			2698						

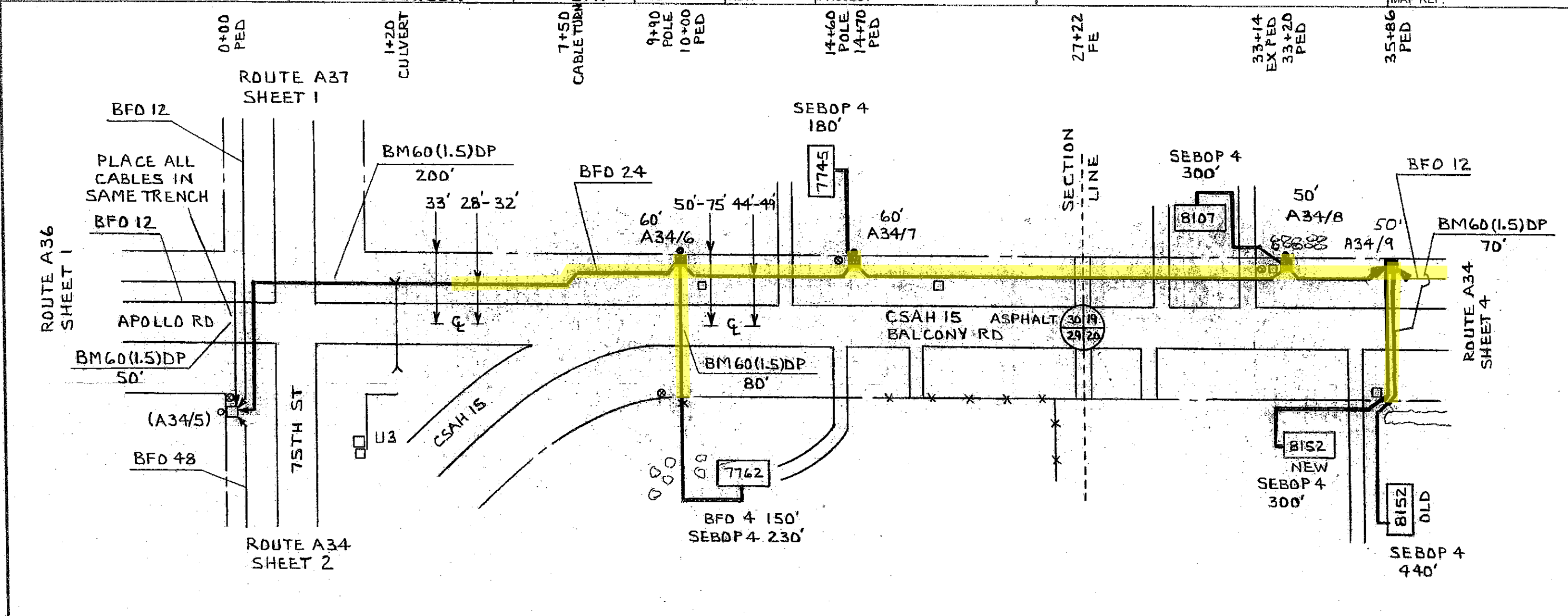
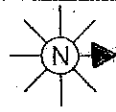

PED OR STA#	PED		POLE			MISC.			SPLICE			CABLE			MISC. NOTES
	BD	BA	BDD	BM2	BM60	BM	HO-1	BFD	BFO	SEBOP	NID				
(A34 5)		23	6A	(5/8)(8)	(1.5)DP	83		24	4	4	(FO)				
A34/6		1	1	1	50 200 80	1	1	1126		230	1	7762			
A34/7		1	1	1		1	1	522		180	1	7745			
A34/8		1	1	1		1	1	1892		300	1	8107			
A34/9		1	1	1	70	1	2	288		300 440	1	8152 NEW 8152 OLD			
TOTAL		4	4	9	400	5	5	3828	150	1450	5				

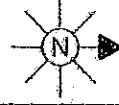

COUNTY MORRISON

SEC. 19 STAKED BY FEC-JM
TWP. 128N DATE 2-12
RGE. 31W REL. REV. PROJECT

EXCHANGE UPSALA
STAKING SHEET AND PLANT RECORD

LEAD A34
SHEET 4 OF 6
MAP REF.

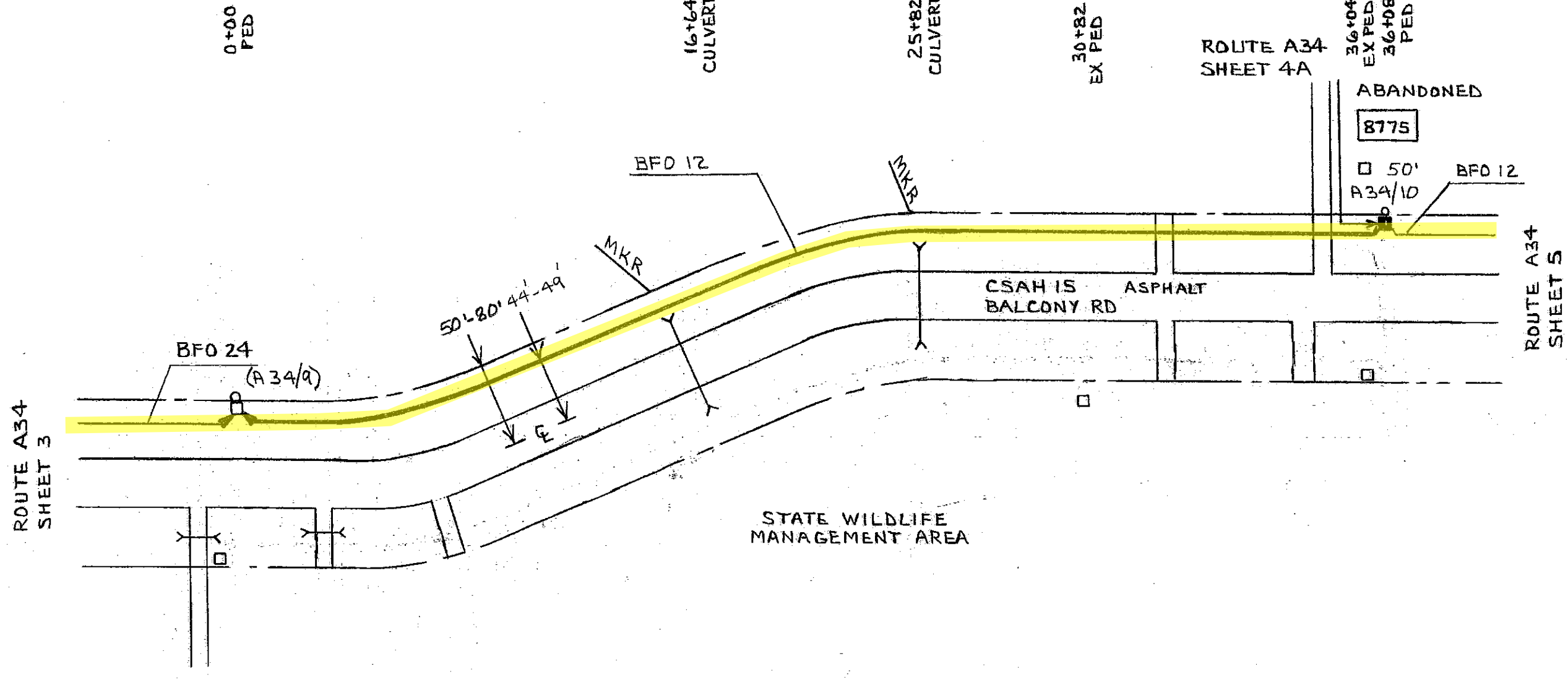

PED OR STA#	PED		POLE		MISC.						SPLICE			CABLE						MISC. NOTES
	BD	BA	BDO			BM2	BM					HO-1			BFO					
(A34/9)		23	6A			5/8	53								12					
A34/10		1	1			1	1					2			3642					
TOTAL		1	1			1	2					2			3642					

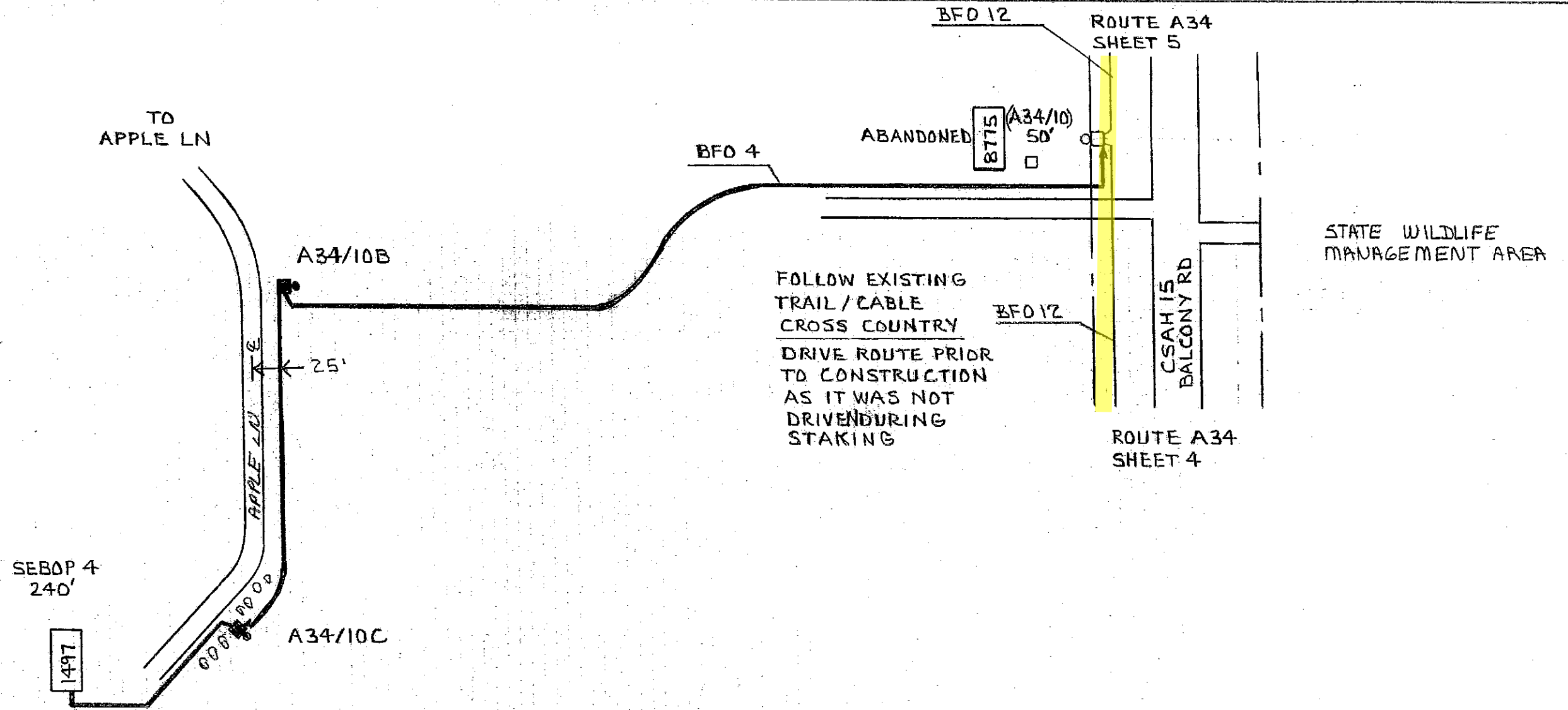
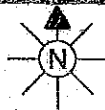

PED OR STA#	PED POLE			MISC.					SPLICE				CABLE				MISC. NOTES				
	BD	BA	BDO																		
	23	6A			BM2 (4)(8)	BM60 (1.5)DP		BM 83		HD-1				BFO 12	BFO 4		SEBOP 4		NID (FO)		
(A34/10)																					
A34/10B		1	1		1										3500						
A34/10C		1	1		1			1		1				1450			240		1	1497	
TOTAL		2	2		3			1		1				4950			240		1		

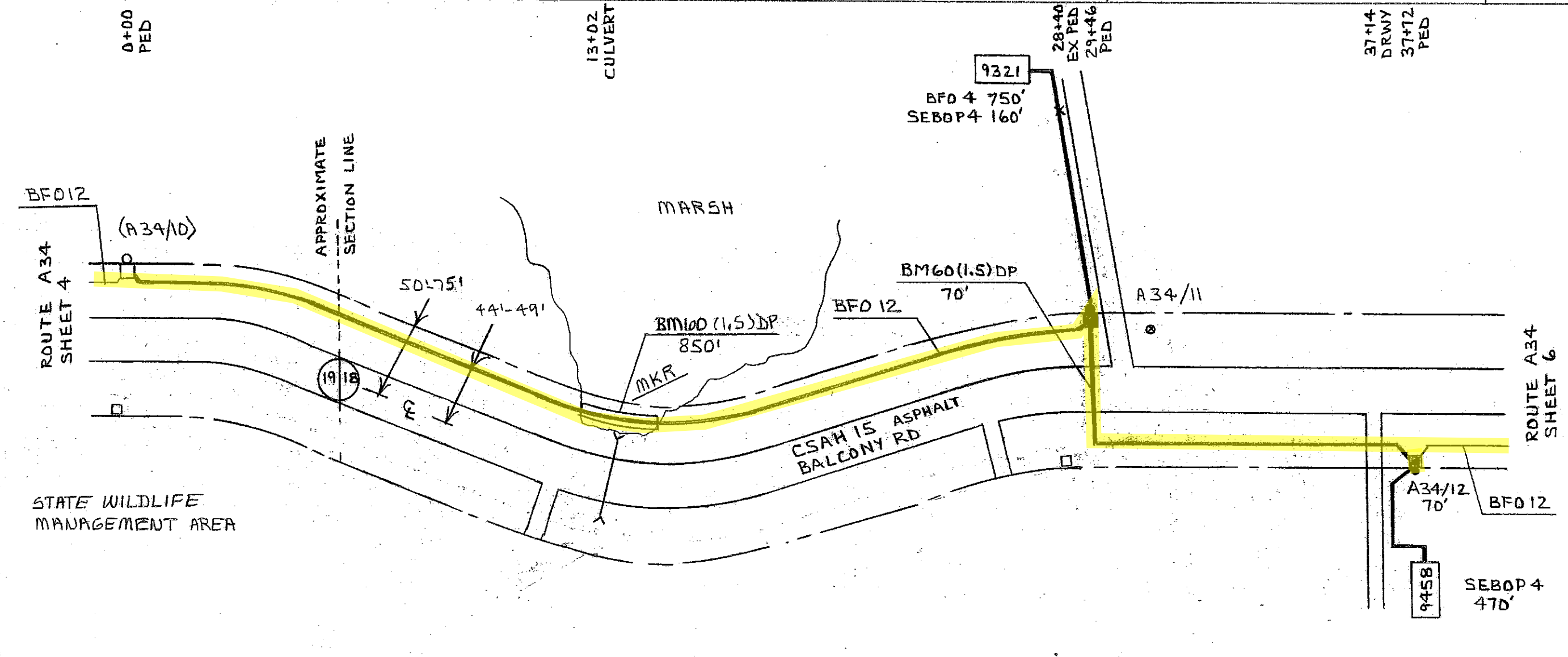
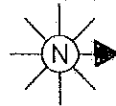

PED OR STA#	PED		MISC.							SPLICE			CABLE				MISC. NOTES
	BD	POLE	BA	BDO	BM2	BM	BM60	BM	HD-1	BFO	BFO	SEBOP	NID				
(A34/10)			23	6A	(5)(8)	53	(1.5)DP	83					(FO)				
A34/11			1	1	1	1			1	2898							
						850		1			750		1	9321			
A34/12			1	1	1				1	998							
					1			1			470		1	9458			
						70											
TOTAL			2	2	3	1	920	2	2	3896	750		630	2			

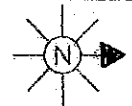

COUNTY MORRISON

SEC. 18 STAKED BY FEC-JM
 TWP. 128N DATE 2-12
 RGE. 31W REL. REV. PROJECT

EXCHANGE UPSALA
 STAKING SHEET AND PLANT RECORD

LEAD A34
 SHEET 6 OF 6
 MAP REF.

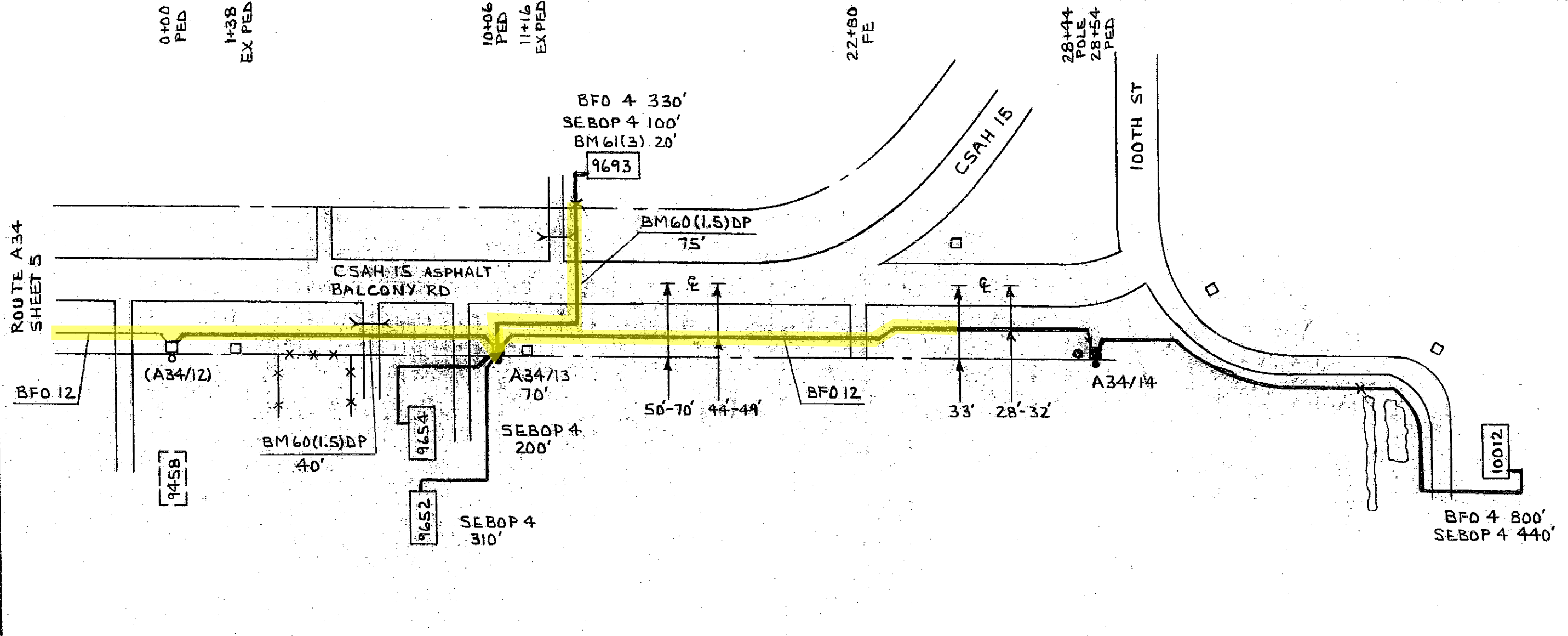

PED OR STA#	PED		POLE		MISC.				SPLICE				CABLE				MISC. NOTES
	BD	BA	BD0	6A	BM2 (5/8)X8	BM60 (1.5)DP	BM61 (3)	BM 83	H0-1	BFO 12	BFO 4	SEBOP 4	NID (FD)				
(A34/12)																	
A34/13		1	1		1	40			3	1078							
					1			1			310	1	9652				
					1	75	20	1			200	1	9654				
										330	100	1	9693				
A34/14		1	1		1				1	1922							
											800	440	1	10012			
TOTAL		2	2		4	115	20	4	4	3000	1130	1050	4				

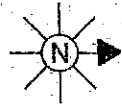

SEC. 28	STAKED BY FEC-JM	EXCHANGE UPSALA	LEAD A40
TWP. 12BN	DATE 2-12	STAKING SHEET AND PLANT RECORD	SHEET 1 OF 2
COUNTY MORRISON	RGE. 31W	PROJECT	MAP REF.

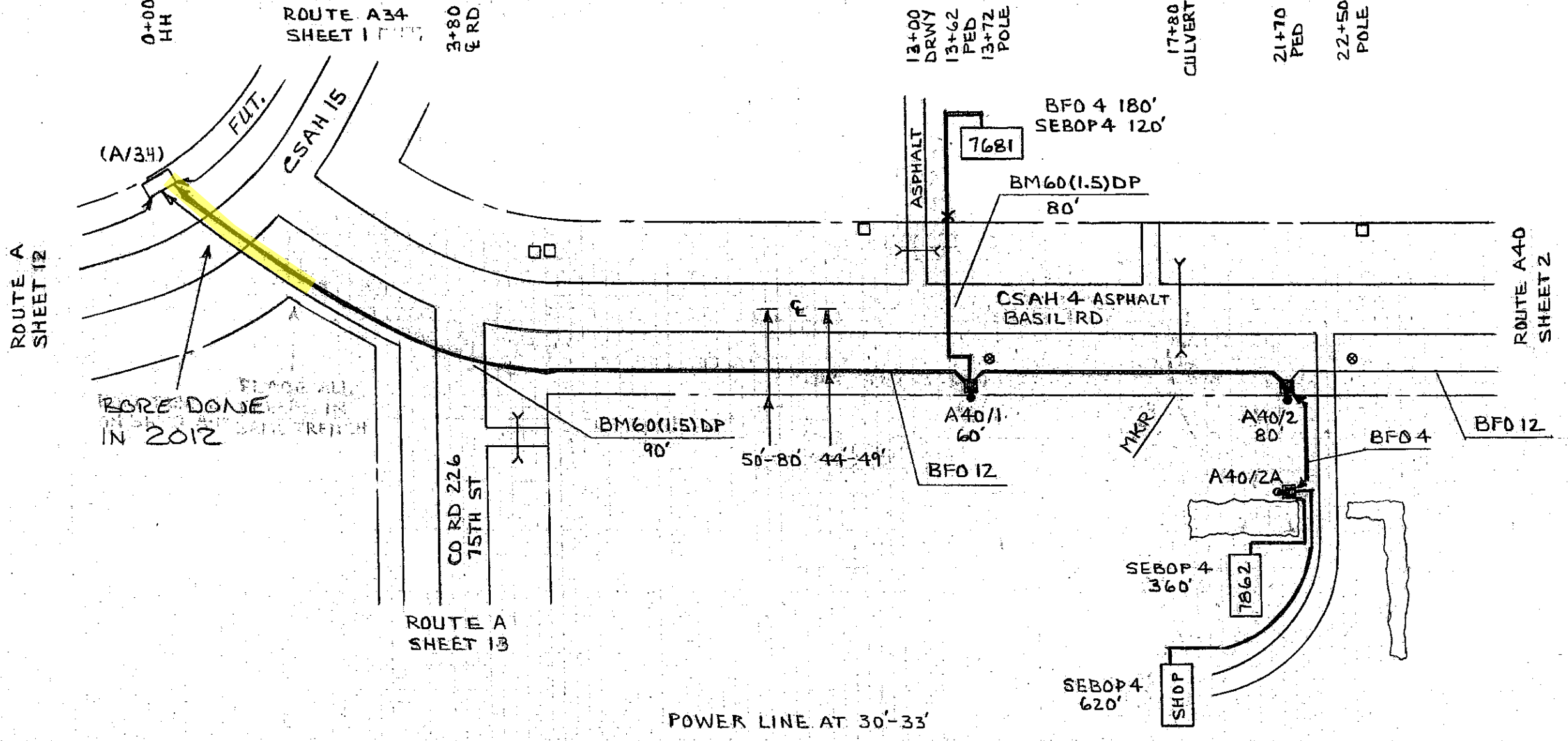

PED OR STA#	PED		POLE			MISC.				SPLICE		CABLE				MISC. NOTES	
	BD	BA	BDO	BDO		BM2	BM	BM60		BM		BFO	BFO		SEBOP		
(A/34)		23	8A	6A		(5/8)8	S3	(1.5)DP		B3		12	4		4		(FO)
A40/1		1		1		1		90			1	1458					1
						1		80		1			180		120		7681
A40/2		1		1		1	1				2	880					
A40/2A		1		1		1				1	2		590				
						1				1				360			1
						1				1				620			1
TOTAL		3		3		6	1	170		3	5	2338	770		1100		3