

Customer Ready Date 8-7-13 Minnesota Energy Resources Field Site Visit: Service Card Main Card WR: 1254018

Customer Name Lumber One
 Address 21188 Grouse Rd
 Cross Street State Hwy 115
 City Camp Ripley Within City Limits? No

Related WR: _____
 Premise #: 10714746
 Contact Number: Rick 980-48038
+1 (320) 356-7342
 County MORRISON

Main Size: 4 *PSI: 115 Material: Steel
 CP: _____
 * If Service PSI is greater than 60#, please refer to Engineering

Taxing District 2565
 Job Type: GS Type of Service: Residential
 Location: Short Side

Svc Requires Main?
 Additional Information / Special Instructions / Contacts / Directions / Notes:

Run new service to new home meter on south need welder see drawing for rest of specs.

- Permits Required**
 (Check all that apply)
- Township
 - City
 - County
 - MnDOT
 - Environmental?
- Please refer to EPREP for more information.

Pipe Install: Material: Pe & steel
 Quantity (ft): 125 & 25 Size (in): 1/2 & 3/4

Retire: CWS Xtrube Copper
 Add. Bellhole BS MDPE Aldyl-A
 Quantity (ft): _____ Size (in): _____

Check All That Apply: Meter Remove Mtr Bar Remove
 Regulator EFV Meter Bracket Reg Ice Shield
 Barricade Riser Meter Bar Mtr Ice Shield

Meter Set needed? yes Multiple Meters? NO
 Size: DOM PSI: 2 Quantity 0

Excavation (sq ft unless otherwise stated)		Restoration (sq ft unless otherwise stated)	
Dir. Bore (lin ft):	Conv. Bore (lin ft):	Sod:	BD&S: <u>125'</u>
Concrete:	Blacktop:	Gravel (cu yds):	Sand:
Sawing (lin ft):		C&G (lin ft):	Tamping:
Rock Peel (cu yd):	Rock Haul (cu yd):	Concrete:	Blacktop:

Customer UG Facilities? NOT AT THIS TIME Type of UG Facilities: NONE AT THIS TIME
 Excess Footage: _____ P/L to Meter: _____ Estimate: _____

**Need gopher guard.*

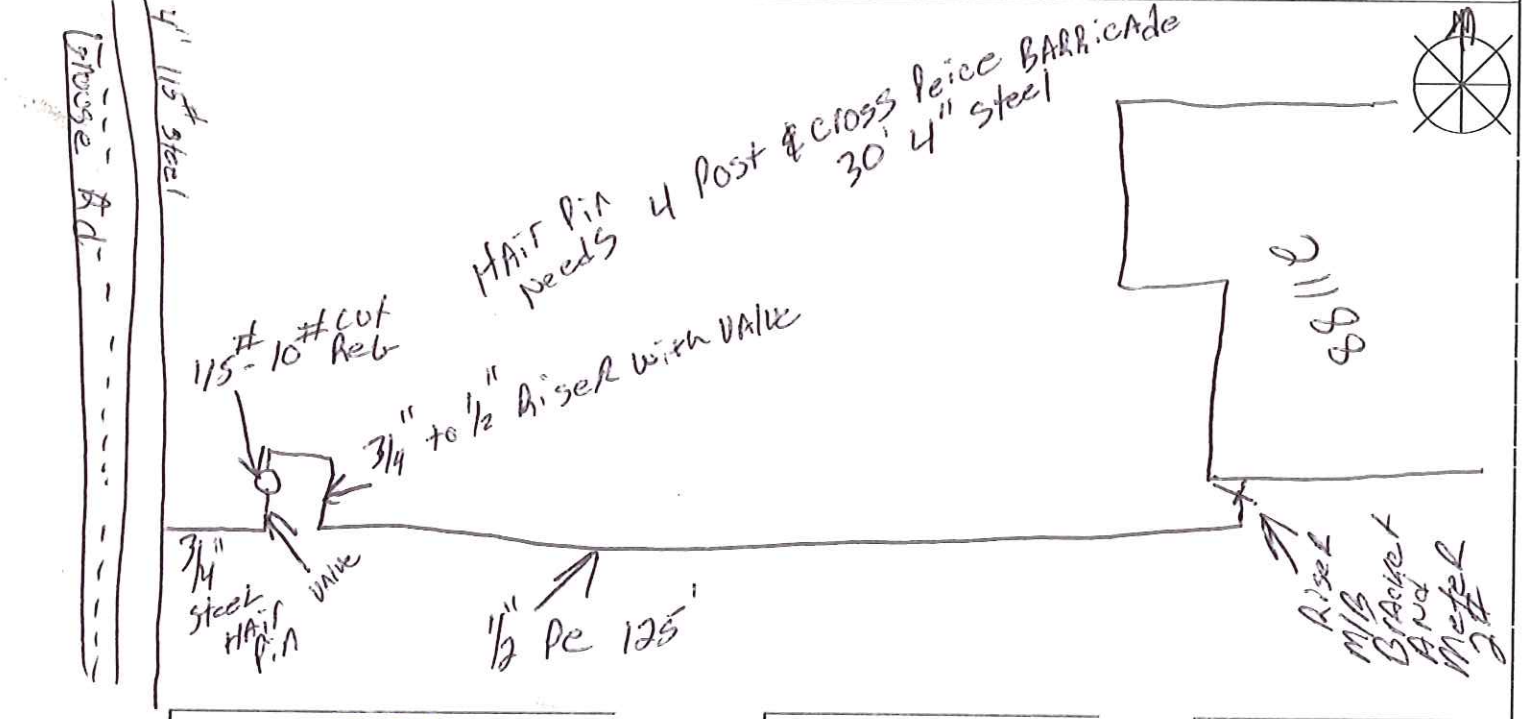

Technician Name: Alan Braith Telephone: +1 (320) 980-7954 Date: 8/5/13