

0+00 0+08 0+32 1+64 1+94 2+94 3+38 5+26 5+80 7+08 8+34 8+64 8+70

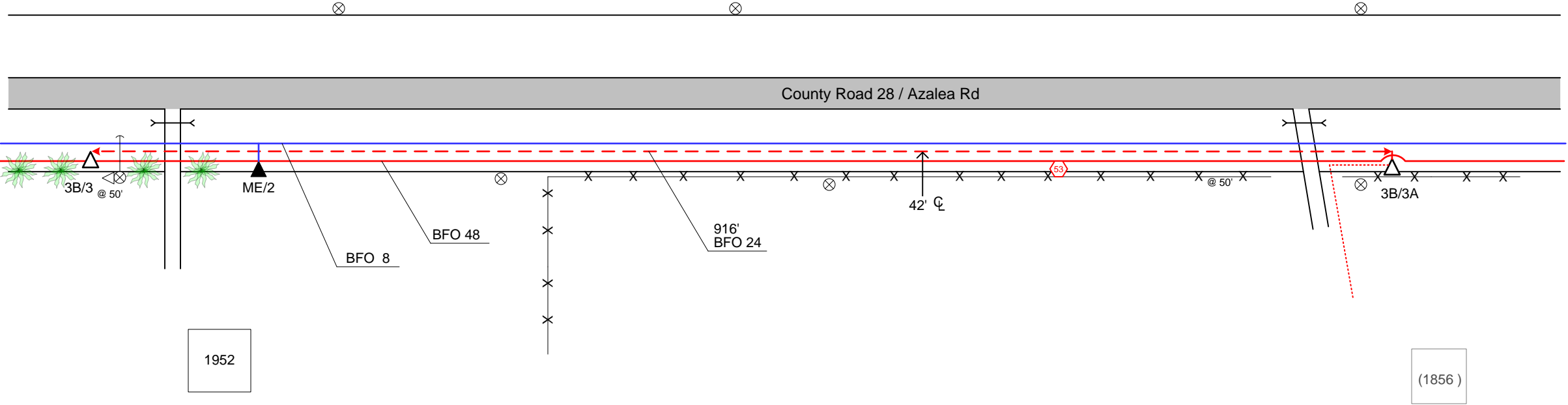

From	To	PType	Units	Feet	BM	HO	W	Remarks
	3B/3					1	1	BDO 4(SG) 1
3B/3	3B/3A	BDO4(SG)	BFO 24	916	2(5/8)(8)	1	1	
	3B/3A				53	1		

As Staked
Consolidated Telephone Company
 Name: 2013-3B-3A Ped-1856 Azalea
 WO: 2013 - Motley
 Exch: Motley
 Route: 3B
 ROW: Private
 State: Minnesota
 County: Morrison
 Range: 31W
 Twsp: 133N Section: 19
 Township: _____
 Staked By: CLP Date: 10/8/13
 Revised By: _____ Date: _____
 Revised By: _____ Date: _____
 Revised By: _____ Date: _____
 As-Built By: _____ Date: _____