

Gopher State **Tailgate Session** **W/O#:** **256670** **WP#:** **WP#:**

#: **Switching Orders** **Source Determined** **Sec: 1,2,11,12** **New Const**

Time OK: **PPE Needed** **Potential Hazards** **Twp: 39N** **Sys Imp**

Date OK: **Trees** **Weather** **Poles** **Ins.** **Rg: 31W** **Ret (RWR)**

List: **Terrain** **Public** **Barracading** **Signed By:**

Power Equip. Needed **Personal Tools** **Staked By:** **Luke Kasella**

Sec./Fusing **Supervisor** **Elec:** **AFF #:**

Update: **Date:** **Comments:** **RFCd:** **By:**

Wire Size	Pole	OH Assy	Grnd.	Guy E	Lead	Anchor F	Trans G	Light M26-5	Ang.	J Box	Mod	EI-bow	Cap	Spl-ice	Pri. Riser	Sec. Span	Sec. Wire	Unit	CWP Ped/Loop	Misc Assy
CSS-PH RR-Neu	40-4	C8-3	M2-1	E6-2	25	F1-3S			1°											
				(2)E3-10	30	F1-3S														
				E6-2	25	F1-3S														
				(2)E3-10	30	F1-3S														
				E5-2																
				E5-2																
				E6-2	25	F1-3S														
				(2)E3-10	30	F1-3S														

EXISTING 10 NEUTRAL CONDUCTOR CAN BE USED

INSTALL VIBRATION DAMPERS ON EVERY OTHER POLE

Service Address (Line Crew Adds)

Row 1: **WIRE FEET** **Wire/Cables/Ser Size** **# Wires** **C**

Row 2: **32247** **1/0 ACSR** **3** **10749**

Row 3: **32247** **4/0 ACSR** **3** **10749**

Permit Section:

Rd Permit

Cty Permit

Twp Permit

State Permit

DNR Permit

Joint Trench

Notify TWP

Temp. Set: **By:** **Comp.:**

Final Grade Comments:

Grushing Comments:

Trees Comments:

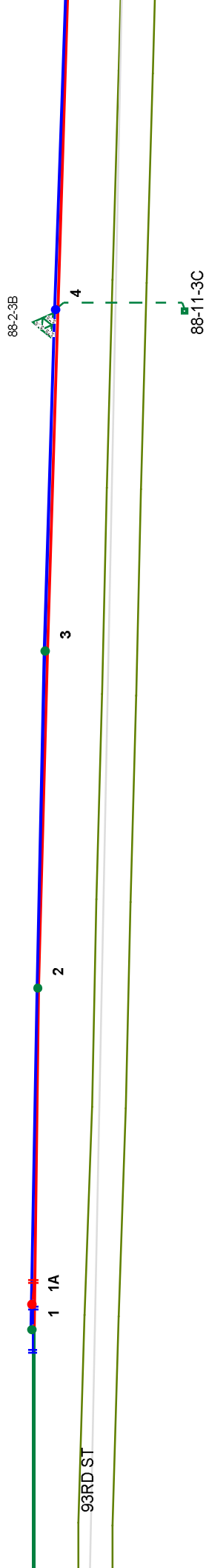
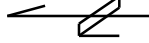

1 1A

2

3

4

88-2-9B

88-11-3C

93RD ST



9148

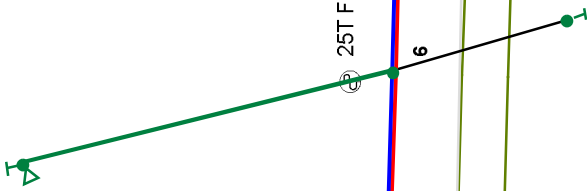

25T FUSE

6

7

8

9 T

RULING SPAN 287'

24' CLEARANCE

10

10

#23499

25T FUSE

House

88-11-18

M9443



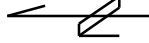

88-2-3

House

#23682

11

12

13

14

15

16

AX6166 VI



17

18

19

20

21

22

PT 1--5916' TO PT 37



1400' U.S.E. TO
88-12-200

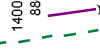

Ret:

Both:

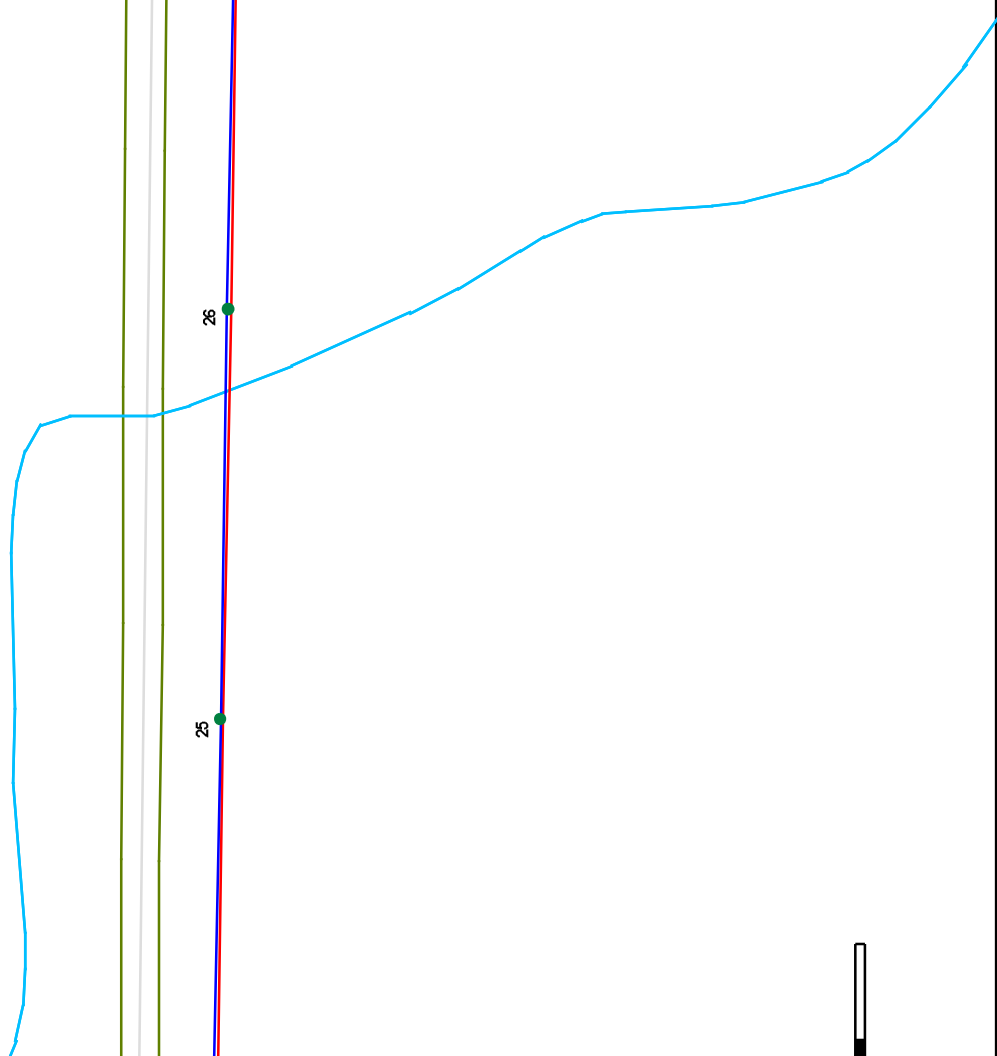
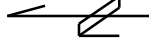

25

26

27

28

29

RULING SPAN 297'

#24501

88-12-20H



P9681



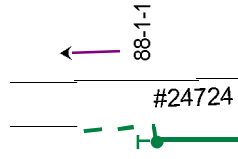
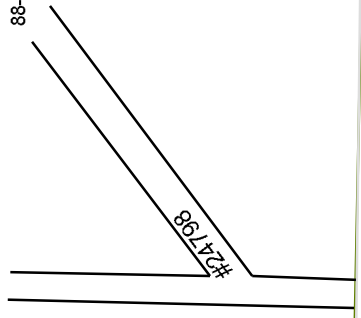

20' CLEARANCE
25T FUSE

19' CLEARANCE
25T FUSE

31

32

RETIRE A5-2 ADD A7
TO INCREASE CLEARANCE

33

34

