

Natural Gas Construction
Property Site Sketch and Liability Waiver



Customer Name: Kevin Waldo Work Request # 1596223
Service Address: 20376 Grouse Road City, State, Zip Little Falls MN 56345
Daytime Phone 320 630 1981

Location Of Customer-Owned Facilities

All above ground and underground facilities must be clearly identified on your Property Site Sketch below.

Customer is required to indicate all that apply on the Property Site Sketch — see Included EXAMPLE on Page 2.

- | | | | |
|--|---|--|--|
| • Desired gas meter locations with footages from nearest corner of the building (Indicate with G). | • Wells and private water lines including underground sprinkler systems with connecting lines to buildings. | • Municipal sewer/water laterals | • LP fuel lines/tanks with connecting lines to buildings |
| • External wood furnaces and associated buried heating lines | • Drain tile/buried down spout and sump pump lines | • Septic systems/drain fields with connecting lines to buildings | • Electric Meter |
| • Geothermal heat pumps with connecting lines to buildings | • Planned or potential deck, patio, swimming pools or outbuildings | • Air conditioning units and all fresh air intakes | • Invisible Fences |
| | | • Existing and future landscaping features IE : Landscape berms or retaining walls | • Private underground wiring |
| | | | • Private cable/satellite TV Lines |
| | | | • Other |

If no existing or future proposed private facilities on the property check here ☐

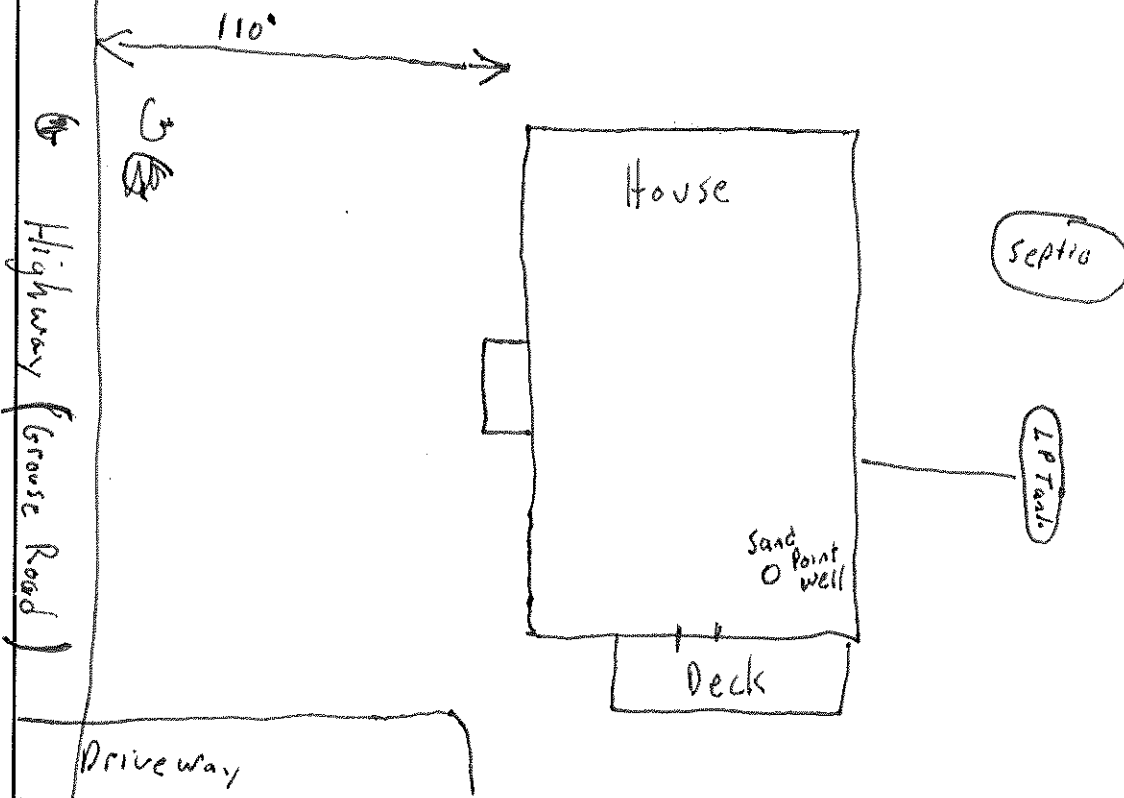

At the time of construction, all existing or proposed private underground facilities must be marked or exposed before service can be installed.

Construction Authorization / Underground Damage Liability Waiver:

I certify that I own or am the authorized representative of the owner of the property of the service address indicated on this Property Site sketch, and that I have read and understood the above statement regarding marking and / or exposing all private underground facilities. I furthermore agree to hold Minnesota Energy Resources and/or its agents harmless for any damage to private underground facilities that occurs during the installation of natural gas service as a result of failure on my part to ensure that the private underground facilities on this property have been adequately marked and / or exposed.

Signature: Kevin Waldo Date: 7/2/2014