

COVERSHEET

	RUS Code:	W/O #:	370417
	EXT 740 C:	WP #:	
	Loan Nbr: BA8	LOC #:	88-000-02-00203
	Loan Ywr: 2014	Name:	ROBERT LEIDENFROST
	AFF #:	(H) Phone #:	4682465
17330 MN-371 Brainerd, MN 56401 (218) - 829 - 2827	Elec:	(W) Phone #:	
	RFCd:	(C) Phone #:	
	By:	Acct #:	

City:	Staked By: LUKE M KASELLA
Sec: 2	Date: 6/10/2016 12:00:00AM
Twp: 39	Signed By: RICK L PEDERSON
Rg: 31	Date: 04/14/2016

Tailgate Session	
Job Steps:	Work Procedures:
PPE Needed:	Job Hazards:
Source Control Verified/Size:	Equipment Needed:
Personal Tools:	1-Shot/K-Fuse Size:
Crew:	Date:
Comments:	

Gopher State	
Locate #:	Date OK:

Comments 1:
Comments 2:
Comments 3:

Septic:	Row 1:	Rd Permit:	✓
Priv Elec:	Row 2:	Cty Permit:	
LP Line:	Line Ext \$ 3,330.00 Bore/Push \$ 1,035.00 Permit \$ 40.00 Ped/Loop \$ 500.00 Total \$ 4905.00	Fees:	✓
Sprinkler:	Backfill Comments:	TWP Permit:	
Final Grade:		State Permit:	
Brushing:		DNR Permit:	
Trees:		Joint Trench:	
Easements:		Notify TWP:	

Reel ID:	Start Ftg:	End Ftg:
Reel ID:	Start Ftg:	End Ftg:
Reel ID:	Start Ftg:	End Ftg:

CONDUCTOR SUMMARY			
STATUS	CONDUCTOR	TYPE	QTY (FT)
INSTALL	1/0 15KV JAC 220 MIL	PRIMARY	425
	UG-MODEL	SECONDARY	150
INSTALL	2 INNERDUCT	SECONDARY	425
INSTALL	4/0 USE	SECONDARY	10



Staked By:	LUKE M KASELLA	RUS Code:	W/O #:	370417	
Date:	6/10/2016 12:00:00A	EXT 740 C:	LOC #:	88-000-02-00203	
Signed By:	RICK L PEDERSON	Loan Nbr:	BA8	Name:	ROBERT LEIDENFROST
Date:		Loan Ywr:	2014	Acct #:	
Warehouse:					

ASSEMBLY UNIT SUMMARY

ASSEMBLY NAME	DESCRIPTION	INSTALLED	RETIRED
1/0 15KV JAC 220 MIL	CABLE, 15KV 1/0 SOLID (JACKET) 220 MIL	425	-
2 INNERDUCT	2 INNERDUCT	425	-
4/0 USE	4/0 600V USE	10	-
UG7-25	SINGLE PHASE PAD MOUNTED TRANSFORMER (LO	1	-
UM27-2	SACRIFICIAL ANODE-EQUIPMENT GROUND PROTE	1	-
UM3-14	SECTIONALIZING ENCLOSURE, SINGLE PHASE	1	1
UM6-1	LOADBREAK ELBOW (200A)	5	3
UM6-10-25	25KV INSULATED PROTECTIVE CAP (200A)	-	1
UM6-22-15	MODULE 15KV-04	1	-
UM6-22-25	MODULE 25KV-04	-	1
UM6-34	ELBOW ARRESTER	1	-
UM8-3-CWP	CWP URD METER PED	1	-

MAJOR MATERIAL ITEM SUMMARY

Description	MAT ITEM ID	INST QTY	Installed	Returned	RET QTY	Salvaged
ANODE, SACRIFICIAL 5#	11002	2			-	
ELBOW ARRESTER 15 KV	15204	1			-	
CLAMP, CONNECTOR	170002	9			3	
CLAMP, GROUND ROD	170004	1			-	
TERMINALS TRANS SEC	180202	3			-	
GROUND SLEEVE 10	222202	1			1	
MARKER, CABLE ROUTE	393002	2			1	
PEDS, 25KV SECT. 10PRI	444008	1			1	
ROD, GROUND	530008	1			-	
TUBING, GOPHER	530010	435			-	
HEAT SHRINK, SMALL	667704	5			3	
PROTECTIVE CAP 25KV	669004	-			1	
ELBOW, 25 CABLE 15 BUSHING	669308	5			3	
MODULE, 15KV-04	669412	1			-	
MODULE, 25KV-04	669420	-			1	
25 KVA URD TRANSFORMER	694025	1			-	
WIRE, 4 STRANDED BARE CU	720004	12			-	
WIRE, 4-6 GROUND	720006	24			6	
URD METER PED	740002	1			-	
CABLE, USE 600V 4/0	90004	15			-	
CABLE, 15KV 1/0 SOLID (JACKET)220 MIL	91006	425			-	

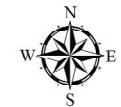

1400' TO #10302
MAP LOC. 88-000-02-00200
←

- | |
|-----------------------|
| 1 |
| Ext 1401 1/0 25KV JAC |
| New 1 UM3-14 |
| New 4 UM6-1 |
| New 1 UM6-22-15 |
| Ret 1 UM3-14 |
| Ret 3 UM6-1 |
| Ret 1 UM6-10-25 |
| Ret 1 UM6-22-25 |

REPLACE BOX OR BRING NEW DOOR
PENTA BOLT RUSTED AND BROKE OFF
(OLD STYLE METAL BASEMENT BOX)

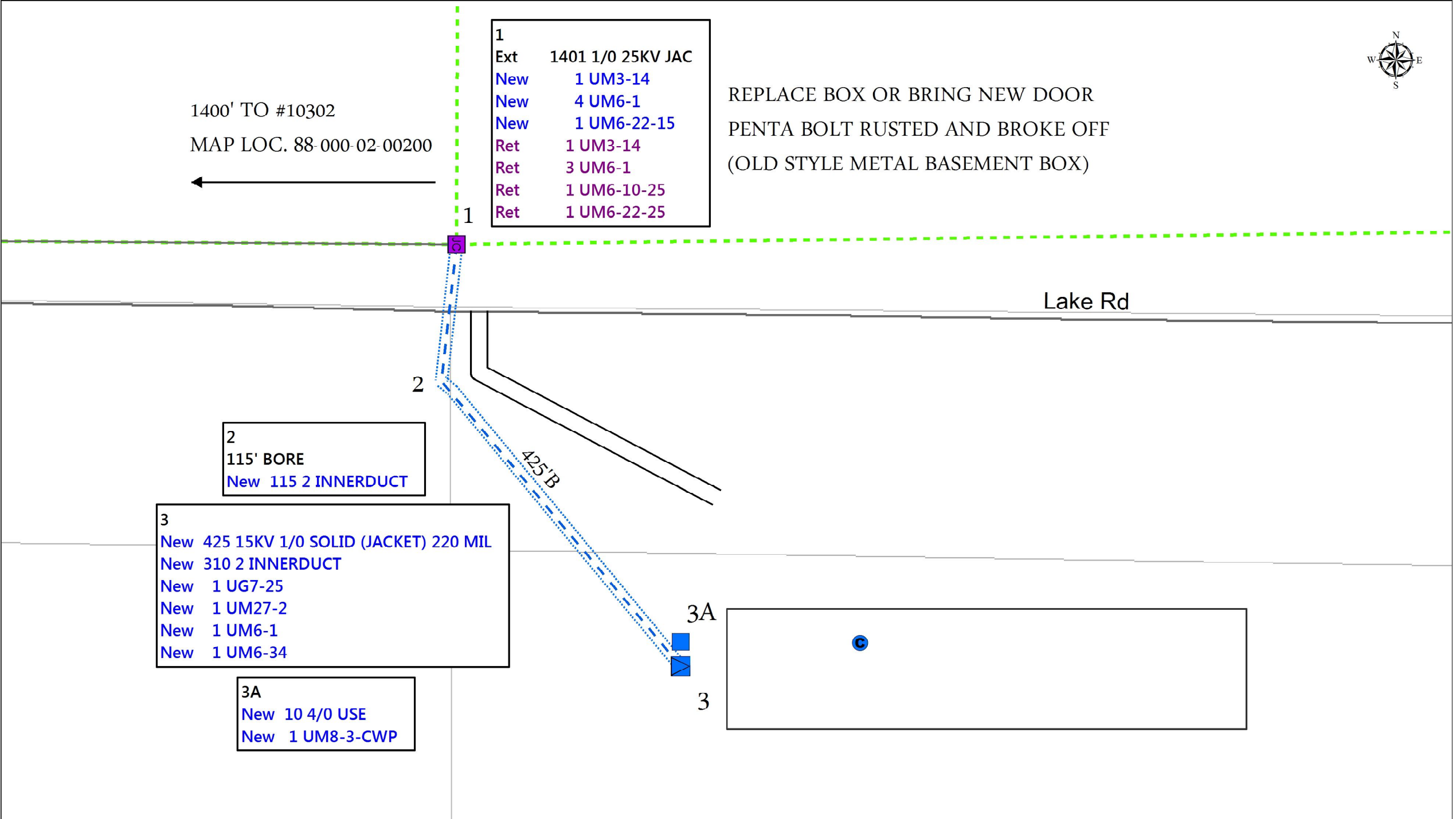

- | |
|---------------------|
| 2 |
| 115' BORE |
| New 115 2 INNERDUCT |

- | |
|---|
| 3 |
| New 425 15KV 1/0 SOLID (JACKET) 220 MIL |
| New 310 2 INNERDUCT |
| New 1 UG7-25 |
| New 1 UM27-2 |
| New 1 UM6-1 |
| New 1 UM6-34 |

- | |
|-----------------|
| 3A |
| New 10 4/0 USE |
| New 1 UM8-3-CWP |

LOCATIONS - GRID



Staked By: LUKE M KASELLA	RUS Code:
Date: 6/10/2016 12:00:00AM	EXT 740 C:
Signed By: RICK L PEDERSON	Loan Nbr: BA8
Date:	Loan Ywr: 2014
Comments 1:	

LOCATIONS - STATUS		PRIMARY CONSTRUCTION				EQUIPMENT / LIGHTS / MISCELLANEOUS			
LOCATION	STS	TOTAL	STRUCTURE	(# WIRES)-FT-SIZE	(QTY) - UNITS	TRANSFORMER-[KVA]	(QTY)-EQUIPMENT	(QTY)-MISC	(QTY)-MISC
1	EXS							(1.00)- UM27-2	
	EXS	1401		(1)-1401-1/0 25KV JAC					
	RET		UM3-14					(3.00)- UM6-1	
	RET							(1.00)- UM6-10-25	
	RET							(1.00)- UM6-22-25	
	NEW		UM3-14					(4.00)- UM6-1	
	NEW							(1.00)- UM6-22-15	
LAT: -94.167572		LONG: 45.911997							
2	NEW								
LAT: -94.167622		LONG: 45.911685		115' BORE					
3	NEW	425		(1)-425-1/0 15KV JAC 220		UG7-25- [15]		(1.00)- UM27-2	
	NEW							(1.00)- UM6-1	
	NEW							(1.00)- UM6-34	
LAT: -94.166840		LONG: 45.911032							
3A	NEW							(1.00)- UM8-3-CWP	
LAT: -94.166839		LONG: 45.911088							
3B	EXS								
	NEW								
LAT: -94.166250		LONG: 45.911085							