

**COVERSHEET**

	RUS Code:	W/O #:	414760
	EXT 740 C:	WP #:	
	Loan Nbr: BB8	LOC #:	71-000-06-02004
	Loan Ywr: 2017	Name:	WAKEFIELD PORK INC
	AFF #:	(H) Phone #:	6321023
17330 MN-371 Brainerd, MN 56401 (218) - 829 - 2827	Elec:	(W) Phone #:	
	RFCd:	(C) Phone #:	
	By:	Acct #:	

City:	Staked By: LUKE M KASELLA
Sec: 36	Date: 5/19/2017 12:00:00AM
Twp: 42	Signed By: JEFFREY L WOHLERT
Rg: 32	Date: 04/26/2017

Tailgate Session	
Job Steps:	Work Procedures:
PPE Needed:	Job Hazards:
Source Control Verified/Size:	Equipment Needed:
Personal Tools:	1-Shot/K-Fuse Size:
Crew:	Date:
Comments:	

Gopher State	
Locate #:	Date OK:

Comments 1:
Comments 2:
Comments 3:

Septic:	Row 1:	Rd Permit:	✓
Priv Elec:	Row 2:	Cty Permit:	
LP Line:	Line Ext \$ 42,801.00 Bore/Push \$ 0.00 Permit \$ 0.00 Ped/Loop \$ 0.00 Total \$ 42801.0	Fees:	✓
Sprinkler:	Backfill Comments:	TWP Permit:	
Final Grade:		State Permit:	
Brushing:		DNR Permit:	
Trees:		Joint Trench:	
Easements:		Notify TWP:	✓

Type of Device: Recloser	Size of Device: OCR-H-35A	Box/Switch #:
--------------------------	---------------------------	---------------

Reel ID:	Start Ftg:	End Ftg:
Reel ID:	Start Ftg:	End Ftg:
Reel ID:	Start Ftg:	End Ftg:

CONDUCTOR SUMMARY			
STATUS	CONDUCTOR	TYPE	QTY (FT)
	1/0 25KV JAC	PRIMARY	1355
	4 ACSR	PRIMARY	1376
INSTALL	1/0 15KV JAC 220 MIL	PRIMARY	2709
INSTALL	1/0 ACSR	PRIMARY	27030
	1/0 25KV JAC	PRIMARY	1367
	4 ACSR	PRIMARY	2508
RETIRE	4 ACSR	PRIMARY	13410
	500 MCM USE	SECONDARY	10
	UG-MODEL	SECONDARY	150
INSTALL	2 INNERDUCT	SECONDARY	780

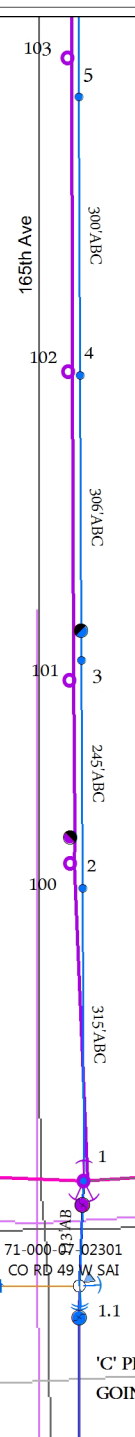

5  
 New 1200 1/0 ACSR  
 New 1 40-5  
 New 1 C1.11  
 New 1 H1.1

4  
 New 1224 1/0 ACSR  
 New 1 40-5 SET 8½' DEEP  
 New 1 C1.11  
 New 1 H1.1

3  
 New 980 1/0 ACSR  
 New 1 40-5 SET 7' DEEP  
 New 1 R3.2 35H OCRs

2  
 New 1260 1/0 ACSR  
 New 1 40-5  
 New 1 C1.11  
 New 1 H1.1

1  
 Ext 1260 1/0 ACSR  
 New 1 40-4  
 New 1 C2.24P  
 New 1 C6.52 10' ARMS  
 New 1 H1.1  
 Ret 1 40-5  
 Ret 1 A6.2  
 Ret 1 C2.24  
 Ret 3 E1.1  
 Ret 2 E1.5  
 Ret 3 E3-10  
 Ret 3 F2.8  
 Ret 1 H1.1  
 Ret 1 S1.01

CHARGE OUT 2 ADDITIONAL  
 10' CROSSARMS TO HANG OCRs

70-000-01-00306  
 IRRGTR SECT 1 NW CRNR

71-000-06-02002  
 NE CORN OF 263RD ST &

\*USE EXISTING SINGLE PHASE AND  
 ADD 2 NEW PHASES ACROSS ROAD  
 \*USE FIBERGLASS DEAD END ARM  
 WITH GUYS OFF BACK OF ARM  
 \*KEEP NEUTRAL THROUGH  
 TO THE SOUTH ON SPOOL

71-000-07-02301  
 CO RD 49 W SAI

'C' PHASE TAP  
 GOING SOUTH

1.1  
 Ext 226 1/0 ACSR  
 Ext 1 40-5  
 Ext 1 G9-3 6347  
 Ext 1 H1.1  
 Ext 1 OWNER LOOP  
 New 226 1/0 ACSR  
 New 1 C5.71L FIBERGLASS ARM  
 New 1 E1.1  
 New 3 E3-10  
 New 2 F2.10  
 New 1 F2.8  
 New 1 S1.01 15T FUSE  
 Ret 1 A2.1

263rd St