

0+31 &
 INP 18' X 28' CMC REMOVE
 F&I 24' X 42' SCP
 F&I 2 APRONS

5+00 FE. ENT. LT.
 NO CULV. INP.
 F&I 15' X 26' SCP
 F&I 2 APRONS

~~1+15 &
 INP 18' X 24' CMC REMOVE
 F&I 24' X 42' SCP
 F&I 2 APRONS~~

21+65 FE. ENT. LT.
 NO CULV. INP.
 F&I 15' X 26' SCP
 F&I 2 APRONS

24+55
 INP 30' X
 F&I 3
 F&I 2

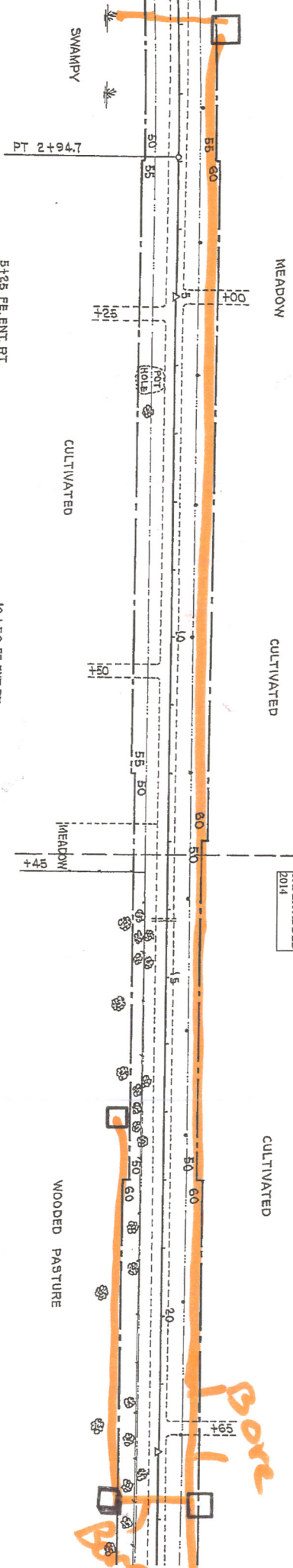

5+25 FE. ENT. RT.
 NO CULV. INP.
 NO CULV. REQ'D.

10+50 FE. ENT. RT.
 NO CULV. INP.
 F&I 15' X 26' SCP
 F&I 2 APRONS



LT
 RT. | CL & GR. LT. |

BM. EL. 1285.22
 SPIKE IN 18' ELM
 RT. 160' STA. 6+80

| CL & GR. ST. |

BM. EL. 1282.82
 SPIKE IN 24' ELM
 RT. 160' STA. 13+95

| CL & GR. ST. |

CL & GR. 2 T.

CL & GR. 0.1 ACRE

77.97
 80.30
 83.50
 86.30
 88.30
 89.50
 89.90
 89.90
 89.90
 89.90
 89.90
 89.90
 88.50
 87.99
 87.85
 88.11
 88.74
 89.42
 90.10
 90.78
 91.46
 92.13
 92.74

06692173
 00+51.12
 12

06692173
 00+50.11
 12

00+52.88
 00+52.88
 12

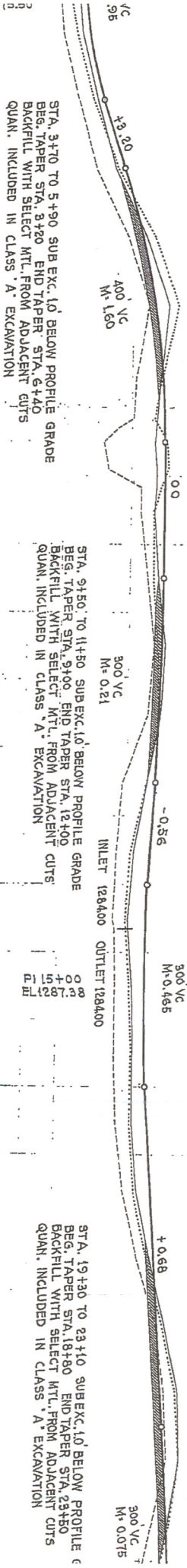

STA. 3+70 TO 5+90 SUB EXC. 1.0' BELOW PROFILE GRADE
 BEG. TAPER STA. 3+20 END TAPER STA. 5+40
 BACKFILL WITH SELECT MTL. FROM ADJACENT CUTS
 QUAN. INCLUDED IN CLASS 'A' EXCAVATION

STA. 9+50 TO 11+50 SUB EXC. 1.0' BELOW PROFILE GRADE
 BEG. TAPER STA. 9+00 END TAPER STA. 12+00
 BACKFILL WITH SELECT MTL. FROM ADJACENT CUTS
 QUAN. INCLUDED IN CLASS 'A' EXCAVATION

STA. 19+30 TO 23+10 SUB EXC. 1.0' BELOW PROFILE GRADE
 BEG. TAPER STA. 18+80 END TAPER STA. 23+50
 BACKFILL WITH SELECT MTL. FROM ADJACENT CUTS
 QUAN. INCLUDED IN CLASS 'A' EXCAVATION

40' DT. LT. & RT.

29+45 FE. ENT. LT.
NO CULV. INP.
NO CULV. REQ'D.

~~38+158 E
INP. 15' X 24' CMC REMOVE
F&I. 18' X 26' SCP
F&I. 2 APRONS~~

38+30 FE. ENT. LT.
NO CULV. INP.
F&I. 15' X 26' SCP
F&I. 2 APRONS

MEADOW

HAY FIELD

END SAP 49-630-01
STA. 40+87.9

34-58 CL
24' X 52' RCP
TAPER ADDED
2014

40-48 CL
24' X 48' RCP
TAPER ADDED
2014

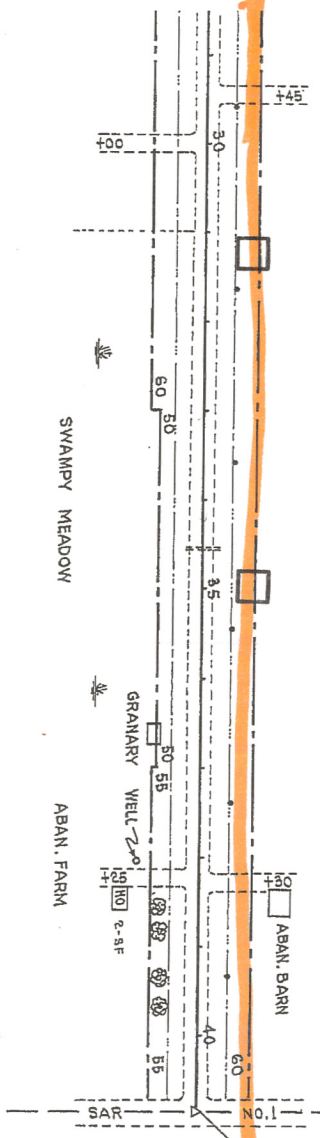

30+00 FE. ENT. LT.
NO CULV. INP.
NO CULV. REQ'D.



38+25 FE. ENT. RT.
NO CULV. INP.
F&I. 15' X 26' SCP
F&I. 2 APRONS

CL & GR. A.T.

BM. EL. 1294.27
SPIKE IN 10' PINE
RT. 80 STA. 39+11.5

BM. EL. 1295.71
SPIKE IN RP
RT. 45 STA. 181+00 SAR-1

95.40	
95.35	
95.06	
94.74	
94.42	
94.11	
93.90	
93.79	
93.78	
93.78	
93.78	
93.78	
93.78	

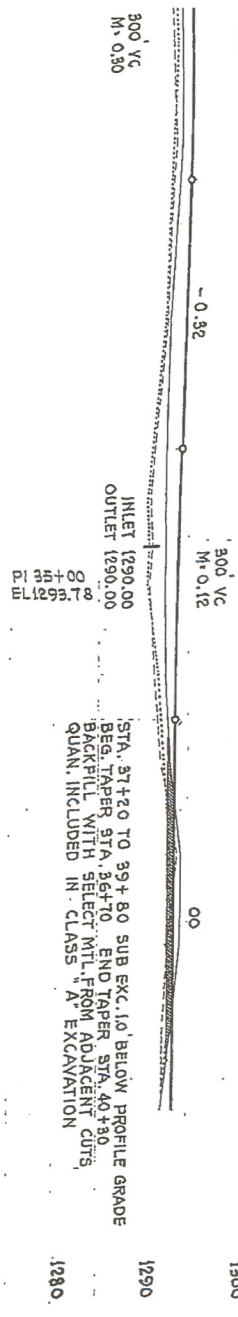

T. & RT.

4.0' DT. LT. & RT.

4